



Applies To: **1998-02 Accord V6** – ALL  
**1999-04 Odyssey** – ALL  
**2003-04 Pilot** – ALL  
**2005 Pilot** – From VIN 5FN9YF18..5B000001 thru 5FN9YF18..5B038135  
 – From VIN 2HKYF18..5H500001 thru 2HKYF18..5H554958

**June 7, 2006**

## Idle Vibration or Harsh Shifting

### SYMPTOM

There is a vibration at idle or harsh engagement when shifting the transmission between between Park, Drive, and Reverse.

### PROBABLE CAUSE

The front hydraulic engine mount may have deteriorated and torn.

### PARTS INFORMATION

Front Engine Mount Assembly:

*1998-02 Accord V6* –

P/N 50810-S87-A82, H/C 7981657

*1999-04 Odyssey* –

P/N 50800-S0X-A04, H/C 7978927

*2003-05 Pilot* –

P/N 50800-S3V-A82, H/C 7984560

### WARRANTY CLAIM INFORMATION

**In warranty:** The normal warranty applies.

OP#	Description	FRT
112102	<i>Accord</i> – Replace engine mount.	0.5
A	Add for V6	0.6
112102	<i>Odyssey</i> – Replace engine mount.	1.7
112102	<i>Pilot</i> – Replace engine mount.	1.5

Failed Part: P/N 50810-S87-A81  
 H/C 5438593

Defect Code: 01102

Symptom Code: 04501

Skill Level: Repair Technician

**Out of warranty:** Any repair performed after warranty expiration may be eligible for goodwill consideration by the District Parts and Service Manager or your Zone Office. You must request consideration, and get a decision, before starting work.

### DIAGNOSIS

1. Bring the engine up to operating temperature, and fully apply the parking brake.
2. Have an assistant view the top of the front engine mount while standing to the side of the vehicle. Shift the transmission to Drive. With your foot firmly on the brake pedal, quickly depress the accelerator pedal and release it. Your assistant should look for contact between the top of the engine mount and the bottom of the front engine mount bracket, and listen for noise from that area.

### REPAIR PROCEDURE

1. Drive the vehicle onto a lift, but do not raise it.
2. *Odyssey* – Remove the intake manifold cover and the front ignition coil cover:
  - See page 9-4 of the *1999-04 Odyssey Service Manual*.
  - Online, enter keyword **INTAKE**, and select **Intake Manifold Removal and Installation** from the list.
3. *Odyssey* – Remove the radiator cover:
  - See page 10-16 of the *1999-04 Odyssey Service Manual*.
  - Online, enter keyword **RADIATOR**, and select **Radiator and Fan Replacement** from the list.

4. Remove the top nut from the front hydraulic engine mount.

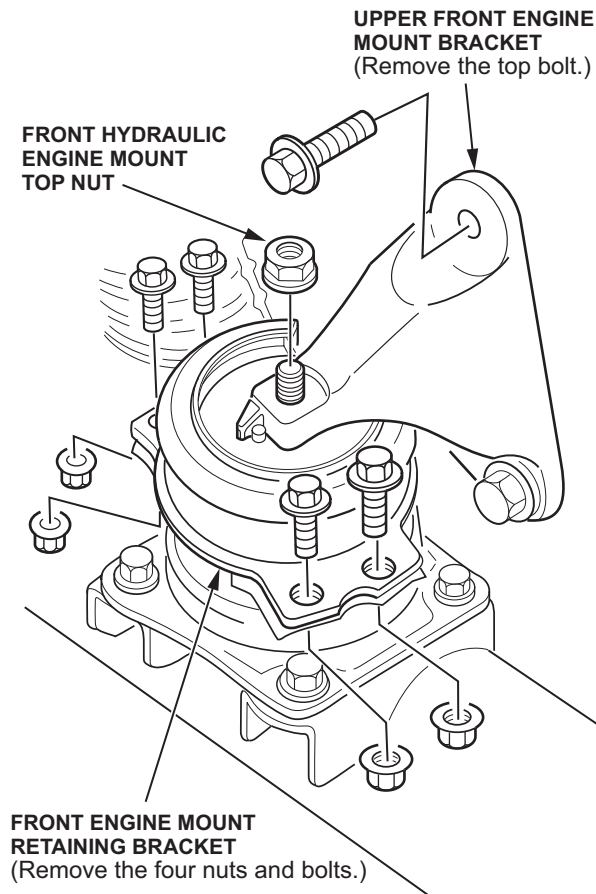

5. Remove the top bolt from the upper front engine mount bracket.
6. Remove the four nuts and bolts that secure the front engine mount retaining bracket.

7. *Accord & Pilot* – Remove all four bolts holding the engine mount to the subframe.

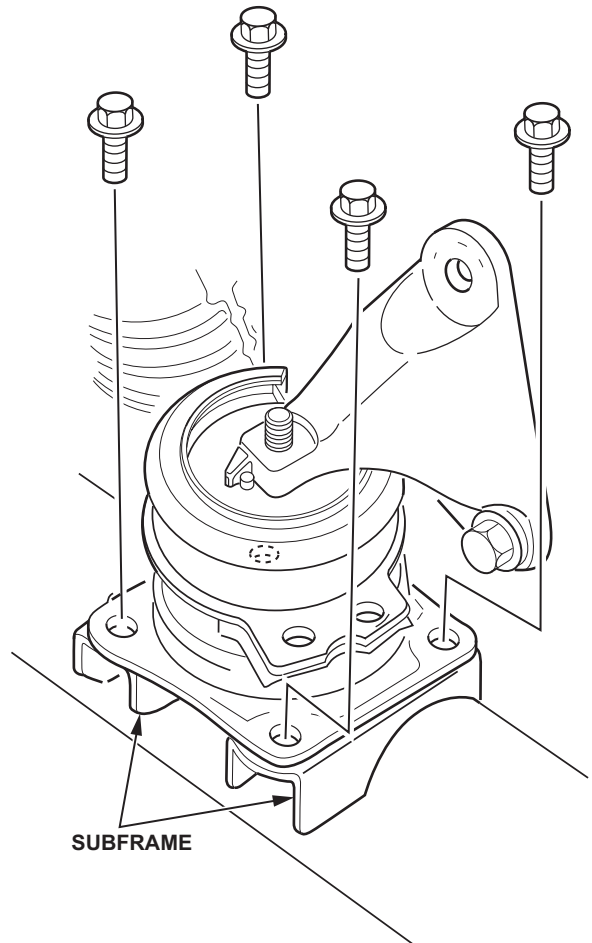

8. *Odyssey* – Remove the three accessible bolts holding the engine mount to the subframe

Remove the three front engine mount bolts that are accessible.

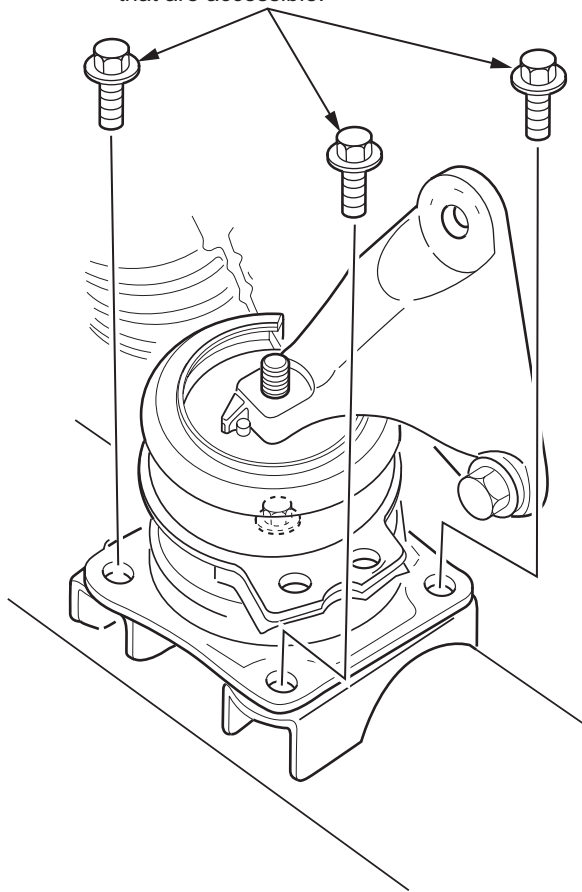

9. Raise the vehicle, and place a screw jack under the transmission next to the engine. Raise the transmission slightly.

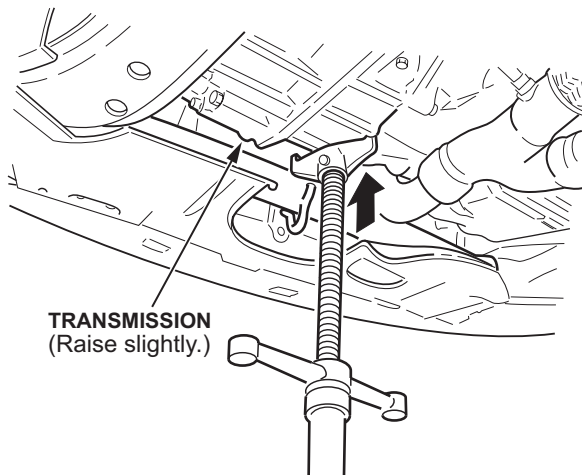

**TRANSMISSION**  
(Raise slightly.)

10. Remove the two remaining front bracket bolts.

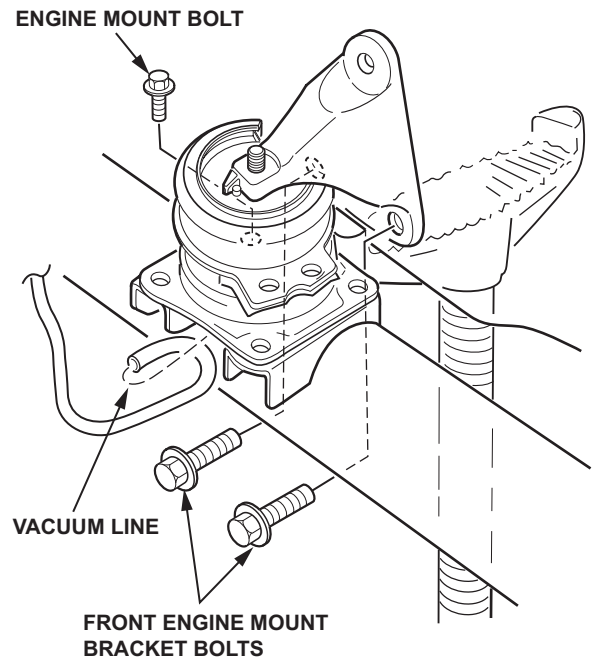

11. Disconnect the engine mount vacuum line.  
12. *Odyssey* – Remove the last engine mount bolt.  
13. Lower and remove the screw jack, then lower the vehicle.

14. Place a floor jack under the transmission next to the engine, and raise the transmission until the bracket clears the engine mount stud.

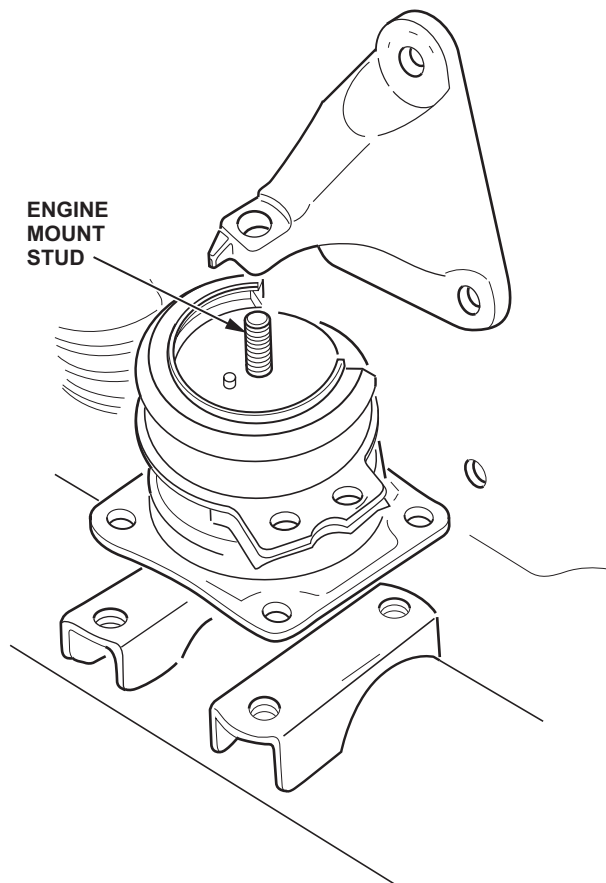

15. Remove the bracket and the front engine mount.

16. Remove the four nuts and bolts holding the retaining bracket to the new engine mount, and remove the retaining bracket.
17. Install the engine mount to the subframe, and thread in the four bolts halfway.

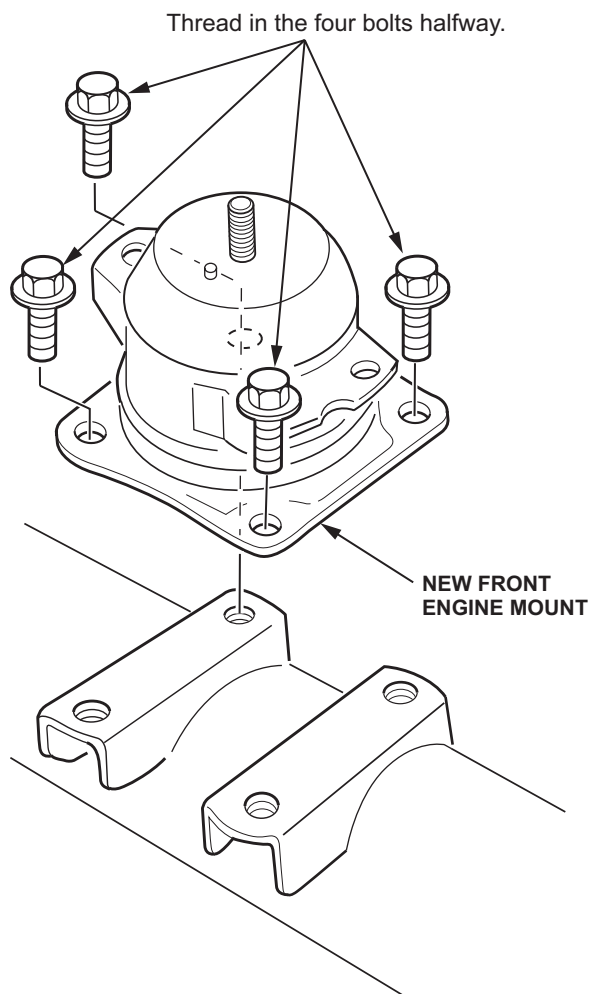

18. Install the retaining bracket on the engine mount, and torque all four nuts and bolts to **22 N·m (16 lb-ft)**.

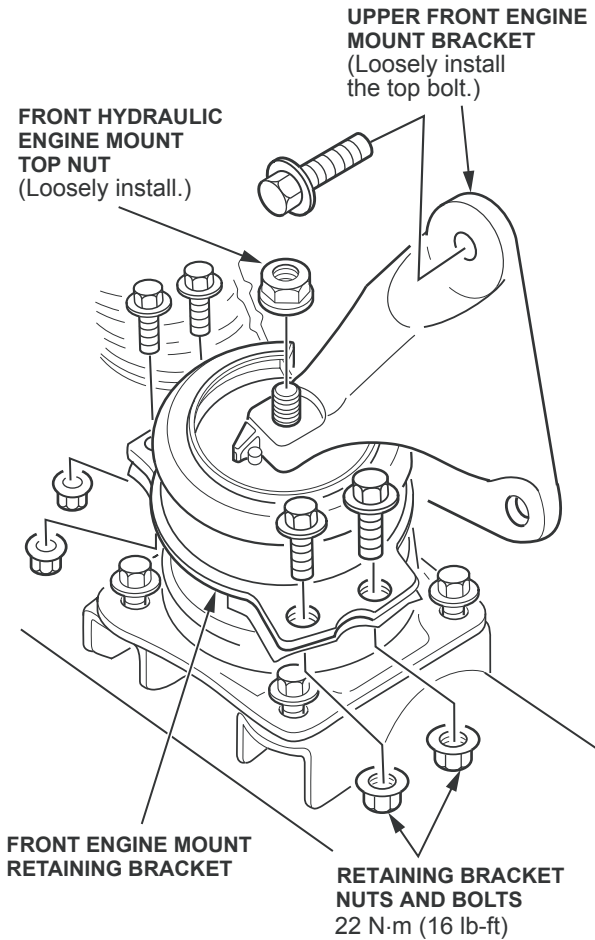

19. Place the front bracket on the center stud of the engine mount, and thread the nut halfway down. Thread the top bolt of the front bracket in halfway.
20. Raise the vehicle. Use the screw jack to raise the transmission slightly.

21. Loosely install the two bottom mounting bolts thru the front bracket. Starting on the passenger's side, torque the two bottom mounting bolts to **38 N·m (28 lb-ft)**.

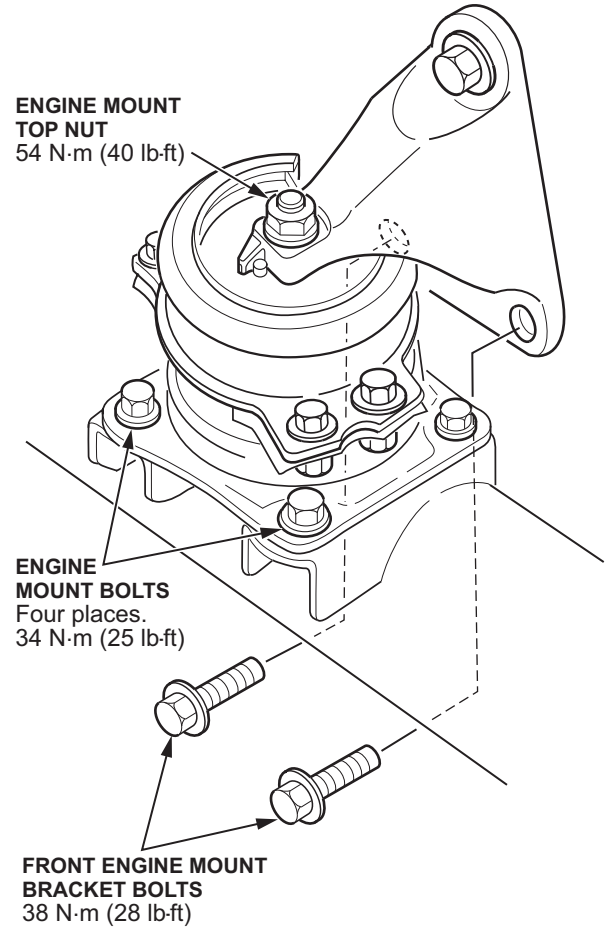

22. Lower the vehicle. Torque the engine mount top nut to **54 N·m (40 lb-ft)**.
23. Torque all four engine mount bolts to **34 N·m (25 lb-ft)**.

24. Reconnect the vacuum line.

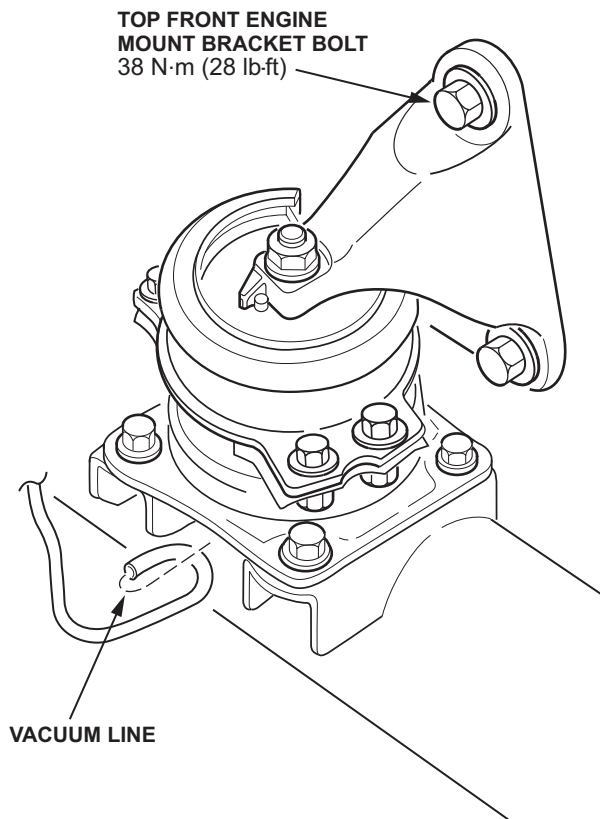

25. Torque the top bolt of the front bracket to **38 N·m (28 lb-ft)**.

26. *Odyssey* – Reinstall the intake manifold cover and the ignition coil cover. Reinstall the radiator cover.