

### Clutch Hydraulic Line

**SPECIAL SERVICE TOOL(S)  
REQUIRED**

Description	Tool Number
Clutch Coupling Tool	T88T-70522-A

**Removal**

1. Note the routing of the clutch slave cylinder to clutch master cylinder tube (7A512) line from clutch master cylinder (7A543) to the clutch slave cylinder.
2. Remove retainer pin from clutch master cylinder holding clutch slave cylinder to clutch master cylinder tube in place.
3. Raise the vehicle and install suitable safety stands.
4. Disconnect clutch slave cylinder to clutch master cylinder tube from external clutch slave cylinder. On vehicles equipped with concentric clutch slave cylinders, remove tube using Clutch Coupling Tool T88T-70522-A.

**Installation**

1. Follow the removal procedures in reverse order.
2. Bleed system. Refer to appropriate clutch hydraulic system bleeding procedure in the [Adjustments](#) portion of this section.

**Hydraulic Clutch Control System, 4.9L, 5.0L and 5.8L Gasoline Engines with Mazda R2 and S5-47 ZF Light-Duty and 7.3L and 7.5L S5-47 ZF Heavy-Duty Transmissions**

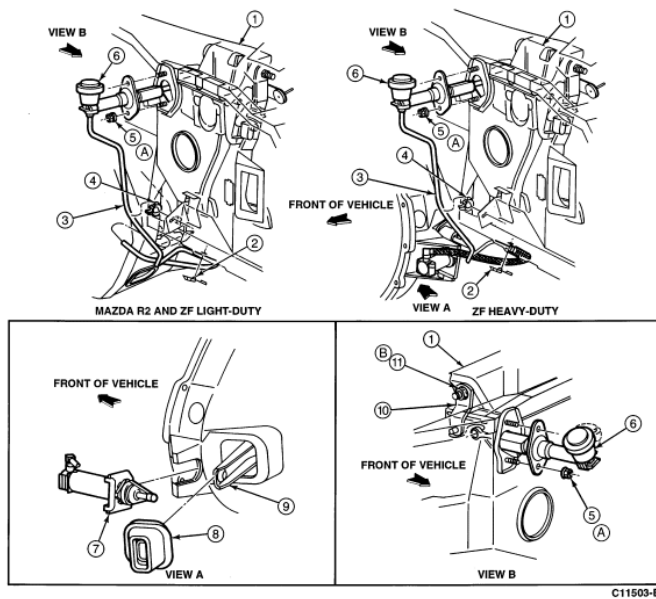

Item	Part Number	Description
1	2450	Brake Pedal and Bracket Assembly
2	N804443-S100	Clip
3	7A512	Clutch Slave Cylinder to Clutch Master Cylinder Tube
4	N806880-S100	Clip, Double
5	N620481-S2	Nut, M8-1.25
6	7A543	Clutch Master Cylinder
7	7A564	Clutch Slave Cylinder
8	7513	Clutch Release Lever Dust Shield
9	7515	Clutch Release Lever
10	7A554	Clutch and Brake Pedal Pivot Shaft Lever
11	620483-S2	Nut
A	—	Tighten to 10-14 Nm

		(89-124 Lb-In)
B	—	Tighten to 68-92 Nm (50-68 Lb-Ft)

---