

Liftgate Latch Remote Control**Removal and Installation**

1. Remove the liftgate trim panel.
2. Disconnect the liftgate lock cylinder actuating rod.
 1. Release the clip.
 2. Disconnect the actuating rod.

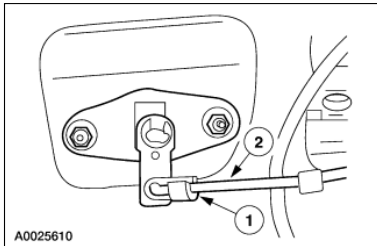

3. Disconnect the liftgate latch remote control actuating rods.
 1. Open the clip and disconnect the liftgate window latch actuating rod.
 2. Open the clip and disconnect the liftgate latch actuating rod.

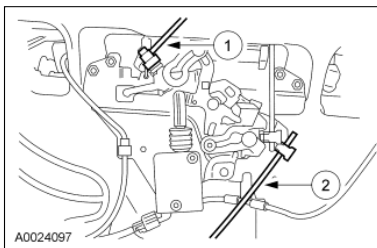

4. Disconnect the electrical connectors.
 1. If equipped, disconnect the liftgate latch actuator electrical connector.
 2. Release the liftgate window latch ajar switch wiring harness locator.

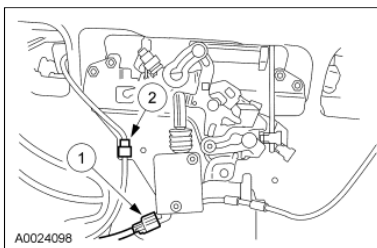

5. Remove the liftgate latch remote control assembly.
 1. Remove the screw.
 2. Remove the nuts.

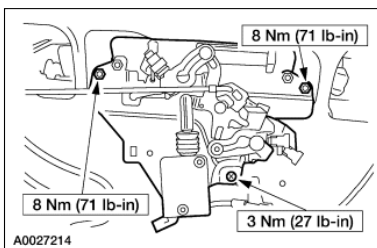

6. To install, reverse the removal procedure.
 - Transfer all necessary components.

