



Evaporative Emission Canister and Purge Valve — 5.4L  [Printable View \(487 KB\)](#)

Material

Item	Specification
SAE 5W-20 Super Premium Synthetic Blend Motor Oil XO-5W20-QSP	WSS-M2C153-H

 **WARNING:** The evaporative emissions system contains fuel vapor and condensed fuel vapor. Although not present in large quantities, it still presents the danger of explosion or fire. Disconnect the battery ground cable from the battery to minimize the possibility of an electrical spark occurring, possibly causing a fire or explosion if fuel vapor or liquid fuel are present in the area. Failure to follow these instructions can result in personal injury.

 **WARNING:** Do not smoke or carry lighted tobacco or open flame of any type when working on or near any fuel related component. Highly flammable mixtures are always present and may be ignited. Failure to follow these instructions may result in personal injury.

1. With the vehicle in NEUTRAL, position it on a hoist. For additional information, refer to [Section 100-00](#).
2. Disconnect the battery ground cable. For additional information, refer to [Section 414-00](#).
3. Remove the parts in the order indicated in the following illustrations and tables.

To remove individual parts, only carry out the listed steps:

Part	Steps
Evaporative emission canister purge valve	1-4
Evaporative emission canisters	5-14

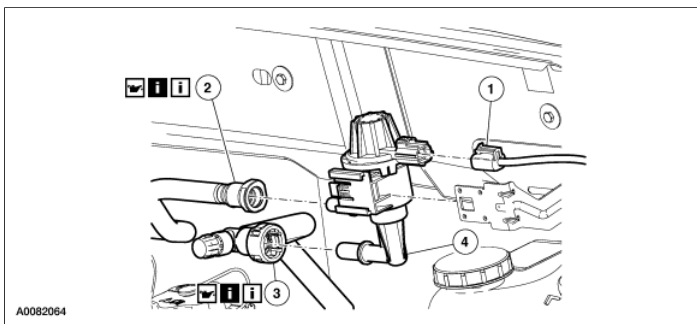

Item	Part Number	Description
1	—	Evaporative emission (EVAP) canister purge valve electrical connector (part of 12B637)
2	—	Fuel vapor quick connect fitting Removal Note Installation Note
3	—	Fuel vapor quick connect fitting Removal Note Installation Note
4	9C915	EVAP canister purge valve

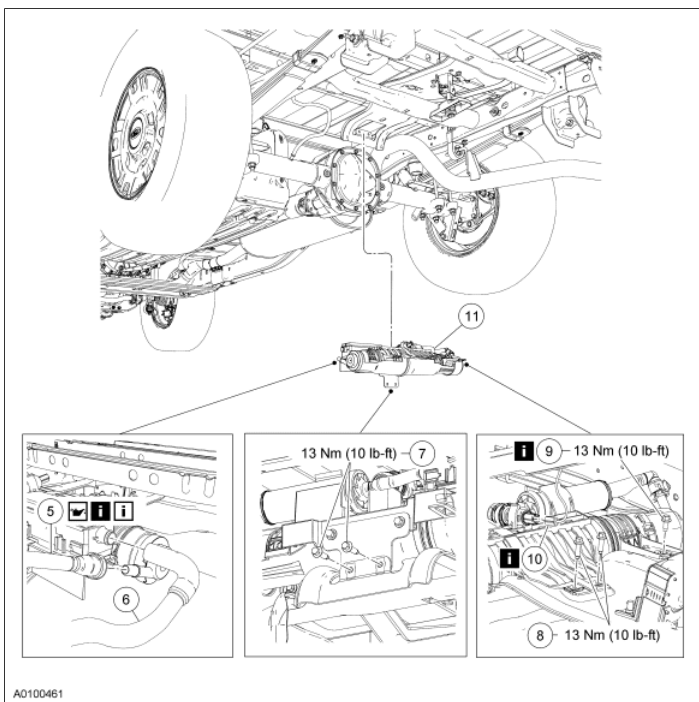

A0100461

Item	Part Number	Description
5	9C047	Fuel vapor tube quick connect fitting Removal Note Installation Note
6	9E857	Fuel vapor hose
7	W505224	EVAP canister assembly bracket bolts (2 req'd)
8	W505224	EVAP canister assembly bracket bolts (2 req'd)
9	W500224	EVAP canister assembly bracket bolts (2 req'd) Removal Note
10	—	EVAP canister vent solenoid electrical connector (part of 14405) Removal Note
11	9D6537	EVAP canister assembly

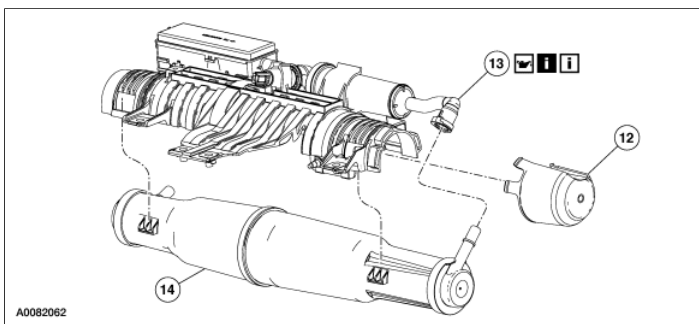

A0082062

Item	Part Number	Description
12	9D694	Canister heat shield
13	9G723	EVAP filter assembly tube Removal Note Installation Note
14	9D653	EVAP canister

4. To install, reverse the removal procedure.

**Items 2, 5 and 13: Quick Connect Fitting Removal Note**

- CAUTION:** Fuel injection equipment is manufactured to very precise tolerances and fine clearances. It is therefore essential that absolute cleanliness is observed when working with these components. Always install blanking plugs to any open orifices or tubes.

**CAUTION:** When reusing liquid or vapor tube connectors, make sure to use compressed air to remove any foreign material from the connector retaining clip area before separating from the tube.

Disconnect the quick release fitting.

- Push the connector toward the tube to release pressure.
- Press the quick release fitting button and pull the fuel tube to disconnect.

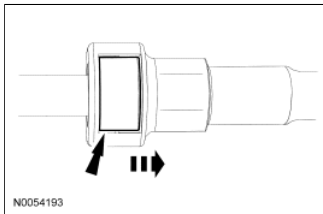

### Item 3: Vapor Tube Quick Connect Fitting Removal Note

1. **CAUTION:** When reusing liquid or vapor tube connectors, make sure to use compressed air to remove any foreign material from the connector retaining clip area before separating from the tube.

Disconnect the quick connect fitting.

- Push the fitting toward the tube to release pressure.
- Push the release tab clockwise.
- Disconnect the quick connect fitting.

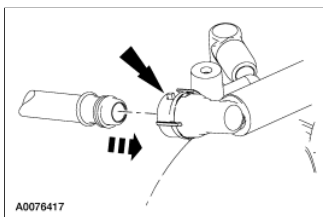

### Item 9: Evaporative Emissions Canister Assembly Bracket Bolt Removal Note

1. Remove the bolts.

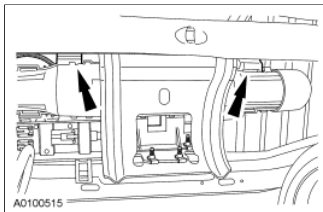

### Item 10: Evaporative Emissions Canister Vent Solenoid Electrical Connector Removal Note

1. Remove the solenoid electrical connector wiring harness push pin retainer.

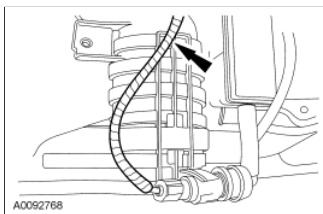

### Items 13, 5 and 2: Quick Connect Fitting Installation Note

1. **CAUTION:** Fuel injection equipment is manufactured to very precise tolerances and fine clearances. It is therefore essential that absolute cleanliness is observed when working with these components. Always install blanking plugs to any open orifices or tubes.

**CAUTION:** Make sure the quick release fitting clicks into place when installing the tube. To make sure that the quick release fitting is fully seated, pull on the tube.

**NOTE:** Apply clean engine oil to the end of the tube before connecting the fitting.

Connect the quick release fitting.

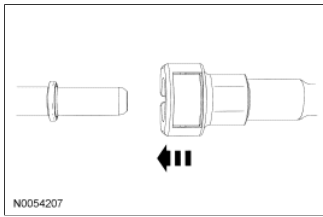
**Item 3: Vapor Tube Quick Connect Fitting Installation Note**

1.  **CAUTION:** Make sure the quick connect fitting clicks into place when installing the tube. To make sure that the quick connect fitting is fully seated, pull on the tube.

**NOTE:** Apply clean engine oil to the end of the tube before connecting the fitting.

Connect the quick connect fitting.

