

Locking Hubs, Automatic

Automatic Locking Hub, F-150 and Bronco

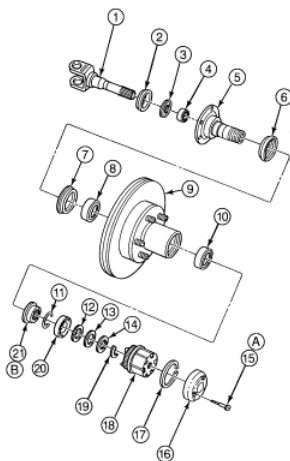

E9804-B

Item	Part Number	Description
1	3A329	Halfshaft
2	3C132	Rolling Diaphragm Seal (RDS), Axle
3	3299	Integral Spacer Needle Bearing Seal
4	3123	Bearing, Caged Needle
5	3105	Front Wheel Spindle
6	3254	Spindle Rolling Diaphragm Seal
7	1190	Wheel Hub Grease Seal
8	4221	Inner Wheel Bearing (with Bearing Cup — 4222)
9	1102	Front Disc Brake Hub and Rotor
10	4221	Outer Wheel Bearing (with Bearing Cup — 4222)
11	3B549	Wheel Retainer Key
12	—	Steel Thrust Washer (Part of 3B458)
13	—	Plastic Thrust Washer (Part of 3B458)
14	—	Splined Thrust Washer (Part of 3B458)
15	1K104	Capscrew
16	1K104	Cap
17	—	Lock Ring (Part of 1K106)
18	1K105	Hub Body
19	3B457	C-Ring
20	—	Cam Assembly (Part of 1K105)
21	—	Wheel Retainer (Nut) (Part of 1K105)
A	—	Tighten to 4-6 Nm (35-53 Lb-In)
B	—	While Rotating Front Disc Brake Hub and Rotor, Tighten to 68 Nm (50 Lb-Ft) to Seat Wheel Bearings. Back Nut Off 90 Degrees (1/4 Turn). Tighten to 1.8 Nm (16 Lb-In)

Automatic Locking Hub, F-250, F-350

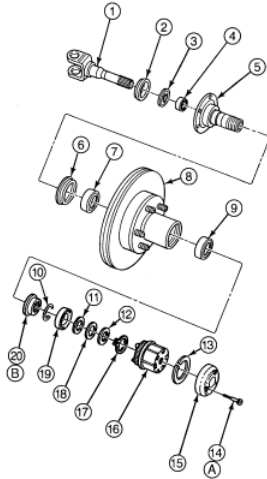

E9805-A

Item	Part Number	Description
1	3A329	Halfshaft
2	3C132	Rolling Diaphragm Seal (RDS), Axle
3	3299	Integral Spacer Needle Bearing Seal
4	3123	Bearing, Caged Needle
5	3105	Front Wheel Spindle
6	1190	Wheel Hub Grease Seal
7	4221	Inner Wheel Bearing (with Bearing Cup — 4222)
8	1102	Front Disc Brake Hub and Rotor
9	4221	Outer Wheel Bearing (Bearing Cup — 4222)
10	3B549	Wheel Retainer Key
11	—	Steel Thrust Washer (Part of 3B458)
12	—	Splined Thrust Washer (Part of 3B458)
13	—	Lock Ring (Part of 1K106)
14	1K104	Capscrew
15	1K104	Cap
16	1K105	Hub Body
17	3B457	Snap Ring
18	—	Plastic Thrust Washer (Part of 3B458)
19	—	Cam Assembly (Part of 1K105)
20	—	Wheel Retainer (Nut) (Part of 1K105)
A	—	Tighten to 4-6 Nm (35-53 Lb-In)
B	—	While Rotating Front Disc Brake Hub and Rotor, Tighten to 68 Nm (50 Lb-Ft) to Seat Wheel Bearings. Back Nut Off 90 Degrees (1/4 Turn). Tighten to 1.8 Nm (16 Lb-In)

Removal

⚠ CAUTION: Do not drop hub components during removal and installation.

1. Separate cap from body assembly by removing the three capscrews, using Torx® bit TX25 or equivalent, from the cap.
2. Remove cap.
3. Remove the lock ring seated in the groove of the front disc brake hub and rotor (1102).
4. Remove the body assembly from the front disc brake hub and rotor.

Automatic Locking Hub, Disassembled View, Typical

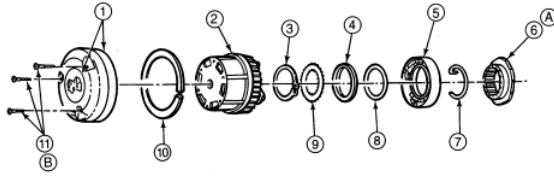

E9806-A

Item	Part Number	Description
1	1K104	Cap
2	1K105	Hub Body
3	3B457	Snap Ring
4	—	Plastic Thrust Washer (Part of 3B458)
5	—	Cam Assembly (Part of 1K105)
6	—	Wheel Retainer (Nut) (Part of 1K105)
7	3B549	Wheel Retainer Key
8	—	Steel Thrust Washer (Part of 3B458)
9	—	Splined Thrust Washer (Part of 3B458)
10	—	Lock Ring (Part of 1K106)
11	1K104	Capscrews (3)
A	—	While Rotating Front Disc Brake Hub and Rotor, Tighten Wheel Retainer (Nut) to 68 Nm (50 Lb-Ft) to Seat Wheel Bearings. Back Nut Off 90 Degrees (1/4 Turn). Tighten to 1.8 Nm (16 Lb-In).
B	—	Tighten to 4-6 Nm (35-53 Lb-In)

- Remove C-washer or snap ring from stub shaft groove.
- Remove spacers (three thrust washers) from shaft.
- Remove cam assembly. Pull to remove.
- If front disc brake hub and rotor and front wheel spindle (3105) are to be removed, refer to [Wheel Grease Seal and Bearing, Front Replacement and Repacking](#) in the Disassembly and Assembly portion of this section.

Installation

- Align the fixed cam retaining key on the cam assembly (garter spring inboard) with the keyway on the spindle. Firmly press the cam assembly on the wheel retainer nut.

- CAUTION: Improper sequence of three-piece thrust washers will result in excessive wear of assembly.**

Install three-piece thrust washer set (first metal, second plastic, third splined) and retainer lock ring on C-clip. It may be necessary to push the axle outboard from backside of knuckle. Be sure retaining ring is seated in groove properly.

- CAUTION: Rotate moving cam stop (use any one of three) to the one o'clock position in relationship to the fixed cam retaining key.**

CAUTION: Do not force body assembly into front disc brake hub on rotor if body assembly will not fit. Recheck alignment of all components.

NOTE: The hubs should not be packed with grease. Too much grease will damage the hubs and prevent proper operation.

Install body assembly into vehicle front disc brake hub and rotor by lining up the three legs outside the hublock body with the three pockets in the cam assembly.

- Make sure body assembly is in far enough to see groove in rotor tube. Install large lock ring into groove of hub. Be sure lock ring is correctly seated.
- Install cap to body assembly. Install three capscrews and tighten to 4-6 Nm (35-53 lb-in).

