

2002 Lexus IS 300 L6-3.0L (2JZ-GE)

Vehicle Level → Brakes and Traction Control → Disc Brake System → Service and Repair → Rear ←

Rear

[Notes](#)

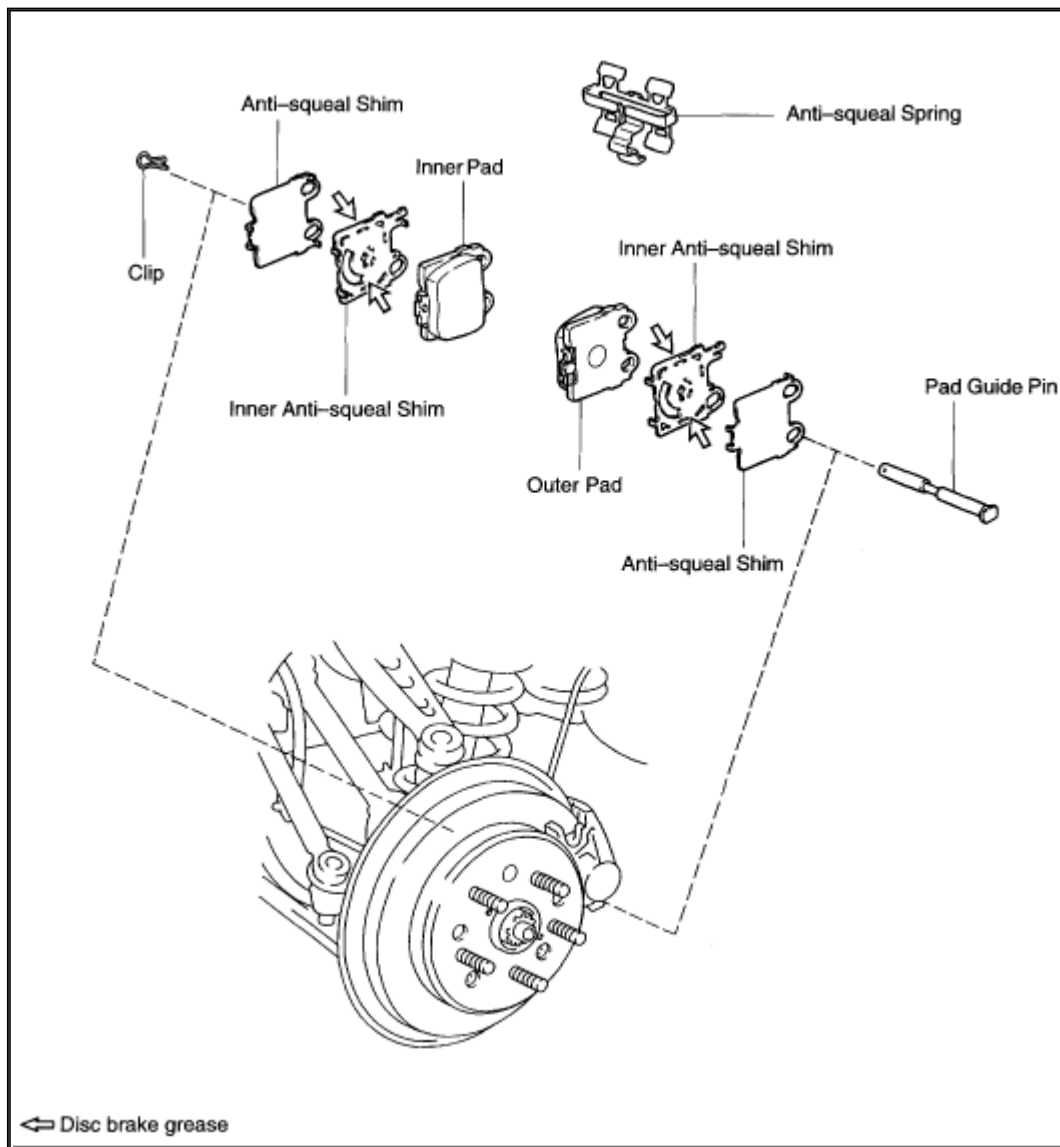

Zoom

Sized for Print

**REPLACEMENT**

1. REMOVE REAR WHEEL

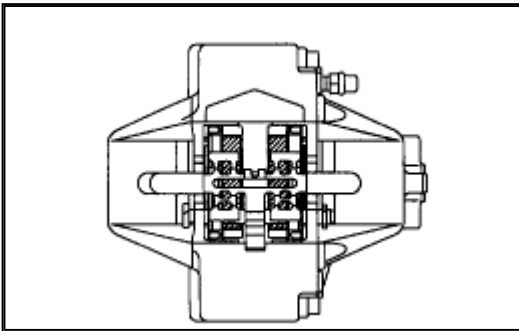

Zoom

Sized for Print

2. INSPECT PAD LINING THICKNESS Check the pad thickness through the caliper inspection hole and replace pads if the thickness is not within the specification. Minimum thickness: **1.0 mm (0.039 inch)**

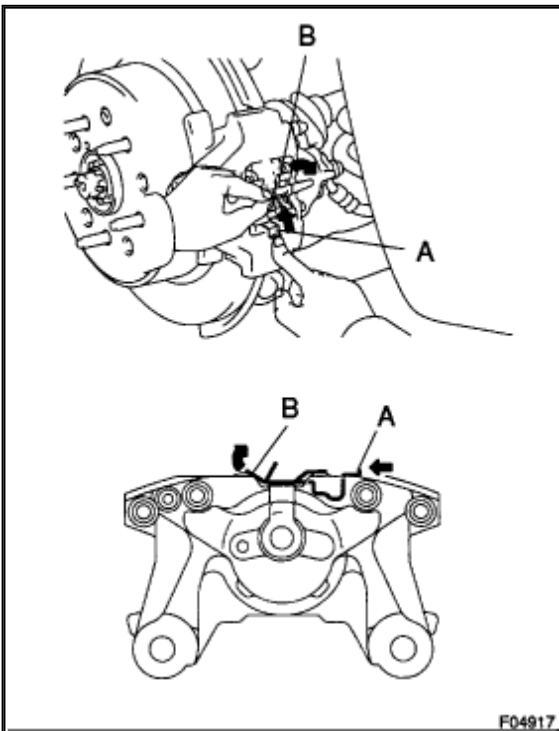

Zoom

Sized for Print

3. REMOVE ANTI-SQUEAL SPRING AND PAD GUIDE PIN

- a. Raise the "B" portion with hand, push up the "A" portion and unlatch the anti-squeal spring from [brake caliper](#).
- b. Remove the anti-squeal spring. **NOTICE:**
  - Do not deform the clip and anti-squeal spring.
  - The clip and anti-squeal spring can be used again provided that they have sufficient rebound, no-deformation, cracks or wear, and have had

all rust, dirt and foreign particles cleaned off.

- c. Remove the clip and pad guide pin.

#### 4. REMOVE PADS AND ANTI-SQUEAL SHIMS

- a. Remove the 2 pads.
- b. Remove the 4 anti-squeal shims from each pad.

#### 5. CHECK DISC THICKNESS AND RUNOUT

6. INSTALL NEW PADS **NOTICE:** When replacing worn pads, the anti-squeal shims must be replaced together with the pads.

- a. Apply disc brake grease to both sides of inner anti-squeal shims.

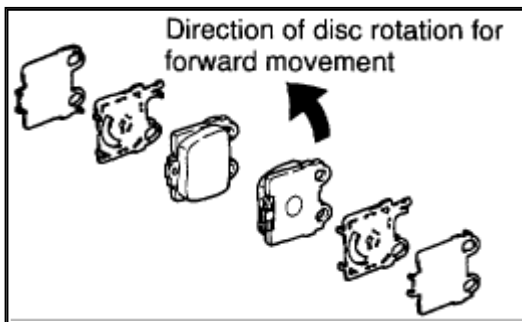

Zoom

Sized for Print

- b. Install the 2 anti-squeal shims on each pad. **HINT:** Make sure the arrows on the inner anti-squeal shims facing to the direction of disc rotation as shown in the illustration.
- c. Draw out a small amount of [brake fluid](#) from the reservoir.

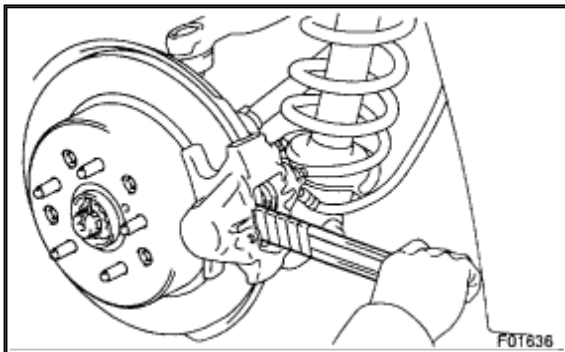

Zoom

Sized for Print

- d. Press in the pistons with a monkey wrench handle or equivalent. **HINT:**
  - Tape the monkey wrench handle before use.

- If the piston is difficult to push in, loosen the bleeder plug and push in the piston while letting some [brake fluid](#) escape.

e. Install the 2 pads.

## 7. INSTALL PAD GUIDE PIN AND ANTI-SQUEAL SPRING

- Install the pad guide pin and clip.
- Install the anti-squeal spring.

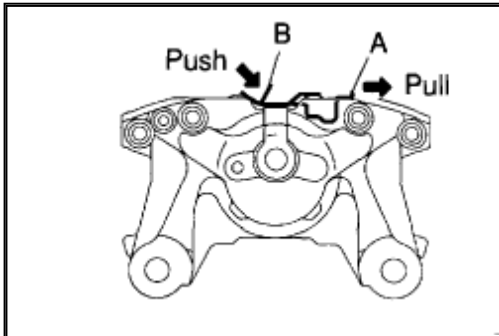

Zoom

Sized for Print

- Push in the "B" portion with hand, pull the "A" portion and latch the anti-squeal spring to [brake caliper](#).

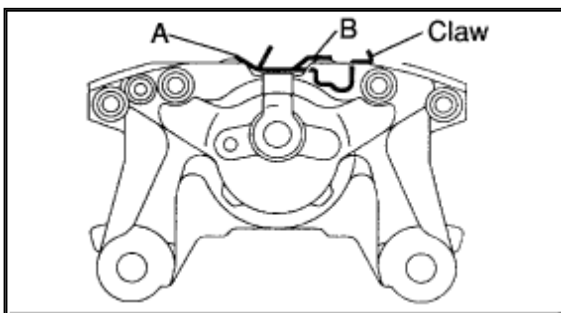

Zoom

Sized for Print

### HINT:

- Ensure that the claw of the anti-squeal spring is raised up on the caliper securely.
- Ensure that there is no gap between the pad guide pin and anti-squeal spring.
- Ensure that "A" and "B" portions of anti-squeal spring are attached to the pad.

- INSTALL REAR WHEEL Torque: **103 Nm (1,050 kgf-cm, 76 ft. lbs.)**
- DEPRESS BRAKE PEDAL SEVERAL TIMES

10. CHECK THAT FLUID LEVEL IS AT MAX LINE

© 2010 ALLDATA LLC. All rights reserved.  
[Terms of Use](#)