

[Select Vehicle](#) | [New TSBs](#) | [Technician's Reference](#) Component Search:

OK

 Conversion Calculator**2002 Dodge Truck RAM 1500 Truck 2WD V6-3.7L VIN K**[Vehicle Level](#) → [Steering and Suspension](#) → [Steering](#) → [Steering Column](#) → [Service and Repair](#) → [Steering Column](#) ←

Steering Column

[Notes](#)

REMOVAL

WARNING: BEFORE SERVICING THE STEERING COLUMN THE AIRBAG SYSTEM MUST BE DISARMED. REFER TO RESTRAINT SYSTEMS FOR SERVICE PROCEDURES. FAILURE TO DO SO MAY RESULT IN ACCIDENTAL DEPLOYMENT OF THE AIRBAG AND POSSIBLE PERSONAL INJURY.

CAUTION: All fasteners must be torqued to specification to ensure proper operation of the steering column.

1. Position the front [wheels](#) straight ahead.
2. Disconnect the negative (ground) cable from the battery.
3. Remove the two switches from the [steering wheel](#).
4. Remove the airbag.
5. Remove the [steering wheel](#) with special tool CJ98-1 or an appropriate steering wheel puller. **CAUTION:** Ensure the puller bolts are fully engaged into the [steering wheel](#) and not into the clockspring, before attempting to remove the wheel. Failure to do so may damage the steering wheel/clockspring.
6. Remove the steering column opening cover.
7. Remove the tilt lever.



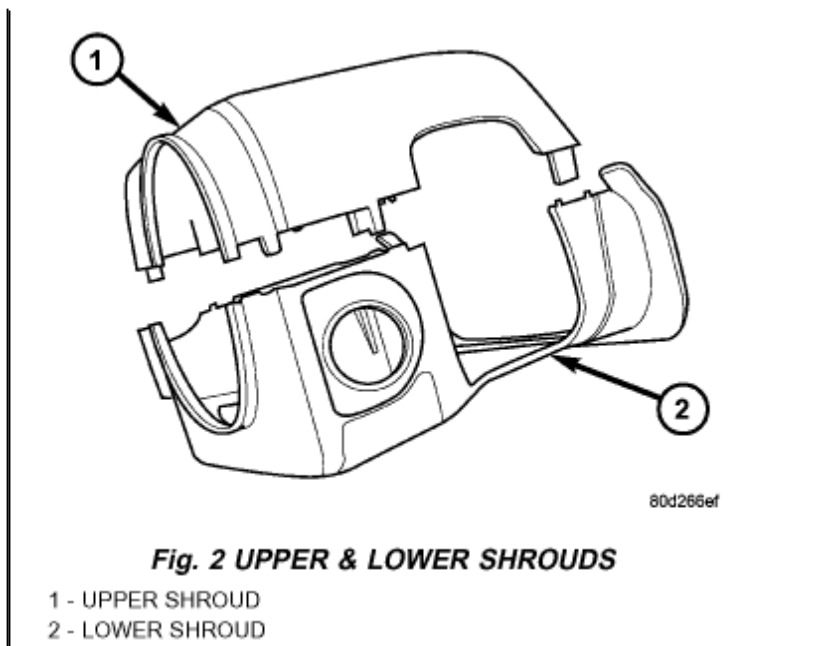

Zoom

Sized for Print

8. Remove the column shrouds.
9. Remove the clock spring.
10. Disconnect the wiring harness to the column.

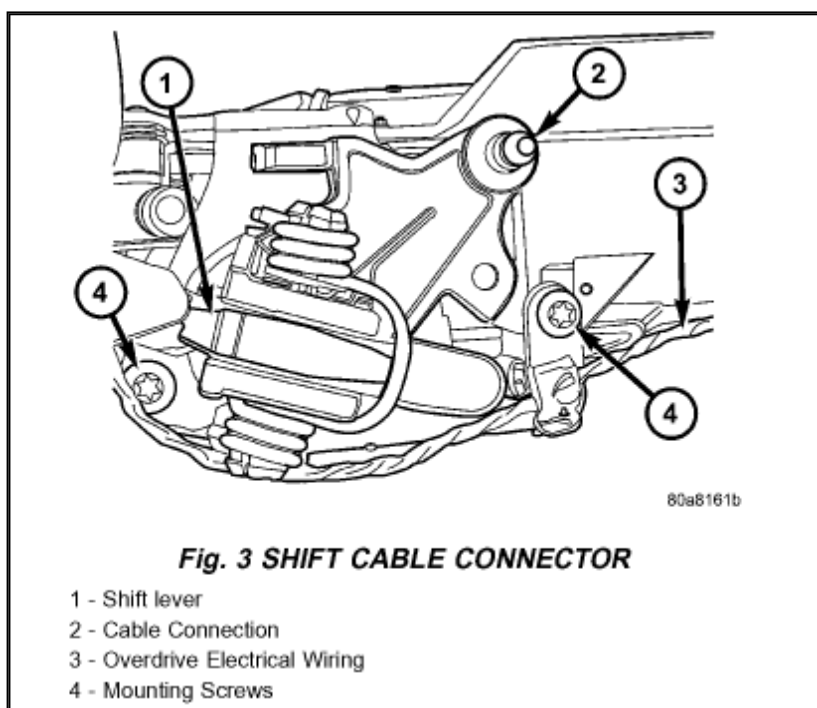

Zoom

Sized for Print

11. Remove the shift cable from the column shift lever actuator..
12. Release the shift cable from the column bracket and remove it from the bracket.
13. Remove the SKIM module in order to disconnect the electrical connector.

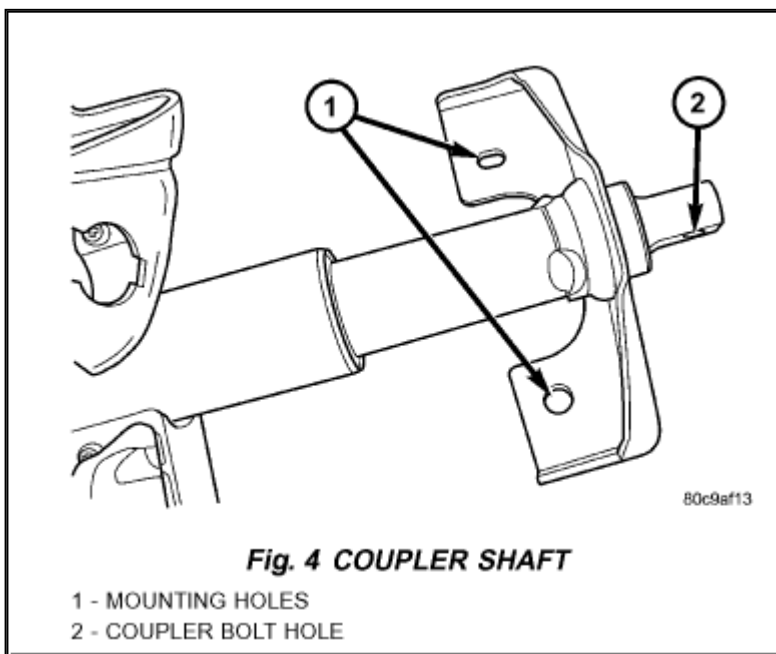

Zoom

Sized for Print

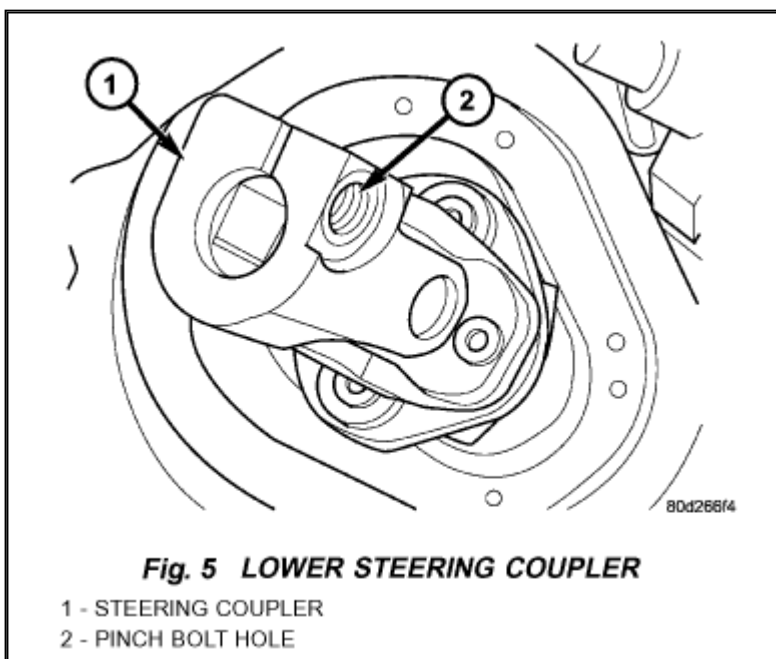

Zoom

Sized for Print

14. Remove the upper steering shaft coupler bolt and slide the shaft down &
15. Remove the brake light switch and discard.

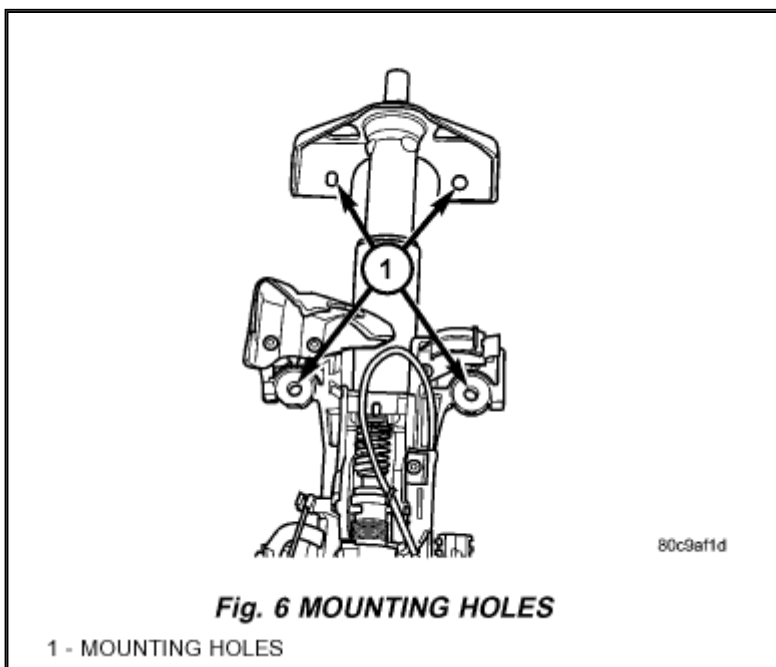

Zoom

Sized for Print

16. Remove the four steering column mounting nuts.

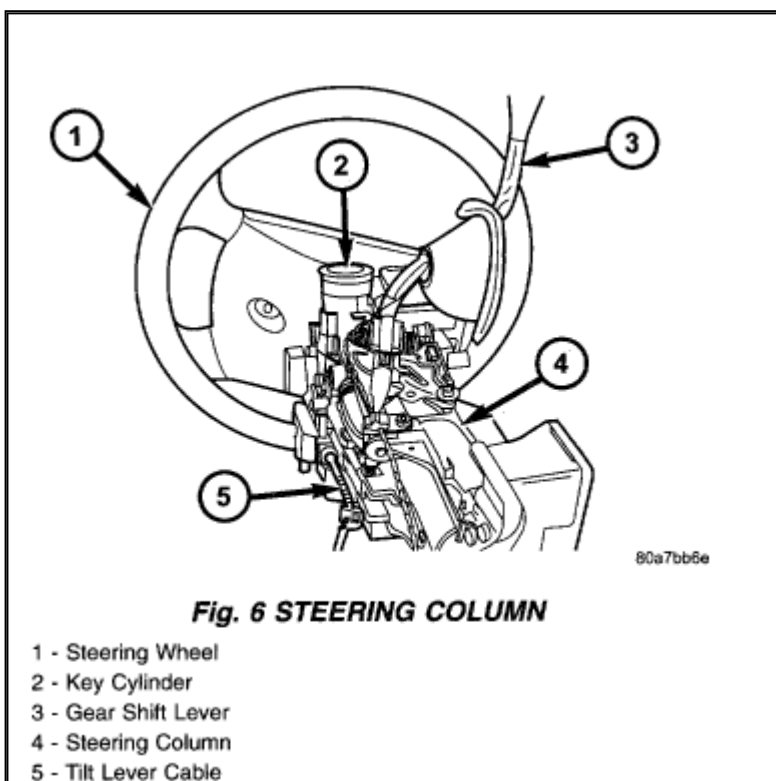

Zoom

Sized for Print

17. Remove the steering column assembly from the vehicle.

INSTALLATION

WARNING: BEFORE SERVICING THE STEERING COLUMN THE AIRBAG SYSTEM MUST BE DISARMED. REFER TO RESTRAINT SYSTEMS FOR SERVICE PROCEDURES. FAILURE TO DO SO MAY RESULT IN ACCIDENTAL DEPLOYMENT OF THE AIRBAG AND POSSIBLE PERSONAL INJURY.

CAUTION: All fasteners must be torqued to specification to ensure proper operation of the steering column.

1. Position the steering column on the dash panel support and loosely install the mounting nuts.
2. Firmly slide the steering column upward against the studs in dash panel and hand tighten the nuts.
3. Install the steering shaft coupler on the [steering shaft](#) and loosely install a new bolt.
4. Center steering column in dash opening and tighten mounting nuts to **28 Nm (250 inch lbs.)**. **NOTE:** Torque the upper left nut first then the lower right nut. Then torque the lower left nut then the upper right nut. **NOTE:** A new bolt must be used for reinstallation.
5. Tighten the coupler bolt to **57 Nm (42 ft. lbs.)**.
6. Install a new brake light switch.
7. Install the shifter cable.
8. Connect the wiring harness to the column.
9. Install the SKIM module.
10. Install the clock spring.
11. Install the shrouds.
12. Install the steering column opening cover.
13. Align the "D" flat on the [wheel hub](#) to shaft.
14. Then install the [steering wheel](#) and install a new bolt. Tighten the bolt to 61 Nm (45 ft. lbs.).
15. Install the airbag.
16. Install the two [steering wheel](#) switches.
17. Install the tilt lever handle.
18. Install the negative battery terminal.
19. Test the operation of the horn, Electronic PRNDL Indicator, lights and any other functions that are steering column operated.