

2003 Toyota Avalon V6-3.0L (1MZ-FE)

Vehicle Level → Transmission and Drivetrain → Automatic Transmission/Transaxle → Shifter A/T → Service and Repair → Removal ←

Removal

Notes

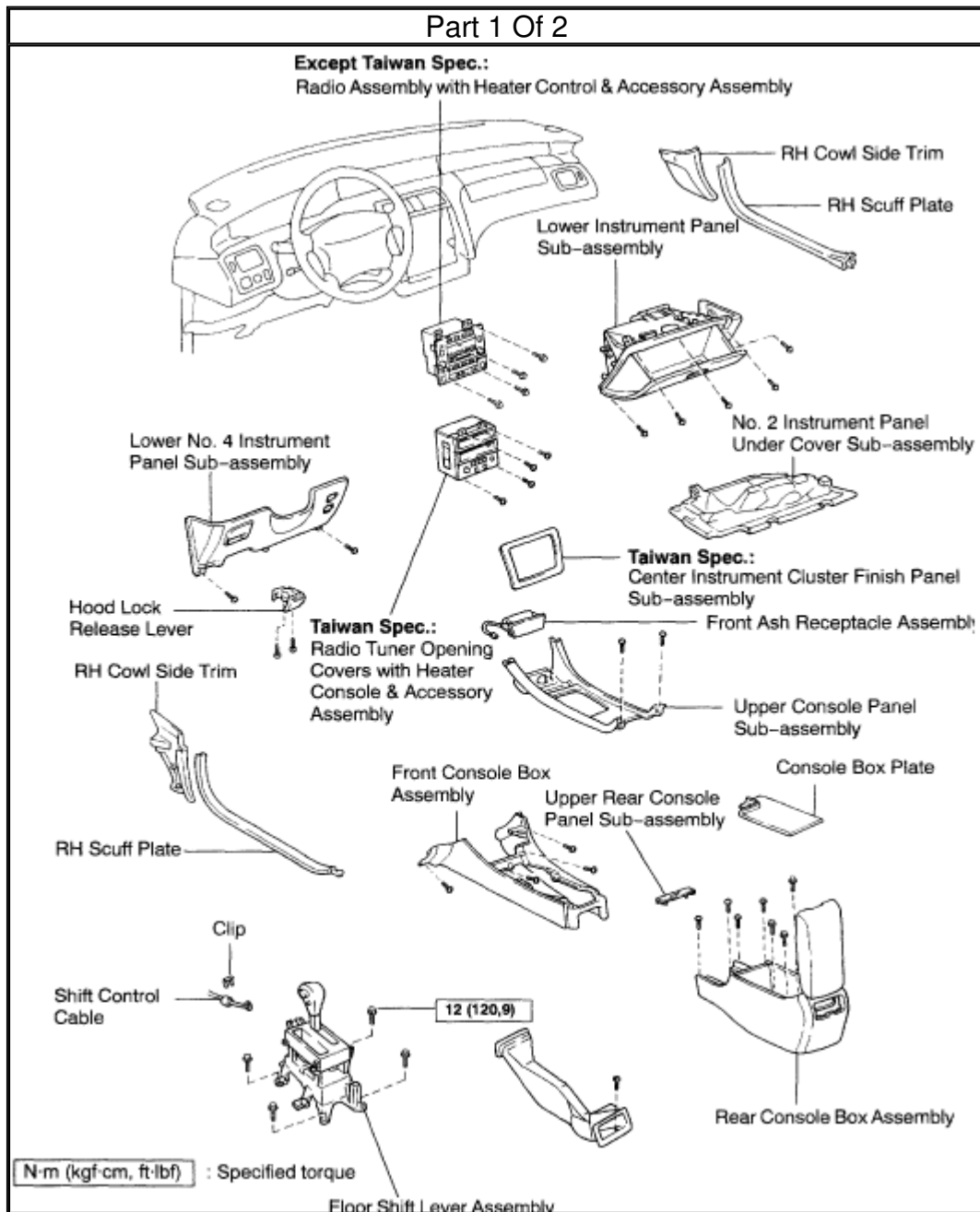

Zoom

Sized for Print

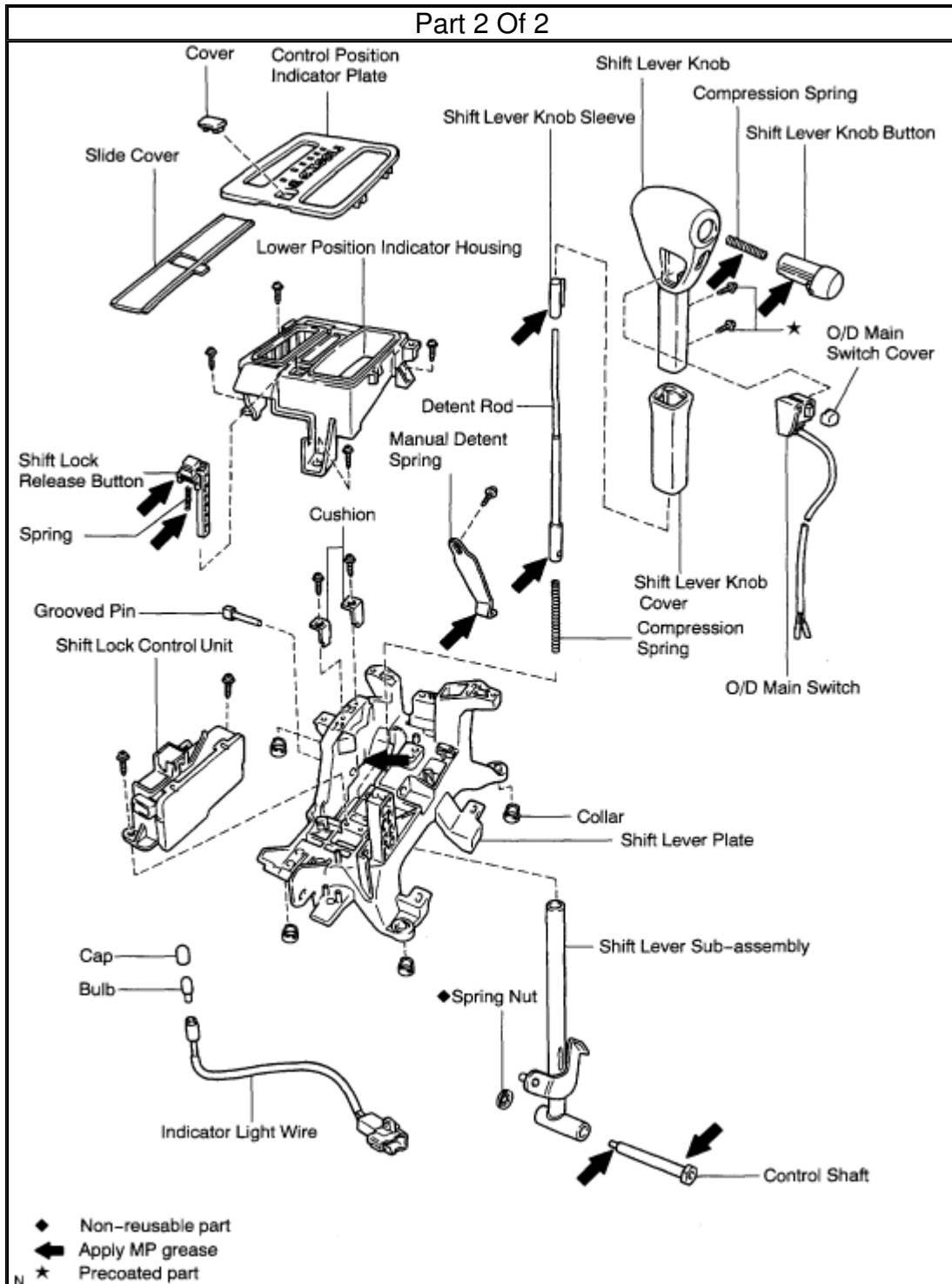

Zoom

Sized for Print

### Floor Shift Assembly

## REMOVAL

1. REMOVE UPPER REAR CONSOLE PANEL SUB-ASSEMBLY
2. REMOVE FRONT ASH RECEPTACLE ASSEMBLY
3. REMOVE UPPER CONSOLE PANEL SUB-ASSEMBLY
4. REMOVE CONSOLE BOX PLATE
5. REMOVE REAR CONSOLE BOX ASSEMBLY
6. REMOVE LH AND RH SCUFF PLATES
7. REMOVE LH AND RH COWL SIDE TRIMS
8. REMOVE LOWER No.1 INSTRUMENT PANEL SUBASSEMBLY
9. REMOVE NO.2 INSTRUMENT PANEL UNDER COVER SUB-ASSEMBLY
10. REMOVE LOWER INSTRUMENT PANEL SUB-ASSEMBLY
11. Taiwan Spec.: REMOVE CENTER INSTRUMENT CLUSTER FINISH PANEL SUB-ASSEMBLY
12. Taiwan Spec.: REMOVE RADIO TUNER OPENING COVERS WITH HEATER CONSOLE & ACCESSORY ASSEMBLY
13. Except Taiwan spec.: REMOVE RADIO ASSEMBLY WITH HEATER CONSOLE & ACCESSORY ASSEMBLY
14. REMOVE FRONT CONSOLE BOX ASSEMBLY
15. w/ Rear Heater: REMOVE REAR CONSOLE NO.1 BOX ASSEMBLY CONSOLE BOX DUCT Remove the clip and duct.

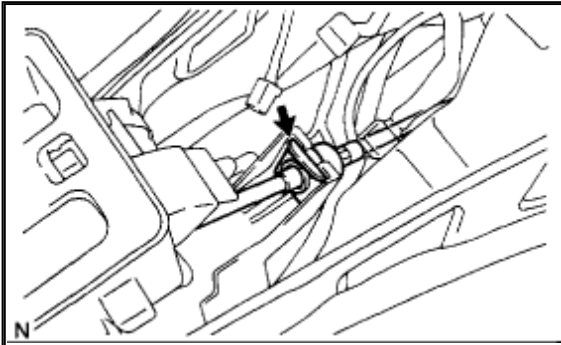

Zoom

Sized for Print

16. REMOVE FLOOR SHIFT LEVER ASSEMBLY
  - a. Remove the clip and disconnect the [shift cable](#) from the floor shift assembly.
  - b. Disconnect the wire harness from the wire harness clamp.

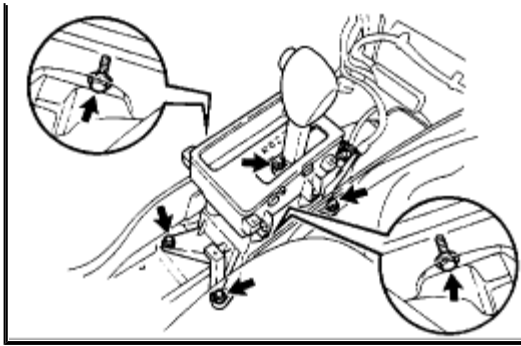

[Zoom](#)[Sized for Print](#)

- c. Remove the 2 bolts from the brace.
- d. Remove the 4 bolts and floor shift assembly. Torque: **12 Nm (120 kgf-cm, 9 ft. lbs.)**

© 2010 ALLDATA LLC. All rights reserved.  
[Terms of Use](#)