

Select Vehicle | New TSBs | Technician's Reference | Component Search:

 Conversion Calculator

**2000 Isuzu Truck Rodeo LS 2WD V6-3.2L**

[Vehicle Level](#) → [Technical Service Bulletins](#) → [All Technical Service Bulletins](#) → [A/T - Shift Lock Solenoid Replacement](#) ←

**A/T - Shift Lock Solenoid Replacement**

Light Duty	RODEO	1998	Bulletin	TRANSMISSION	05/01/05
Light Duty	RODEO	1999	Bulletin	TRANSMISSION	05/01/05
Light Duty	RODEO	2000	Bulletin	TRANSMISSION	05/01/05
Light Duty	RODEO	2001	Bulletin	TRANSMISSION	05/01/05
Light Duty	RODEO	2002	Bulletin	TRANSMISSION	05/01/05
Light Duty	RODEO	2003	Bulletin	TRANSMISSION	05/01/05
Light Duty	RODEO	2004	Bulletin	TRANSMISSION	05/01/05
Light Duty	RODEOSPT	1998	Bulletin	TRANSMISSION	05/01/05
Light Duty	RODEOSPT	1999	Bulletin	TRANSMISSION	05/01/05
Light Duty	RODEOSPT	2000	Bulletin	TRANSMISSION	05/01/05
Light Duty	RODEOSPT	2001	Bulletin	TRANSMISSION	05/01/05
Light Duty	RODEOSPT	2002	Bulletin	TRANSMISSION	05/01/05
Light Duty	RODEOSPT	2003	Bulletin	TRANSMISSION	05/01/05
Light Duty	RODEOSPT	2004	Bulletin	TRANSMISSION	05/01/05
Light Duty	AXIOM	2002	Bulletin	TRANSMISSION	05/01/05
Light Duty	AXIOM	2003	Bulletin	TRANSMISSION	05/01/05
Light Duty	AXIOM	2004	Bulletin	TRANSMISSION	05/01/05

Zoom

Sized for Print

TSB SB05-05-5004

Shift Lock Solenoid

ISSUE DATE: MAY 2005

Affected Vehicles

2002-2004 Isuzu Axiom (UP)

1998-2004 Isuzu Rodeo (UE) and Rodeo Sport (UA)

Service Information

Use the following steps to remove and replace the Shift Lock Solenoid.

Service Procedure

1. Access the Shift Lock Solenoid by removing the Center, Front, Rear Console Assemblies, Selector Lever Knob, and Cover Assembly. Refer to the Selector Lever section in the Service Manual.

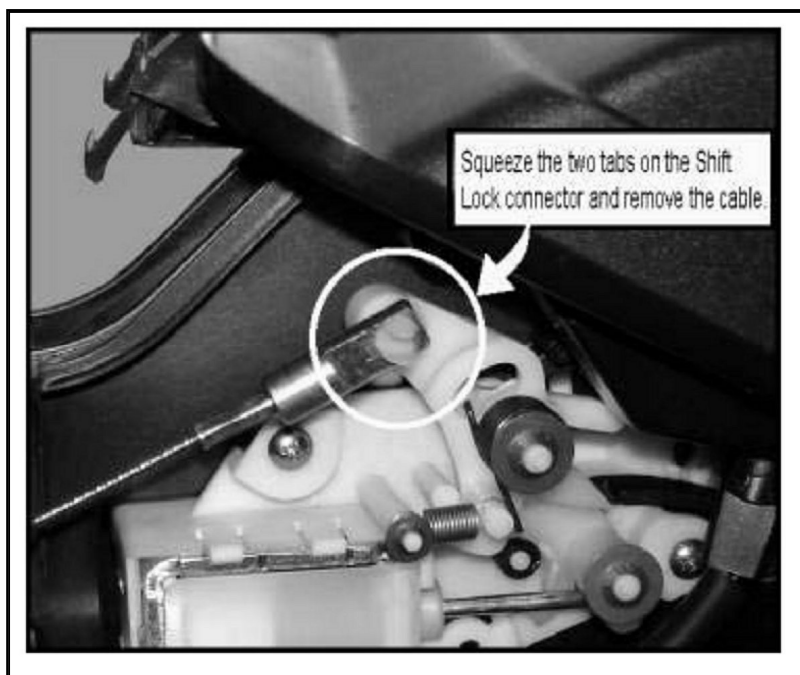

Zoom

Sized for Print

2. Set parking brake, move Selector Lever to lowest gear, and remove the Shift Lock Cable.

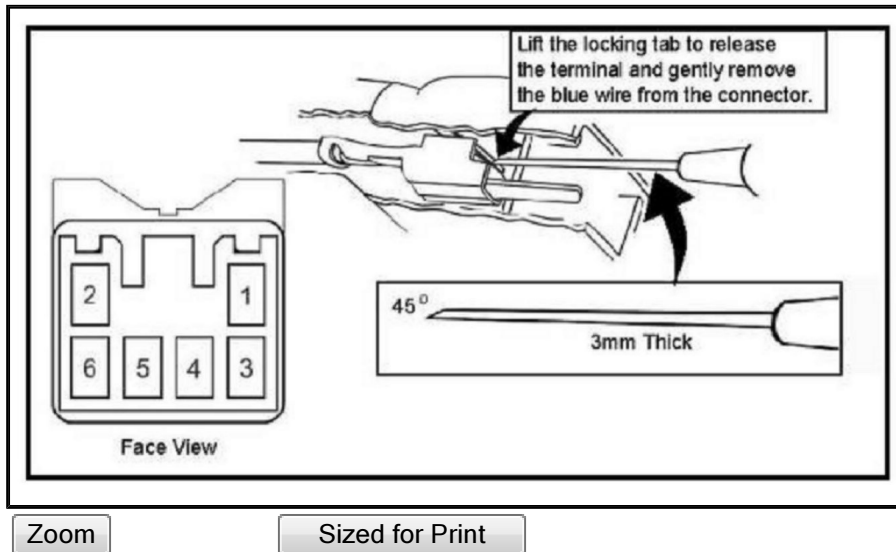

3. Remove the two screws securing the Shift Lock Solenoid to the Selector Lever subassembly. Disconnect the Shift Lock Solenoid 2-pin connector.
4. Disconnect the 1-40 (Rodeo) or 1-3 (Axiom) six-pin connector and slide the female connector off bracket. Remove the Terminal Position Assurance (TPA) Lock from the connector. Locate the two blue wires in position 1 and 3 on the female connector. With appropriate tool (shown above), apply light pressure upward on the connector locking tab while gently pulling on the blue wire to release.

Note :Never use force to remove a terminal from a connector.

5. Insert the two blues wires from the replacement Shift Lock Solenoid into the 1-40 (Rodeo) or 1-3 (Axiom) female connector. It does not matter which blue wire is inserted into the 1 and 3 position. Gently tug the blue wires to make sure they are secure.

NOTE :Discard the extra 2-pin connector sub harness included with replacement Shift Lock Solenoid P/N 8-97181-068-2.

6. Reconnect the Shift Lock Solenoid 2-pin connector and reattach the two screws securing the Shift Lock Solenoid to the selector lever subassembly.
7. Reconnect the 1-40 (Rodeo) or 1-3 (Axiom) six-pin connector and slide the female connector onto the bracket.
8. Reinstall the Selector Lever Knob, Cover Assembly, Center, Front, and Rear Console Assemblies. Refer to the Selector Lever section in the Service Manual.
9. Check Shift Lock operation:
  - a. With ignition key in "Lock" position, Selector lever should not move from "P" position.
  - b. With ignition key in "ON" position and brake pedal depressed. Selector lever can be moved out of "P" position.
  - c. Key can be removed only when turned to "LOCK" position and selector lever is in "P" position.

### Warranty Claim Information

Operation	Operation No.	Task	Special Instructions	Time	Additional Instructions	Failed P/N	Trouble Code
Shift Lock Solenoid Replace	051433D	Replace		0.5 hr	Includes: R&R Center Console	8-97181-068-2	71
			PLUS:	0.5 hr	Maximum diagnosis time allowed		

Zoom

Sized for Print

Use the labor operation shown.

**NOTE :**

1. Labor Time includes administrative time allowance.
2. Information released on paper and electronic format prior to bulletin release cannot be updated. For the most current and up to date information refer to website
3. Always refer to the Isuzu Service Policy Procedure Manual for specific details on warranty coverage and policies.

This Service Bulletin is intended for use by professional, qualified technicians. Attempting repairs or service without the appropriate training, tools, and equipment could cause injury to you or others and damage to your vehicle that may cause it not to operate properly.

Zoom

Sized for Print

### Disclaimer