

Select Vehicle | New TSBs | Technician's Reference

Component Search:

OK

Conversion Calculator

2004 Ford Truck F 150 2WD Pickup V8-5.4L SOHC VIN 5

[Vehicle Level](#) → [Steering and Suspension](#) → [Steering](#) → [Steering Column](#) → [Service and Repair](#) → [Steering Column](#) → [Removal and Installation](#) ←

Removal and Installation

Steering Column

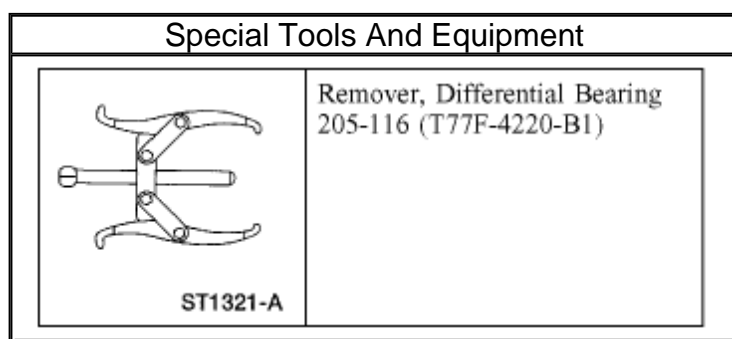

Zoom

Sized for Print

Special Tool(s)

Removal and Installation

1. Turn the [steering wheel](#) to the straight-ahead position and turn the ignition switch to the OFF position.

NOTE: If removing the [steering wheel](#) or steering column, carry out Steps 2 and 3 before starting the removal procedure. If removing the steering column shaft, proceed to Item 8 of the removal procedure.

2. **WARNING: To reduce the risk of serious personal injury, read and follow all warnings, cautions and notes in the deactivation procedure.**

Deactivate the Supplemental Restraint System (SRS) .

3. If removing the [steering wheel](#), remove the driver air bag module.
4. If removing the steering column, remove the clockspring.
5. If removing the steering column, remove the instrument panel reinforcement.
6. Remove the parts in the order indicated in the illustration and table.



Part	Steps
Steering wheel	1, 2
Steering column	1-14
Intermediate steering column shaft	11, 15-18
Lower steering column shaft	16, 19, 20
Dash boot bearing	16, 19, 20, 15, 17

Zoom

Sized for Print

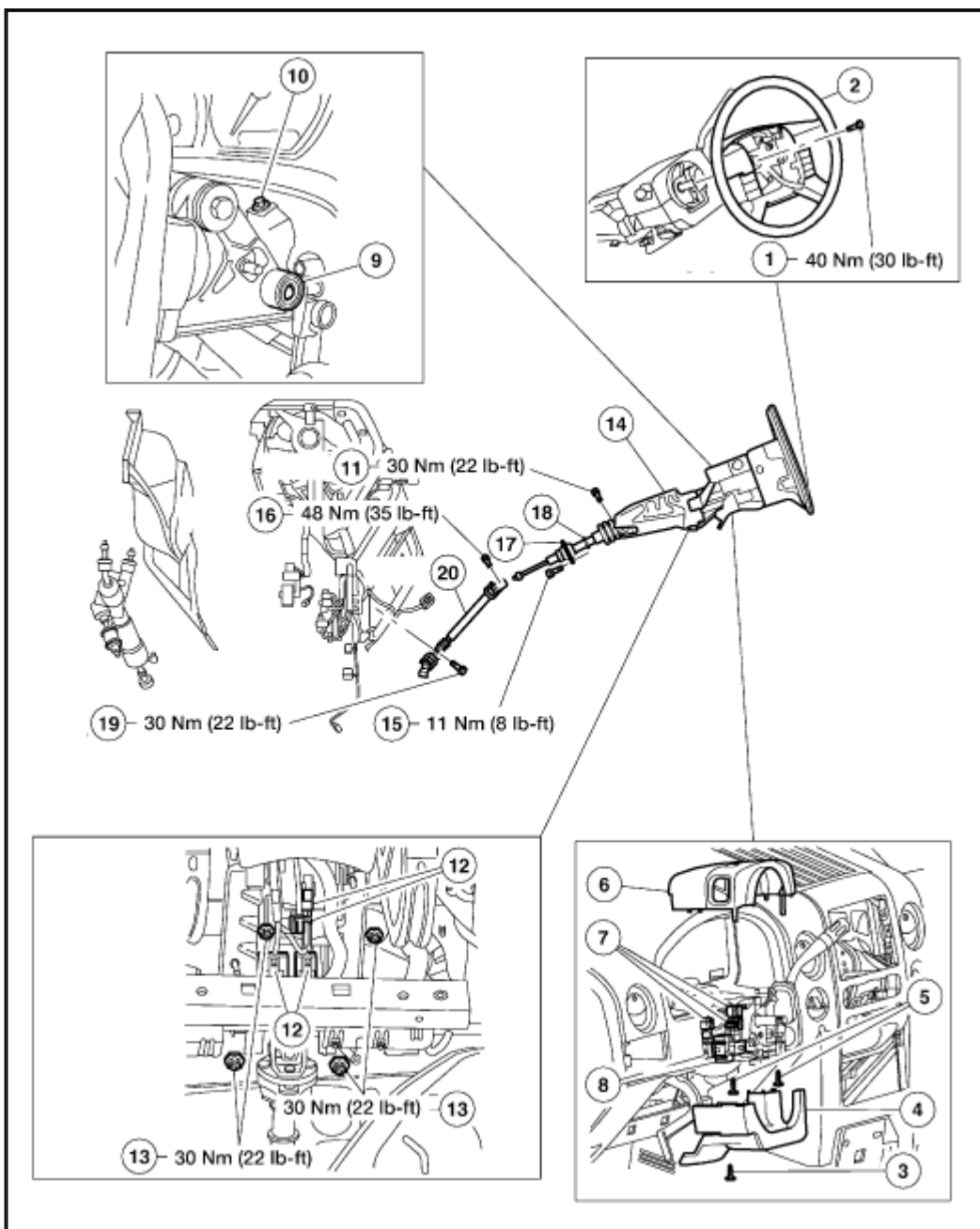

Zoom

Sized for Print

Item	Part Number	Description
1	043B13	Steering wheel bolt Removal Note
2	3600	Steering wheel Removal Note
3	W504041-S309	Lower column shroud screw
4	3530	Steering column lower shroud
5	W705447-S309U	Upper column shroud screws
6	3530	Steering column upper shroud
7	—	Multifunction switch electrical connectors (part of 14401)
8	—	Ignition switch electrical connector (part of 14401)
9	7E395	Shift cable (disconnect/column shift only)
10	7A110	Shift position indicator (disconnect/column shift only)
11	N808684-S100	Intermediate steering column shaft-to-steering column bolt Removal Note
12	—	Electrical connectors (part of 14401)
13	W700390-S309	Steering column support-to-instrument panel nuts (4 req'd) Installation Note
14	3C529	Steering column assembly Removal Note Installation Note
15	W708568-S301	Dash seal bolts
16	N801614-S102	Lower steering column shaft-to-Intermediate steering column shaft bolt Removal Note
17	3D677	Dash boot bearing
18	3E751	Intermediate steering column shaft-to-steering column Removal Note Installation Note
19	N808684-S100	Lower steering column shaft-to-steering gear bolt Removal Note
20	3B676	Lower steering column shaft Removal Note Installation Note

Zoom

Sized for Print

To remove individual parts, only carry out the listed steps:

7. To install, reverse the removal procedure.
8. **WARNING: To reduce the risk of serious personal injury, read and follow all warnings, cautions and notes in the reactivation procedure.**

If deactivated, reactivate the Supplemental Restraint System (SRS) .

Item 1: [Steering Wheel](#) Bolt Removal Note

1. Loosen the bolt until the [steering wheel](#) has been separated from the column and then remove the bolt.

Item 2: [Steering Wheel](#) Removal Note

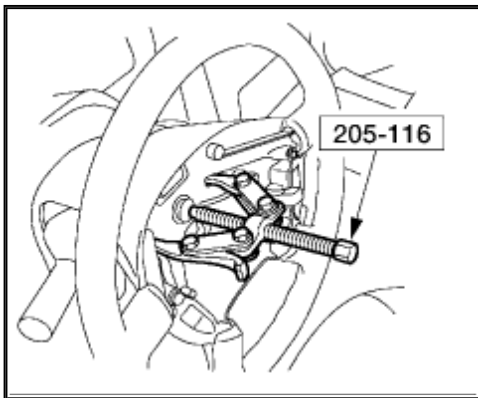

Zoom

Sized for Print

1. **CAUTION:** Removing the [steering wheel](#) without using a puller can damage the column bearings.

Use the special tool to remove the [steering wheel](#).

Item 11: Intermediate Steering Column Shaft-to-Steering Column Bolt Removal Note

1. **CAUTION:** Do not allow the steering column shaft to rotate while the intermediate shaft is disconnected or damage to the clockspring can result. If there is evidence that the shaft has rotated, the clockspring must be removed and recentered.

Remove and discard the bolt then disconnect the shaft from the column.

Item 14: Steering Column Assembly Removal Note

1. Lower the steering column assembly and separate the steering column assembly from the intermediate [steering shaft](#).

Item 16: Intermediate Shaft-to-Lower Shaft Bolt Removal Note

1. Separate the intermediate shaft from the lower shaft.

Item 18: Intermediate [Steering Shaft](#) Removal Note

1. Separate the steering column assembly from the intermediate [steering shaft](#).

Item 19: Lower Shaft-to-[Steering Gear](#) Bolt Removal Note

1. With the transmission in NEUTRAL position on a hoist.

Item 20: Lower [Steering Shaft](#) Removal Note

1. Separate the lower [steering shaft](#) from the intermediate shaft and the [steering gear](#).

Item 20: Lower [Steering Shaft](#) Installation Note

1. Connect the lower [steering shaft](#) to the intermediate shaft and the [steering gear](#).

Item 18: Intermediate [Steering Shaft](#) Installation Note

1. Connect the steering column assembly to the intermediate [steering shaft](#).

Item 14: Steering Column Assembly Installation Note

1. Connect the steering column assembly to the intermediate [steering shaft](#) and position the steering column assembly on the instrument panel studs.

Item 13: Steering Column Support-to-Instrument Panel Nuts Installation Note

1. Make sure that the column support bracket is aligned before tightening the nuts.