

Applies To: **2007-08 CR-V** – ALL VINs Beginning With JHL
2009 CR-V – From VIN JHLRE3...9C000001 to JHLRE3...9C012809
 – From VIN JHLRE4...9C000001 to JHLRE4...9C013645

June 5, 2009

Windshield Washer Pump Does Not Work

(Supersedes 07-072, dated April 29, 2009, to revise the information marked by the black bars)

REVISION SUMMARY

- Under PARTS INFORMATION, the required parts have been changed.
- Under WARRANTY CLAIM INFORMATION, the template ID was changed.
- Steps 6 through 15 of the REPAIR PROCEDURE were changed to show the new parts.

SYMPTOM

The windshield washer pump does not work.

PROBABLE CAUSE

Impact to the front bumper pushes the bumper back far enough to break the washer pump hose fitting.

CORRECTIVE ACTION

Replace the windshield washer reservoir and washer motor with updated parts.

PARTS INFORMATION

Washer Motor	P/N 76806-SMA-J01 H/C 8518458
Tube (FR), 1,260 mm	P/N 76837-SWA-003 H/C 8518540
Tube (RR), 930 mm	P/N 76834-SWA-003 H/C 8518524
Washer Tank (2.5L, FR-RR)	P/N 76841-SWA-305 H/C 9174905
Washer Tank Bush	P/N 76842-S2K-J11 H/C 7023880

WARRANTY CLAIM INFORMATION

In warranty: The normal warranty applies.

Operation Number: 7401C5

Flat Rate Time: 0.7 hour

Failed Part: P/N 76806-SMA-J01
HC 8518458

Defect Code: 01701

Symptom Code: 01201

Template ID: 07-072C

Skill Level: Repair Technician

Out of warranty: Any repair performed after warranty expiration may be eligible for goodwill consideration by the District Parts and Service Manager or your Zone Office. You must request consideration, and get a decision, before starting work.

REPAIR PROCEDURE

1. Turn the ignition switch to ACC (I) to unlock the steering column.
2. Raise the vehicle on a lift.
3. Remove the right front inner fender.

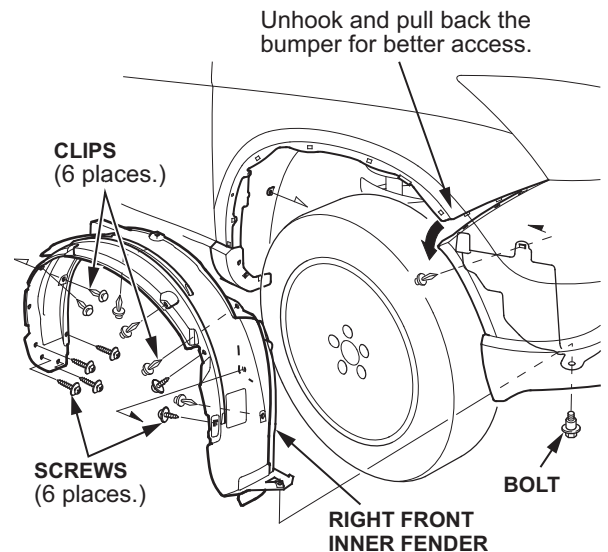

4. Release the hooks on the upper right side of the front bumper.

- Remove the clip from the filler neck, then remove the filler neck.

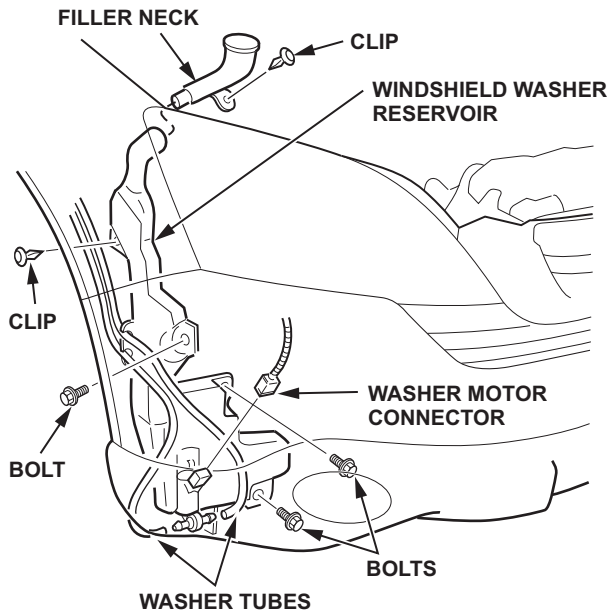

- Remove the right front fender trim, and disconnect the washer hose from the 90-degree fitting.

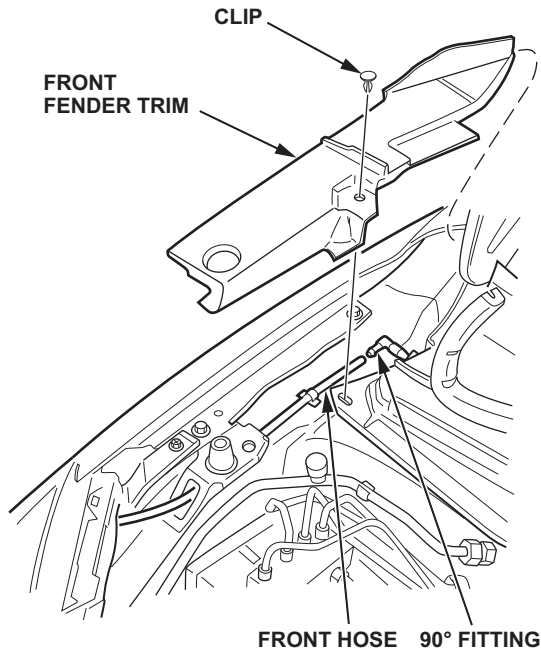

- Disconnect the 2P connector and the two washer tubes from the washer motor.
- Remove the washer reservoir clip and the three bolts, then pull out the reservoir.

- Assemble the new reservoir components, but do not install the filler neck.

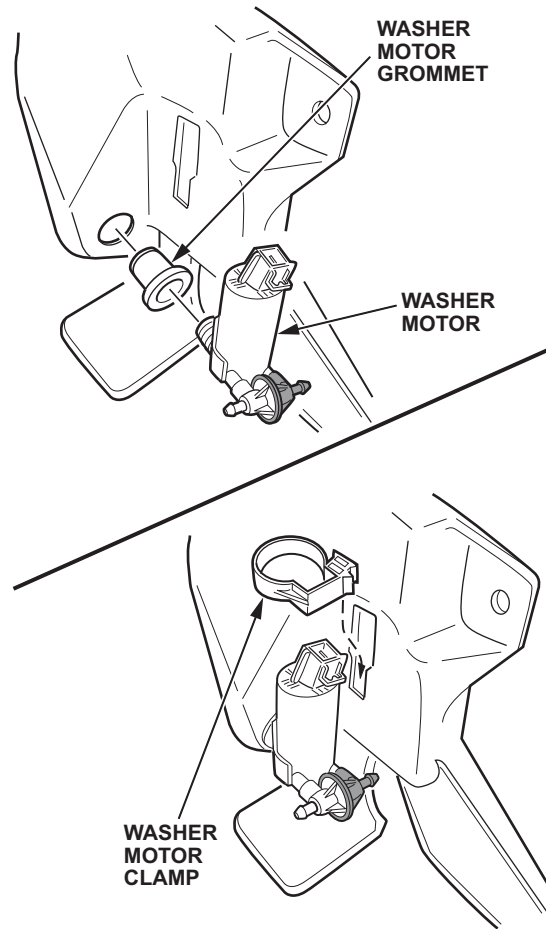

10. Trim 85 mm off the end of the 1,260 mm washer tube only.

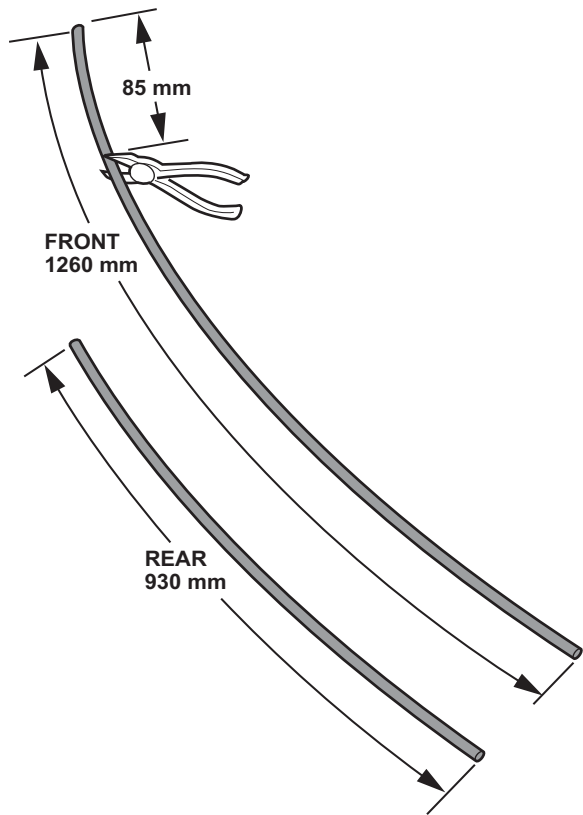

11. Route the washer tubes on the reservoir.

NOTE: The black fitting is for the front windshield nozzles, and the white fitting is for the rear nozzle.

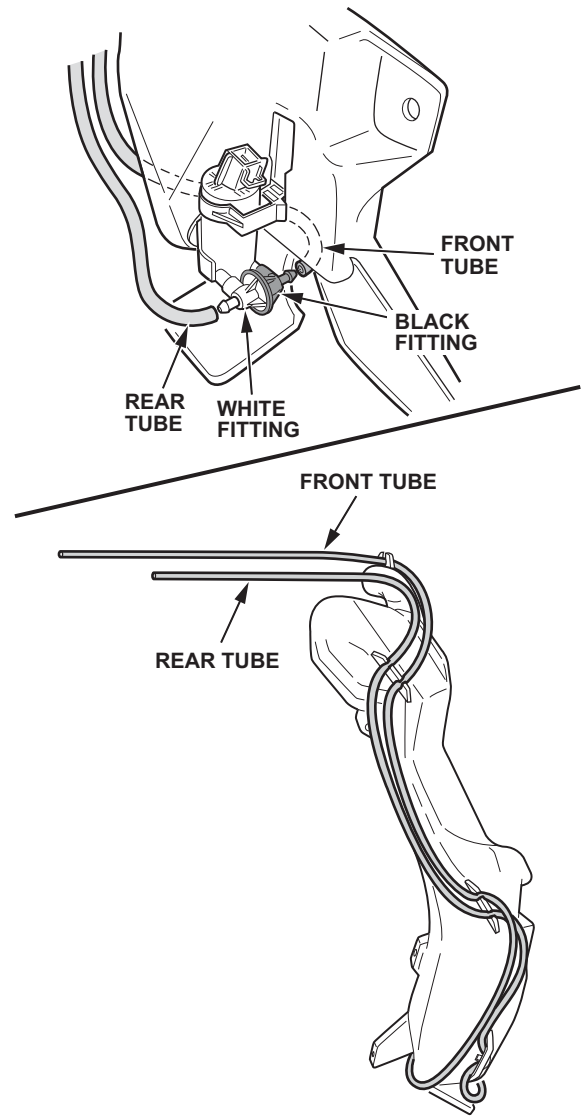

12. Install the reservoir.

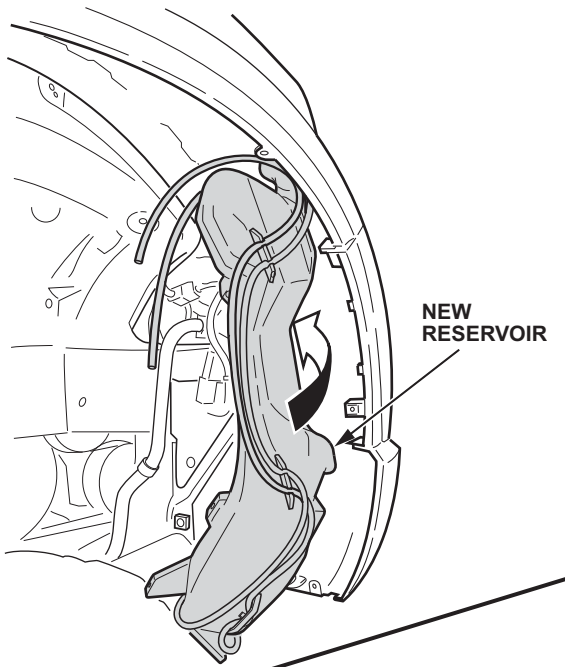

Connect the rear washer tube.

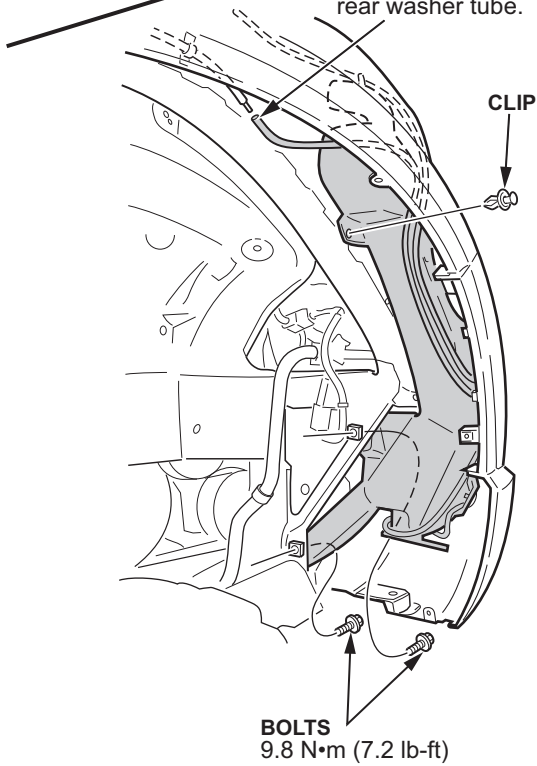

13. Connect the rear tube to the straight fitting in the wheelwell.

14. Connect the 2P connector to the washer motor.

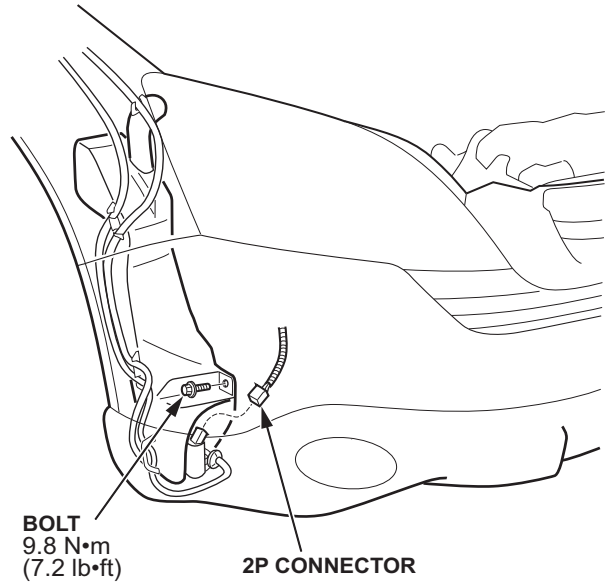

15. Install the filler neck with the original clip. Connect the front washer tube to the 90-degree fitting. Then reinstall the front fender trim.

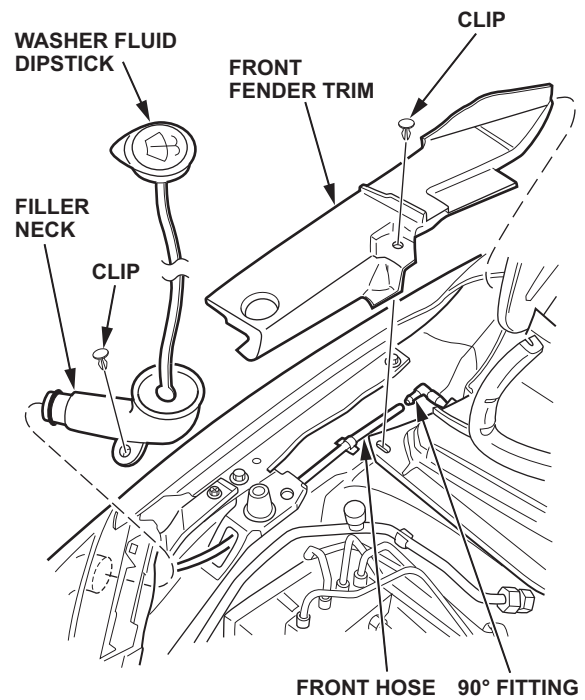

16. Fill the reservoir with windshield washer fluid, and install the filler cap.

17. Check the operation of the windshield washer and the rear window washer.

NOTE: If the washer fluid does not spray from the correct location, reverse the tubes on the washer motor.

18. Reinstall the inner fender.