

Transmission**Special Tool(s)**

 <p>ST1636-A</p>	<p>Torque Converter Holding Tool 307-346 (T97T-7902-A)</p>
---	--

NOTE: If the transmission is to be removed for a period of time, support the engine with a safety stand and a wood block.

1. Disconnect the battery ground cable. For additional information, refer to [Section 414-01](#).
2. Place the selector lever in NEUTRAL position.

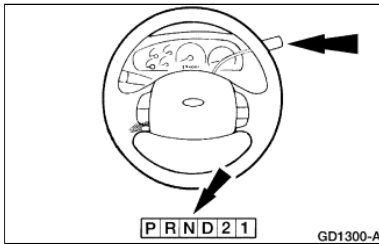

3. For vehicles equipped with a 4.0L SOHC engine, remove the fluid level indicator tube bolt from the heater hose bracket and remove the tube and indicator.

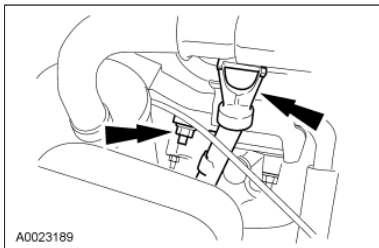

4. Raise and support the vehicle. For additional information, refer to [Section 100-02](#).
5. If transmission disassembly is required; drain the transmission fluid. For additional information, refer to [Fluid Pan, Gasket and Filter](#) in this section.
6. Vehicles equipped with 4WD, remove the transfer case. For additional information, refer to [Section 308-07B](#).
7. To maintain initial driveshaft balance, mark the driveshaft yoke and axle flange, so they can be installed in their original positions.

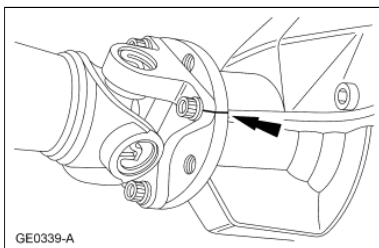

8. Remove the rear driveshaft.
 1. Remove the four bolts.
 2. Remove the driveshaft.

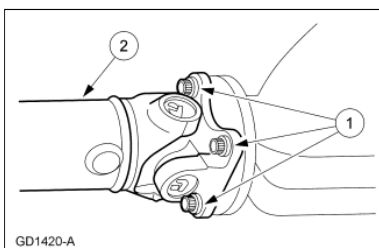

9. Remove the starter motor. For additional information, refer to [Section 303-06](#).
10. **NOTE:** Mark the torque converter and the flexplate for correct alignment at reinstallation.

Remove the four nuts.

- Rotate the flexplate to access all the nuts.

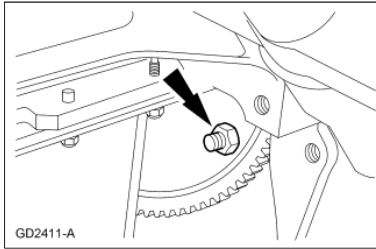

11. Disconnect the shift cable.
 1. Disconnect the shift cable from the manual control lever.
 2. Disconnect the shift cable from the bracket.

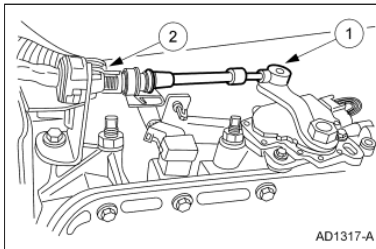

12. Remove the transmission wiring harness.
 1. Disconnect the heated oxygen sensor (HO2S) connector.
 2. Disconnect the transmission connector.
 3. Disconnect the output shaft speed (OSS) sensor connector.
 4. Disconnect the digital transmission range (TR) sensor connector.

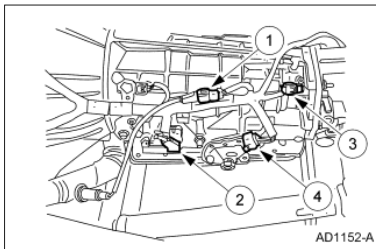

13. Remove the three-way catalytic converter. For additional information, refer to [Section 309-00](#).

14. **CAUTION:** Care should be taken not to damage the cooler lines.

Hold the case fitting and remove the transmission cooler lines.

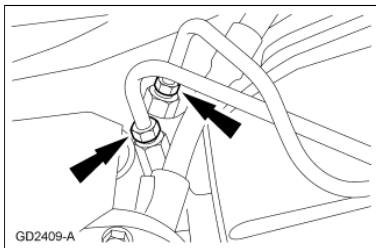

15. Remove the transmission nuts.

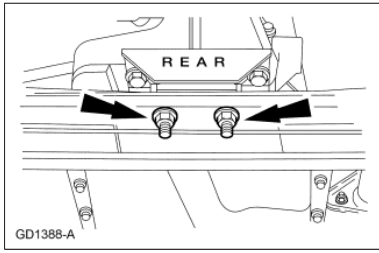

16. **CAUTION:** Do not allow the transmission to hang freely.

Position the High-Lift Transmission Jack under the transmission. Raise and support the transmission.

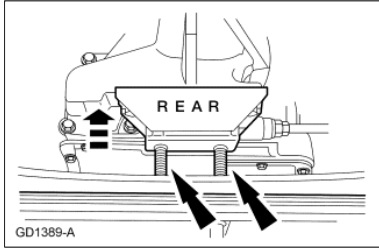

17. Remove the crossmember.
 1. Remove the six bolts (three each side).
 2. Remove the crossmember.

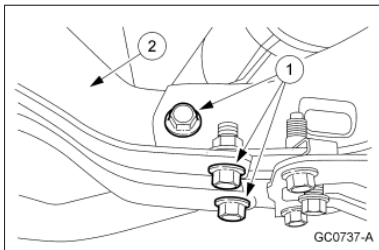

18. Remove the transmission mount.
 1. Remove the screws.
 2. Remove the transmission mount.

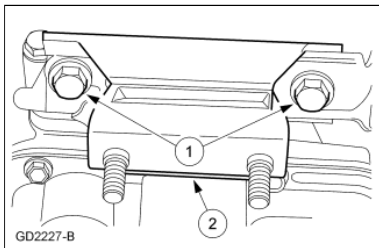

19. For vehicles equipped with a 4.0L EI engine, remove the transmission upper fill tube.
 1. Remove the screws.
 2. Disconnect the transmission upper fill tube.

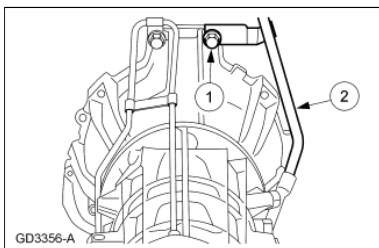

20. **NOTE:** Lower the High-Lift Jack to gain access to the transmission-to-engine screws.
 Remove the transmission-to-engine screws.

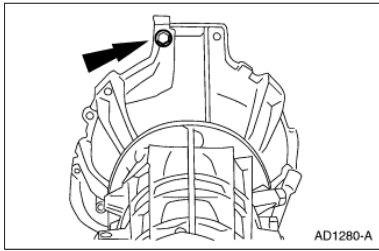

21. **⚠ WARNING:** The torque converter is heavy and may result in injury if it falls out of the transmission. Secure the torque converter in the transmission. Failure to follow these instructions may result in personal injury.

Install the Torque Converter Holding Tool before lowering the transmission from the vehicle.

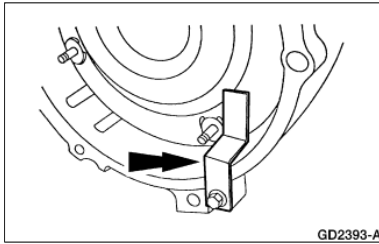

22. **⚠ WARNING:** Secure the transmission to the transmission jack with a safety chain. Failure to follow these instructions may result in personal injury.

Lower the transmission.

23. On 4x4 models remove the vent tube.

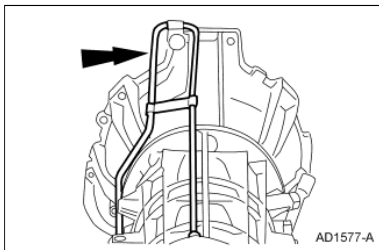

24. Carry out the Transmission Fluid Cooler Back Flushing/Cleaning. For additional information, refer to [Transmission Fluid Cooler — Backflushing and Cleaning](#) in this section.
-