

| | | |
|---|--------|---------------------------|
| 2 | 18658 | Heater Core Case Seal |
| 3 | 18476 | Heater Core |
| 4 | 18570 | Heater Dash Gasket |
| 5 | 18471 | Heater Air Plenum Chamber |
| 6 | 18B300 | Heater Core Cover |

3. Pull the heater core (18476) assembly from the heater air plenum chamber assembly.

Installation

1. Carefully install heater core assembly into the heater air plenum chamber assembly. Visually check to ensure that heater core case seal (18658) is properly positioned.
 2. Position the heater core cover and install the four retaining screws.
 3. Install the heater air plenum chamber assembly as outlined.
-

Heater Air Plenum Chamber

Removal

1. Disconnect battery ground cable (14301). Refer to [Section 14-01](#).
2. Disconnect the heater water hoses (18472) from the heater core tubes. Plug the ends of the heater water hoses to prevent coolant loss.
3. Plug heater core tubes securely to prevent coolant leakage from heater core (18476) during heater air plenum chamber removal.
4. Remove three nuts located below the windshield wiper motor (17508) retaining the LH end of the heater air plenum chamber (18471) to the dash panel (01610).
5. Remove one nut retaining the upper LH corner of the A/C evaporator core housing (19A559) to the dash panel.
6. Remove LH and RH lower instrument panel insulators.
7. Disconnect two vacuum supply hoses from vacuum source. Push grommet and vacuum supply hose into passenger compartment.
8. Remove all instrument panel retaining screws and pull the instrument panel (04320) back as far as possible without disconnecting any wire harnesses.
9. Loosen the RH door sill plate and remove the RH side cowl trim panel.
10. Remove cross body brace and disconnect wiring harness from A/C electronic door actuator motor (19E616) and disconnect the sensor tube from the evaporator case connector.
11. Disconnect the vacuum jumper harness at the multiple vacuum connector near the heater outlet floor duct (18C433).
12. Disconnect the white vacuum hose from the heater and A/C air inlet duct door vacuum

control motor (18A318).

13. Remove two hush panels.
14. Remove one plastic push fastener retaining the heater outlet floor duct to the LH end of the heater air plenum chamber. Remove LH screw and loosen RH screw on the rear face of the heater air plenum chamber and remove the heater outlet floor duct.
15. Remove two nuts from the two studs along the lower flange of the heater air plenum chamber.
16. Carefully move heater air plenum chamber rearward to allow heater core tubes and the stud at the top of the heater air plenum chamber to clear holes in the dash panel. Remove heater air plenum chamber from vehicle by rotating the top of the heater air plenum chamber forward, down and out from under the instrument panel. Carefully pull lower edge of instrument panel rearward as necessary while rolling the heater air plenum chamber from behind the instrument panel.

Heater Air Plenum Chamber and Air Inlet Duct

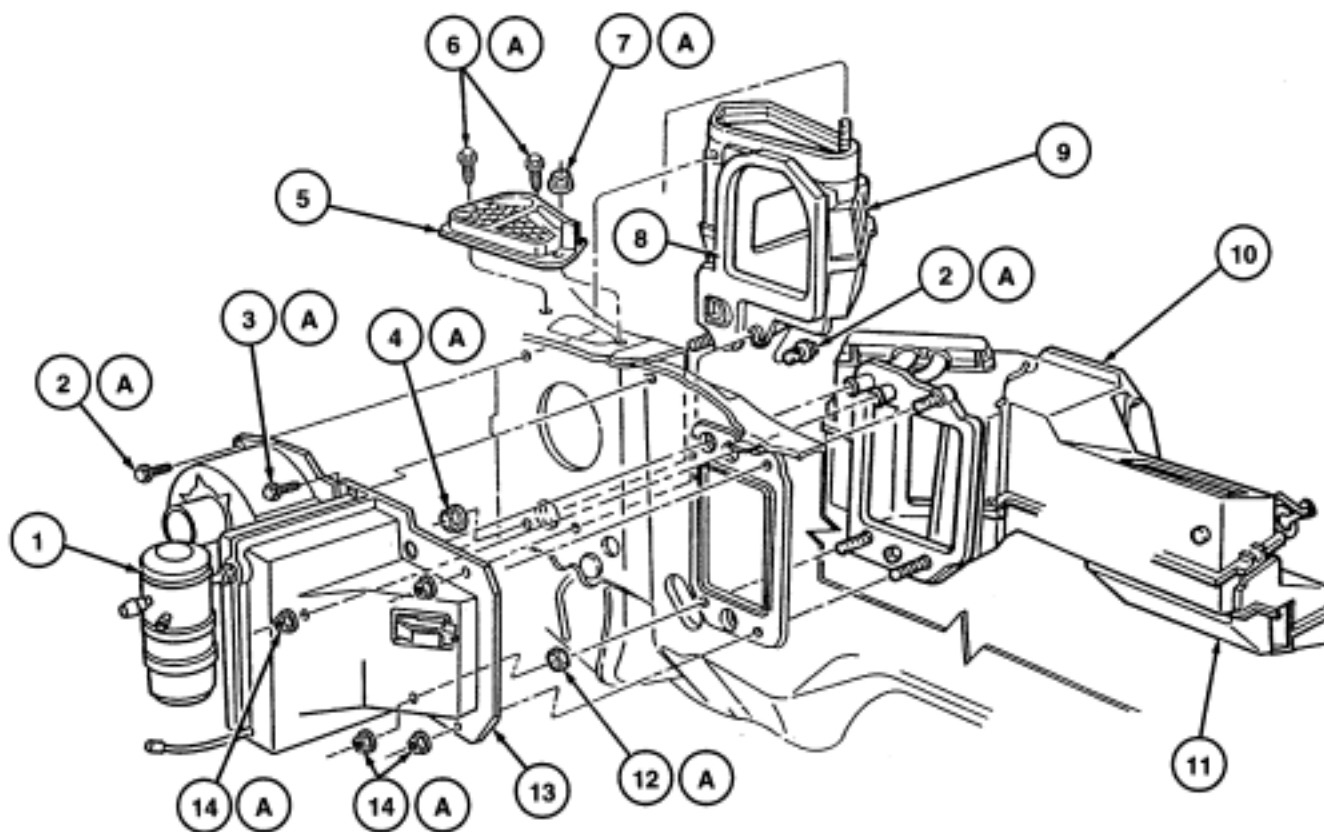

M3438-C

| Item | Part Number | Description |
|------|-------------|-------------------------------------|
| 1 | 19C836 | Suction Accumulator/Drier |
| 2 | 56956-S2 | Screw (2 Req'd) |
| 3 | 386877-S36 | Screw |
| 4 | 45445-S36 | Nut and Washer Assy |
| 5 | 19C928 | A/C Recirculating Air Duct Screen |
| 6 | 386877-S36M | Screw (2 Req'd) |
| 7 | 45332-S12 | Nut and Washer |
| 8 | 19B762 | A/C Air Inlet Door Inner Seal |
| 9 | 19C590 | A/C Recirculating Air Duct |
| 10 | 18471 | Heater Air Plenum Chamber |
| 11 | 18C433 | Heater Outlet Floor Duct |
| 12 | 55734-S2 | Nut |
| 13 | 19A559 | A/C Evaporator Core Housing |
| 14 | 45332-S2 | Nut and Washer |
| A | — | Tighten to 2.5-3.2 Nm (22-28 Lb-In) |

Installation

1. Route the vacuum supply hose through the dash panel and seat the grommet in the opening.
2. Position the heater air plenum chamber under the instrument panel with the A/C register duct opening up and the heater core tubes down. Rotate the heater air plenum chamber up behind the instrument panel and position the heater air plenum chamber to the dash panel. Insert the heater core tubes and mounting studs through their respective holes in the dash panel and the A/C evaporator core housing.
3. Install three nuts on the studs along the lower flange and one on the upper flange of the heater air plenum chamber.
4. Install three nuts below the windshield wiper motor to retain the LH end of the heater air plenum chamber to the dash panel.

5. Install one nut to retain the upper LH corner of the A/C evaporator core housing to the dash panel.
6. Position heater outlet floor duct on heater air plenum chamber. Install two screws and plastic push fastener.
7. If removed, position heater air damper door vacuum control motor to the mounting bracket. Install two retaining screws.
8. Connect the white vacuum hose to the heater and A/C air inlet duct door vacuum control motor.
9. Connect the vacuum jumper harness to the plenum harness at the multiple vacuum connector near the heater outlet floor duct. Install heater outlet floor duct.
10. Connect the sensor tube to the evaporator case connector on EATC-equipped vehicles.
11. Install the cross body brace and connect wiring harness to the A/C electronic door actuator motor.
12. Install the bolt to retain the lower RH end of the instrument panel to the side cowl.
13. Install the RH side cowl trim panel and tighten the RH door sill plate retaining screws.
14. Install glove compartment door (06024) and check arms.
15. Connect vacuum supply hose to vacuum supply.
16. Install RH and LH lower instrument panel insulators.
17. Install two hush panels.
18. Unplug the heater core tubes and connect the heater water hoses to the heater core tubes.
19. Fill the cooling system with coolant to replace coolant lost during removal of the heater air plenum chamber.
20. Connect the battery ground cable. Refer to [Section 14-01](#).