

2000 Volkswagen Jetta V6-2.8L (AFP)

[Vehicle Level](#) → [Restraint Systems](#) → [Air Bag Systems](#) → [Air Bag](#) → [Service and Repair](#) → [Removal and Replacement](#) → [Drivers Side Airbag Unit](#) → [Driver Side Airbag Unit , Removing and Installing \(Four-Spoke Steering Wheel\)](#) ←

Driver Side Airbag Unit , Removing and Installing (Four-Spoke Steering Wheel)

[Notes](#)

Driver Side Airbag Unit, Removing And Installing (Four-spoke Steering Wheel)

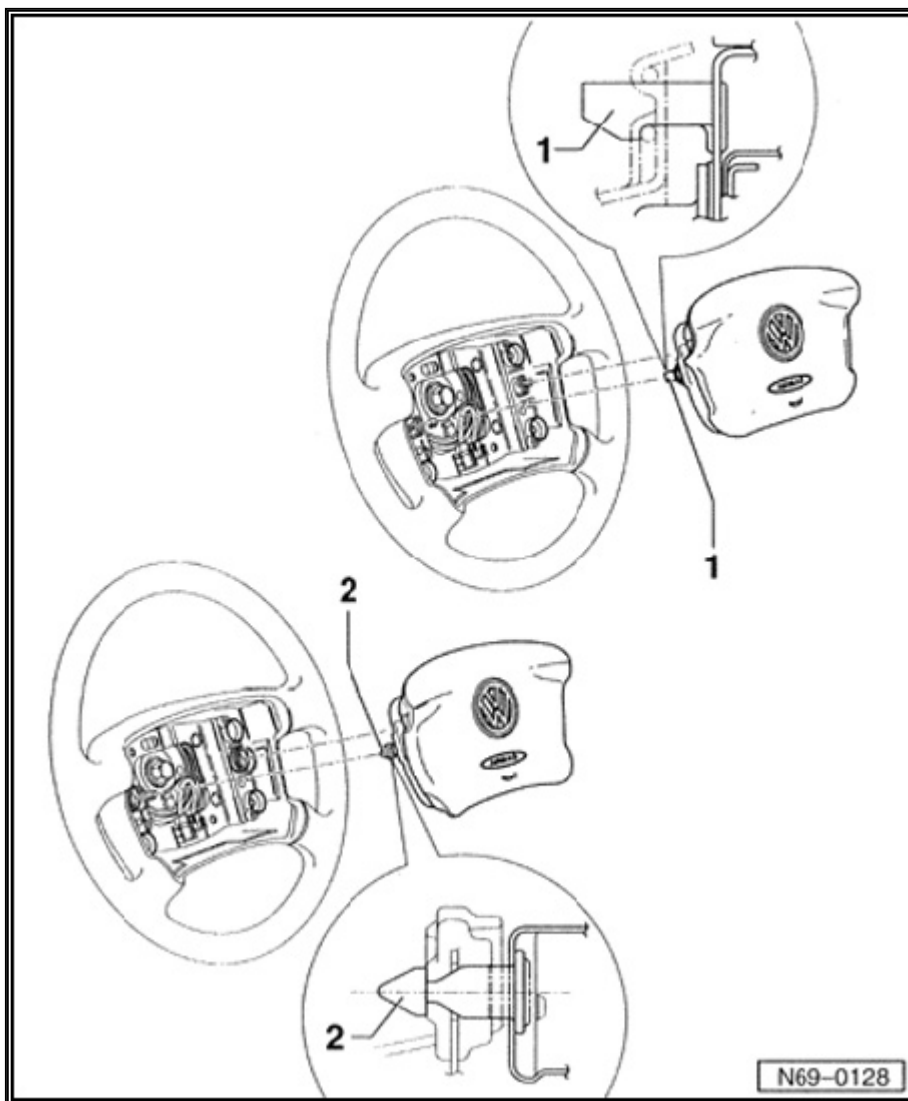

Zoom

Sized for Print

NOTE:

- There are two suppliers for four-spoke steering wheel with airbag unit. Petri secures airbag unit in steering wheel with a rectangular stud - 1 -. TRW secures airbag unit in steering wheel with a stepped pin - 2 -.
- Because of differing engaging mechanisms, only steering wheels and airbag units from same supplier can be installed.
- Always note component supplier when ordering replacement parts.

Removing

- Disconnect battery Ground (GND) strap.

CAUTION: Observe safety precautions for working on airbags.

- Release steering column adjustment.
- Turn steering wheel - 1 - until steering wheel spoke is in a vertical position. Pull out steering column entirely and push into lower position.
- Secure steering column adjustment.

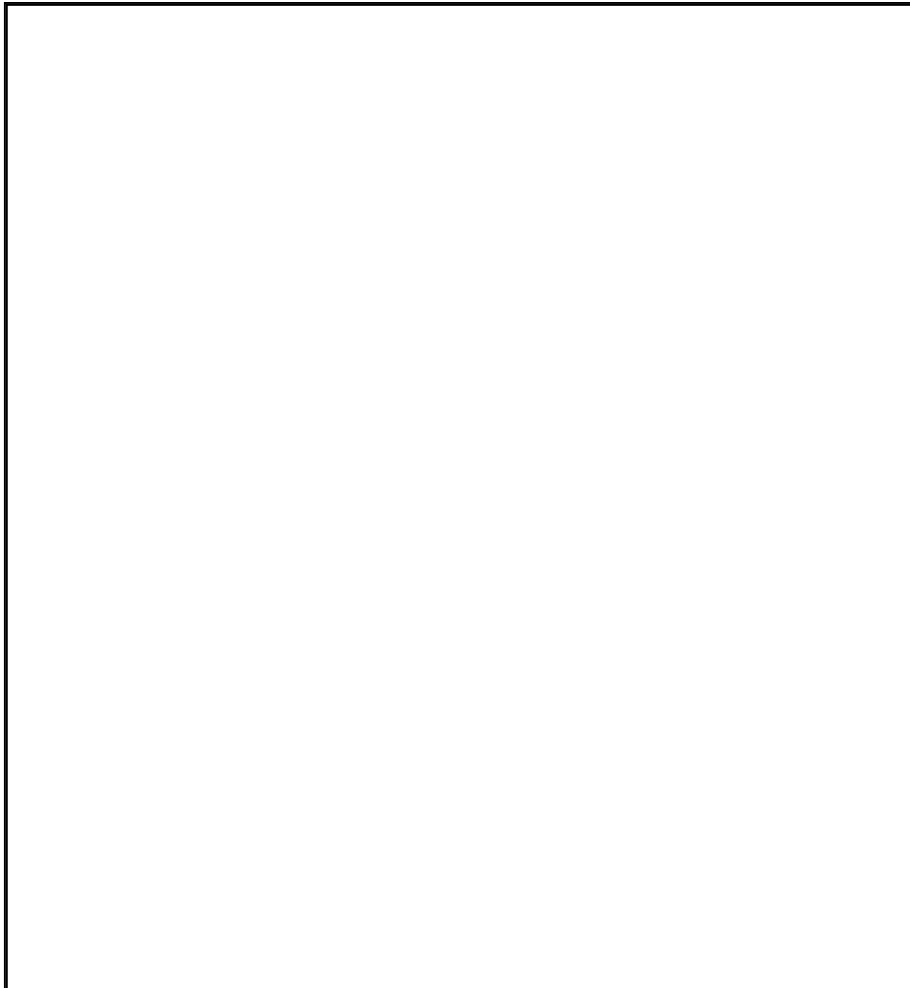

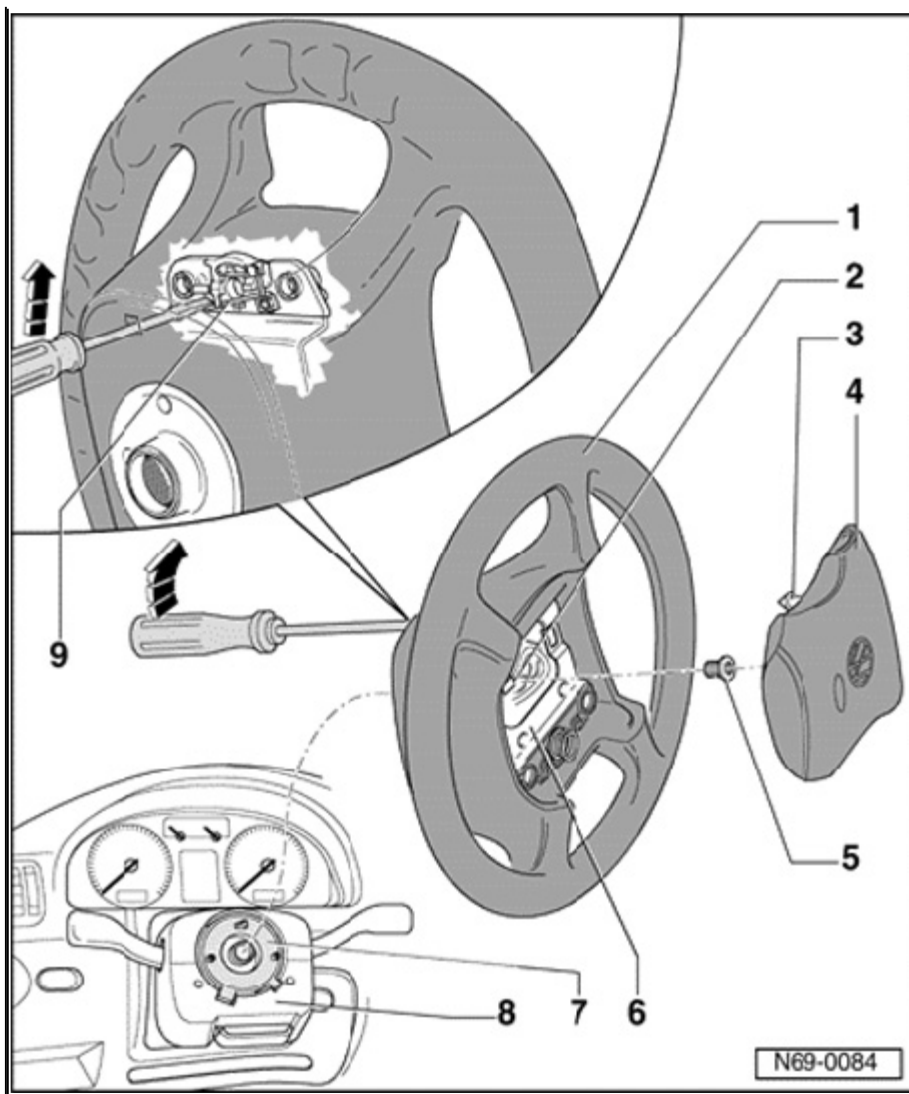

Zoom

Sized for Print

- Insert a screwdriver of **approx. 175 mm** length into bore of steering wheel pan from rear (insert screwdriver **approx. 45 mm**).



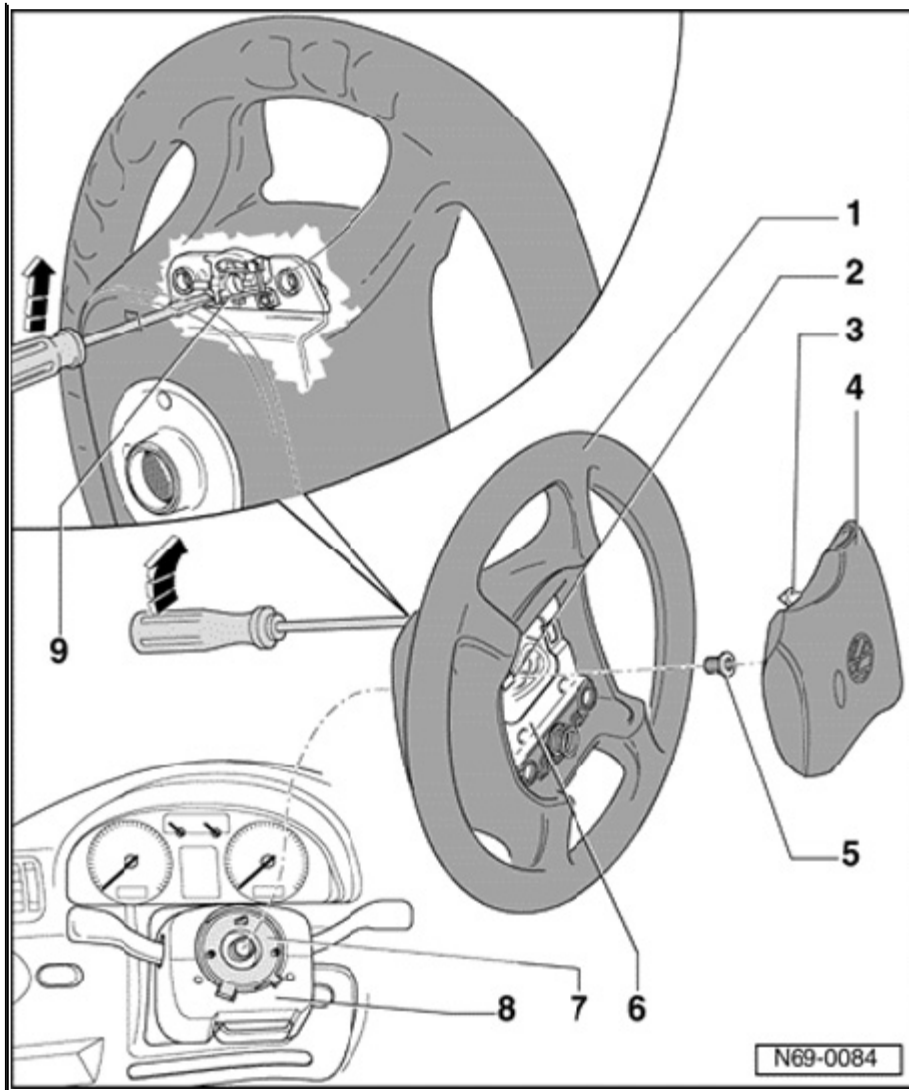

Zoom

Sized for Print

- Press screwdriver in direction of - arrow -. In this case, clamp - 10 - will be pressed back and catch - 3 - of airbag unit will reby release.
- Turn steering wheel back **180°** and disengage second catch on opposite side.
- Turn steering wheel - 1 - to center position (wheels in straight-ahead position).

CAUTION: Electrostatic charges may result in involuntary deployment of airbag. Therefore, mechanic must be electrostatically discharged before disconnecting ignition- and Ground (GND) wires. This is done e.g. by briefly grasping chassis or door striker.



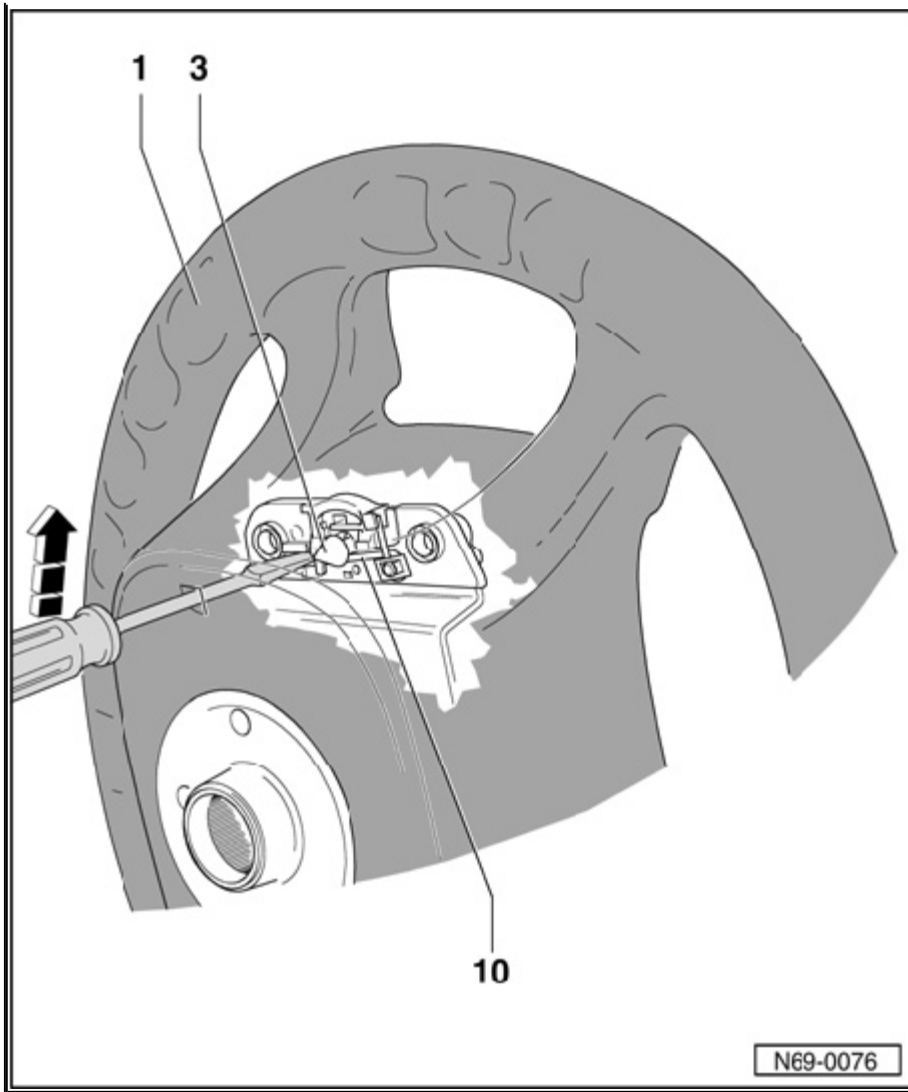

Zoom

Sized for Print

- Disconnect harness connector from airbag unit.



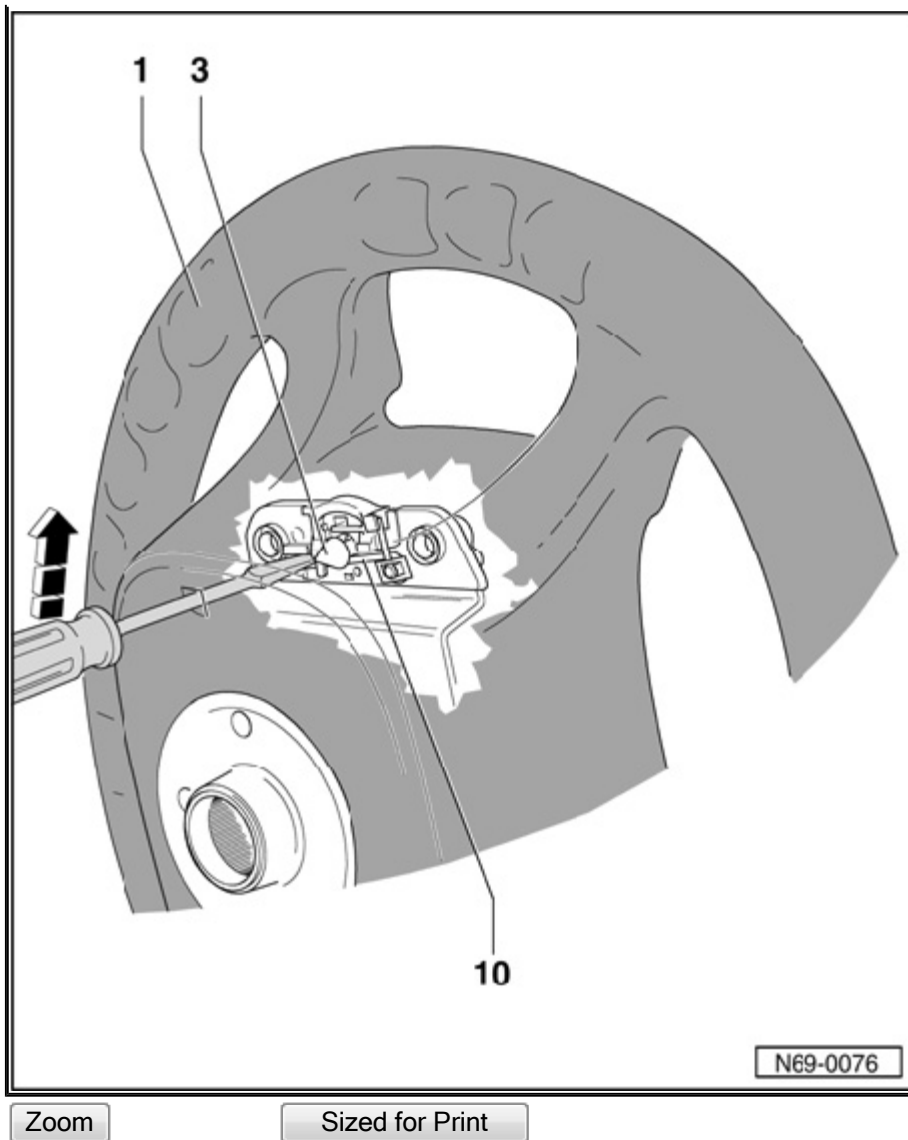

Zoom

Sized for Print

Installing

- Connect harness connector for airbag module to steering wheel pan and press airbag unit into steering wheel.

NOTE:

- Only steering wheels and airbag units of same manufacturer can be installed.
- Check where all catches for airbag unit are locked in steering wheel.
- Switch ignition on.

CAUTION: Make sure no one is in vehicle.

- Connect battery Ground (GND) strap.

NOTE: If engine Electronic Control Module (ECM) is subject to low voltage with ignition on, DTC memory and Readiness code must be checked.

© 2009 ALLDATA LLC. All rights reserved.
[Terms of Use](#)