

WHEEL HUB, BEARING, AND SEAL REPLACEMENT (4WD)

Tools Required

J 45859 Axle Remover

Removal Procedure

1. Raise and support the vehicle. Refer to [Lifting and Jacking the Vehicle](#) in General Information.
2. Remove the tire and wheel. Refer to [Tire and Wheel Removal and Installation](#) in Tires and Wheels.
3. Remove the rotor. Refer to [Brake Rotor Replacement - Front](#) in Disc Brakes.

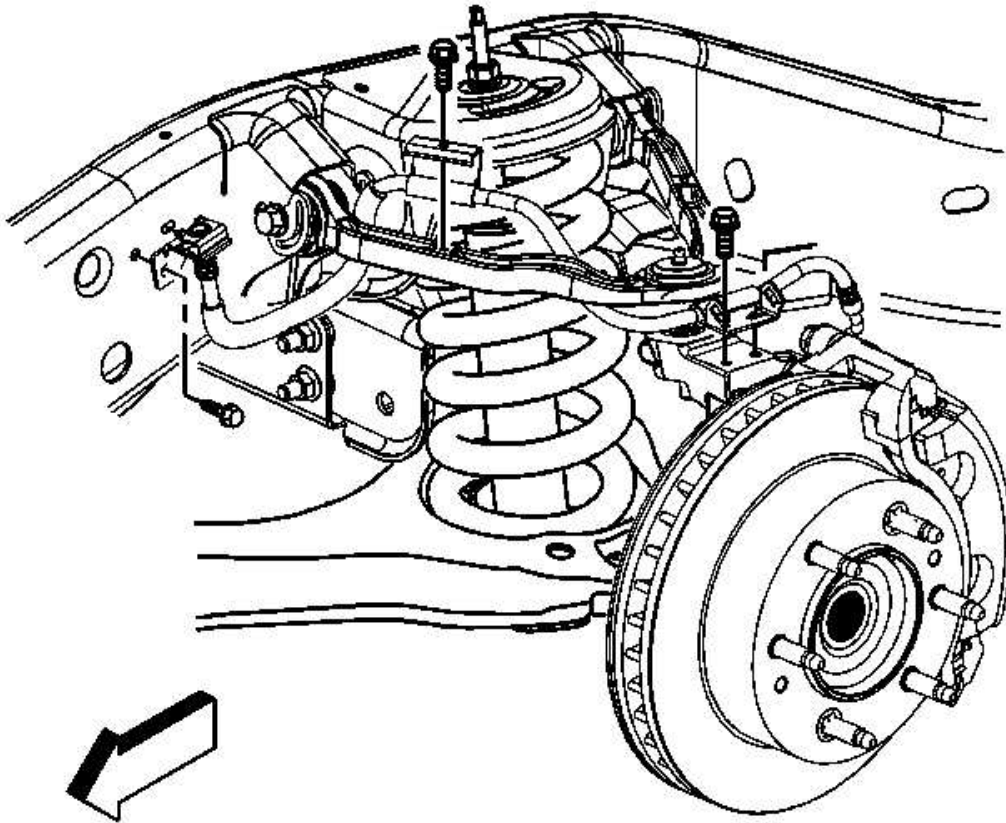

[Fig. 62: View Of Retaining Bolts For Brake Hose And Wheel Speed Sensor Brackets](#)
Courtesy of GENERAL MOTORS CORP.

4. Remove the wheel speed sensor and brake hose mounting bracket bolt from the steering knuckle.

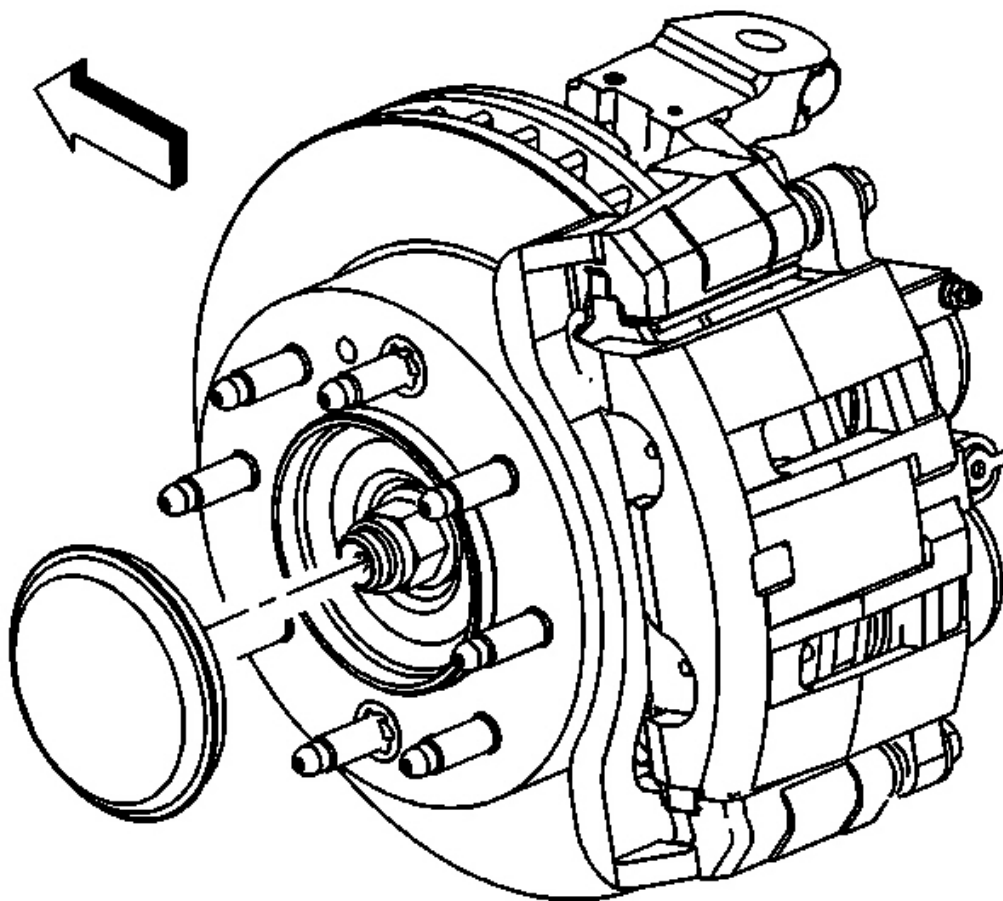

Fig. 63: Removing The Wheel Drive Shaft Nut Retaining Cover (4WD)
Courtesy of GENERAL MOTORS CORP.

5. Remove the wheel drive shaft nut retaining cover.

IMPORTANT: Do not reuse the nut. A new nut must be used when installing the wheel drive shaft.

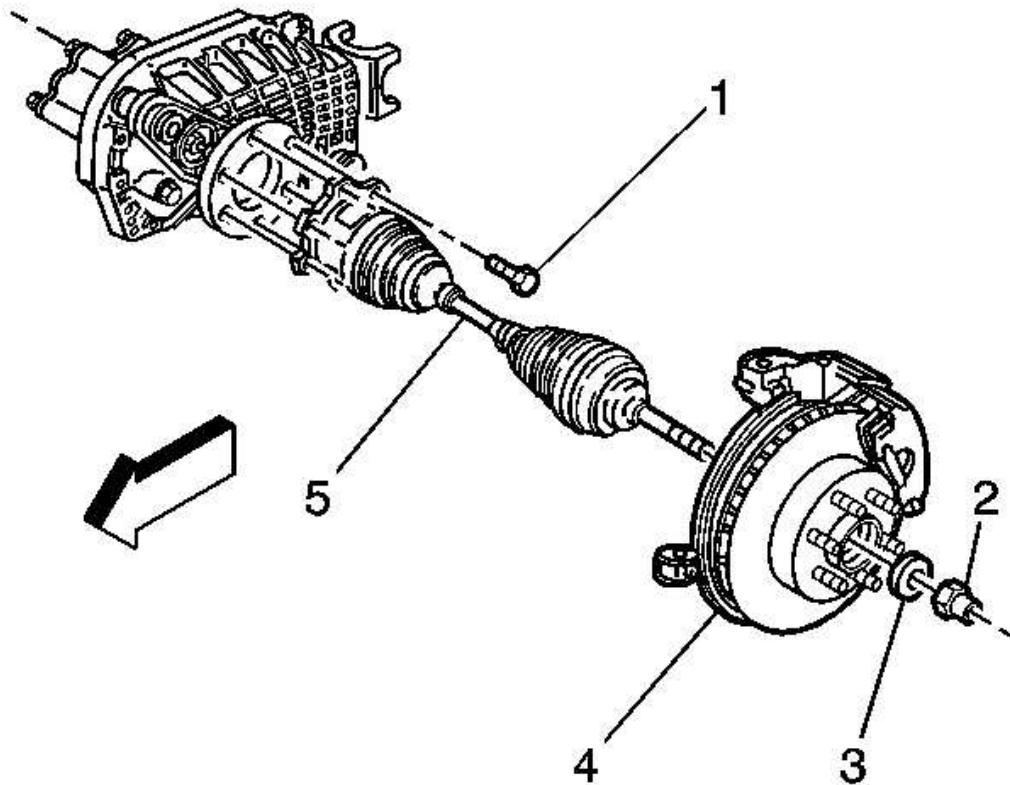

Fig. 64: Removing Wheel Driveshaft Assembly Retaining Nut And Washer (4WD)
Courtesy of GENERAL MOTORS CORP.

6. Remove the wheel driveshaft assembly retaining nut (2) and washer (3) from the wheel driveshaft.
7. Disengage the wheel drive shaft from the wheel hub and bearing using **J 45859** or equivalent.

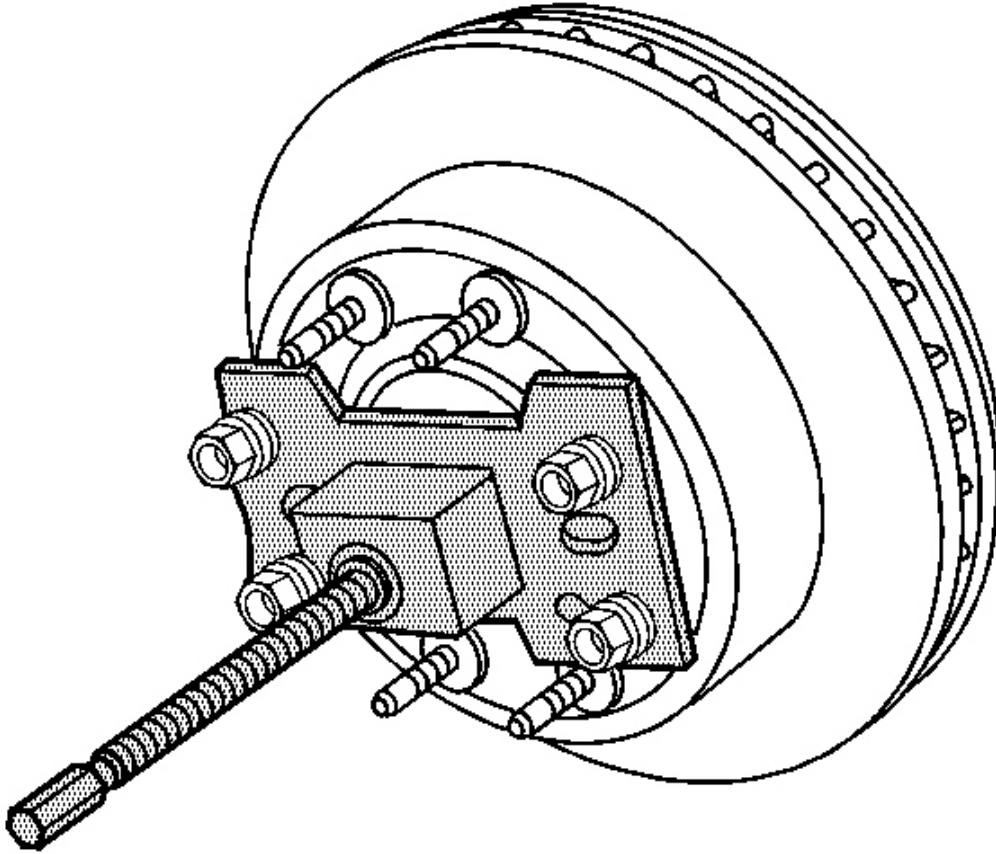

Fig. 65: Disengaging The Wheel Drive Shaft From The Wheel Hub And Bearing (4WD)
Courtesy of GENERAL MOTORS CORP.

8. Remove the wheel hub and the 15-series bearing mounting bolts (4).

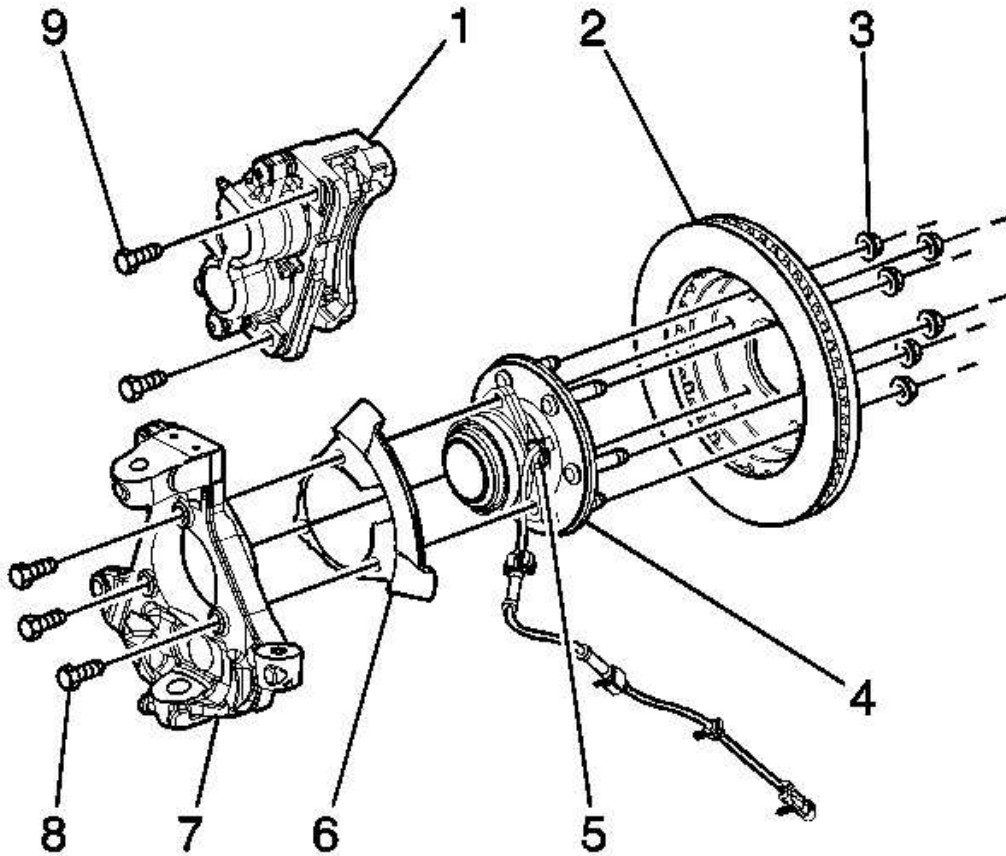

Fig. 66: Remove The Wheel Hub Mounting Bolts (4WD, 15-Series)
Courtesy of GENERAL MOTORS CORP.

9. Remove the wheel hub and bearing (4) mounting bolts, 25/35 series.

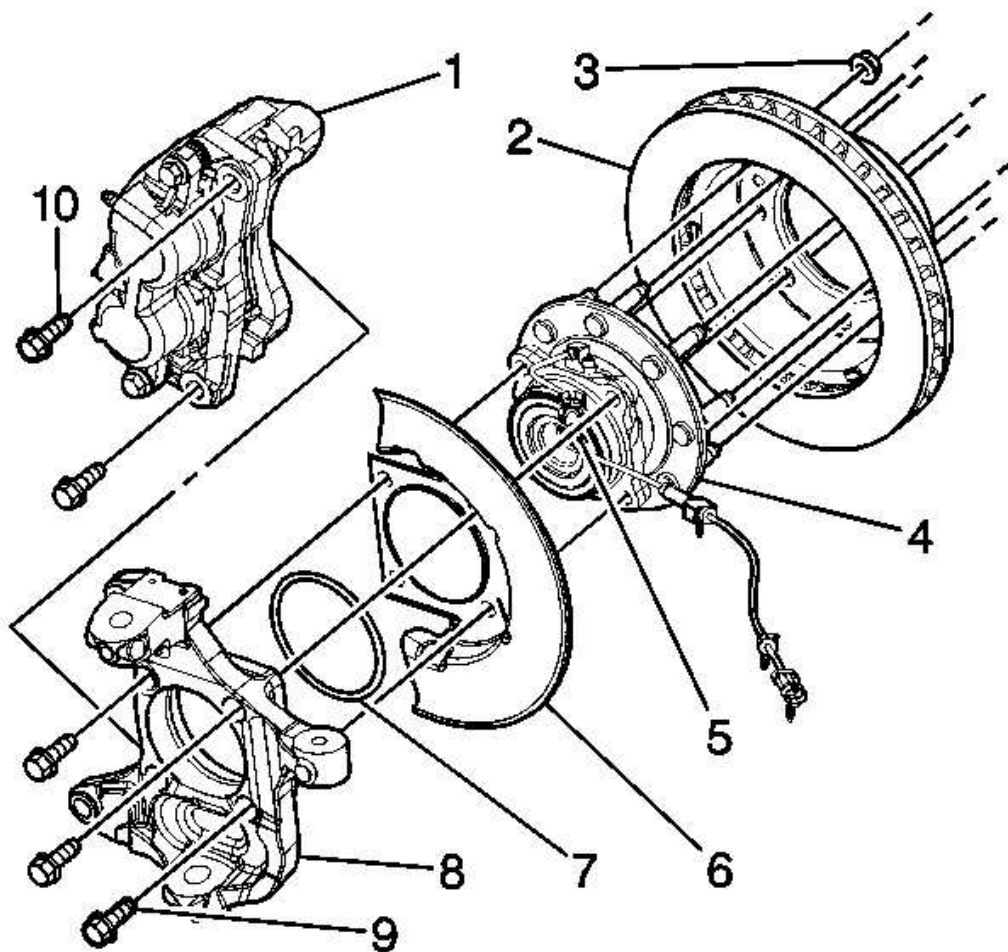

Fig. 67: Identifying Brake/Hub Components
 Courtesy of GENERAL MOTORS CORP.

10. Remove the wheel hub and bearing and splash shield from the vehicle.
11. Remove the O-ring seal from the steering knuckle bore, 25/35 series.
12. Remove the wheel speed sensor mounting bolt (5).
13. Clean and inspect the O-ring seal, 25/35 series.
14. Replace the seal if the following conditions exist:
 - Nicks
 - Cuts
 - Dry or brittle

- Compression set

Installation Procedure

1. Clean all corrosion or contaminants from the steering knuckle bore and the hub and bearing assembly.
2. Lubricate the steering knuckle bore with wheel bearing grease or the equivalent.

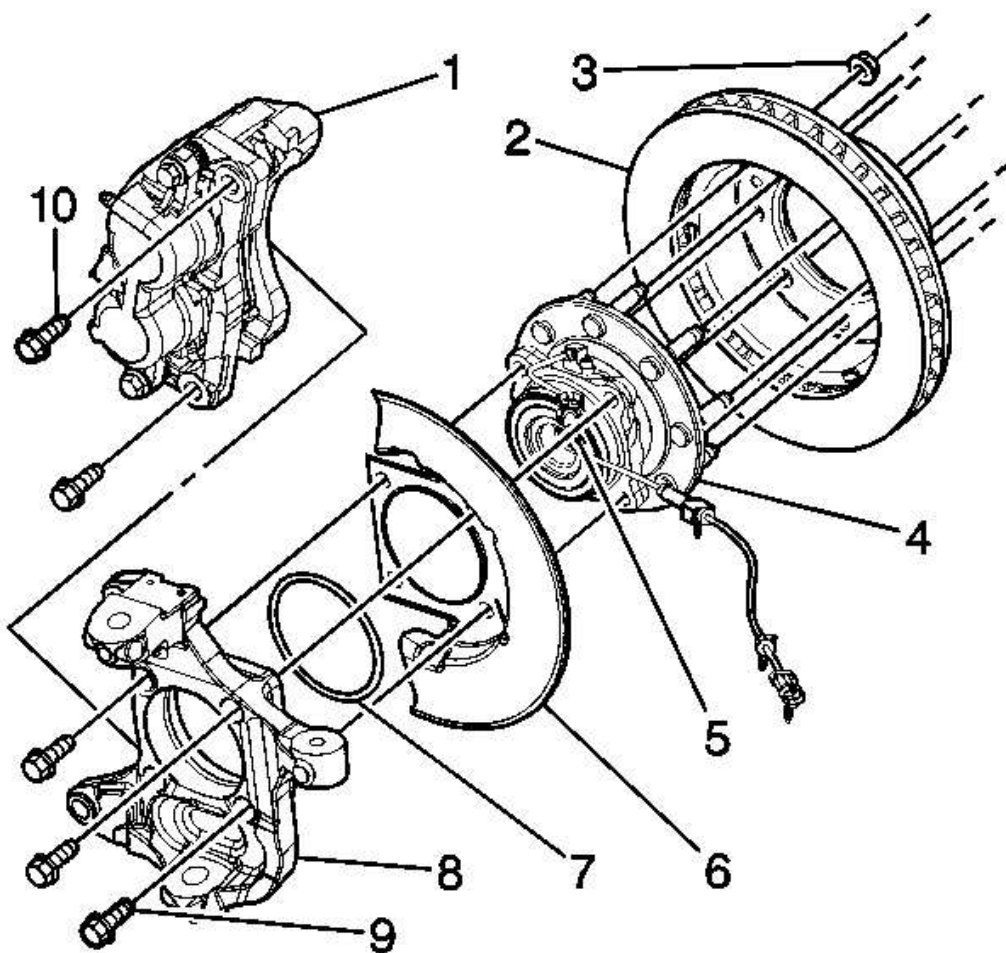

Fig. 68: Identifying Brake/Hub Components
Courtesy of GENERAL MOTORS CORP.

3. Install the O-ring (7) to the steering knuckle, the 25/35 series.

NOTE: Refer to Fastener Notice in Cautions and Notices.

4. Install the wheel speed sensor mounting bolt to the wheel hub and bearing.

Tighten: Tighten the sensor mounting bolt to 18 N.m (13 lb ft).

5. Install the wheel hub and bearing and splash shield to the vehicle, 25/35 series.

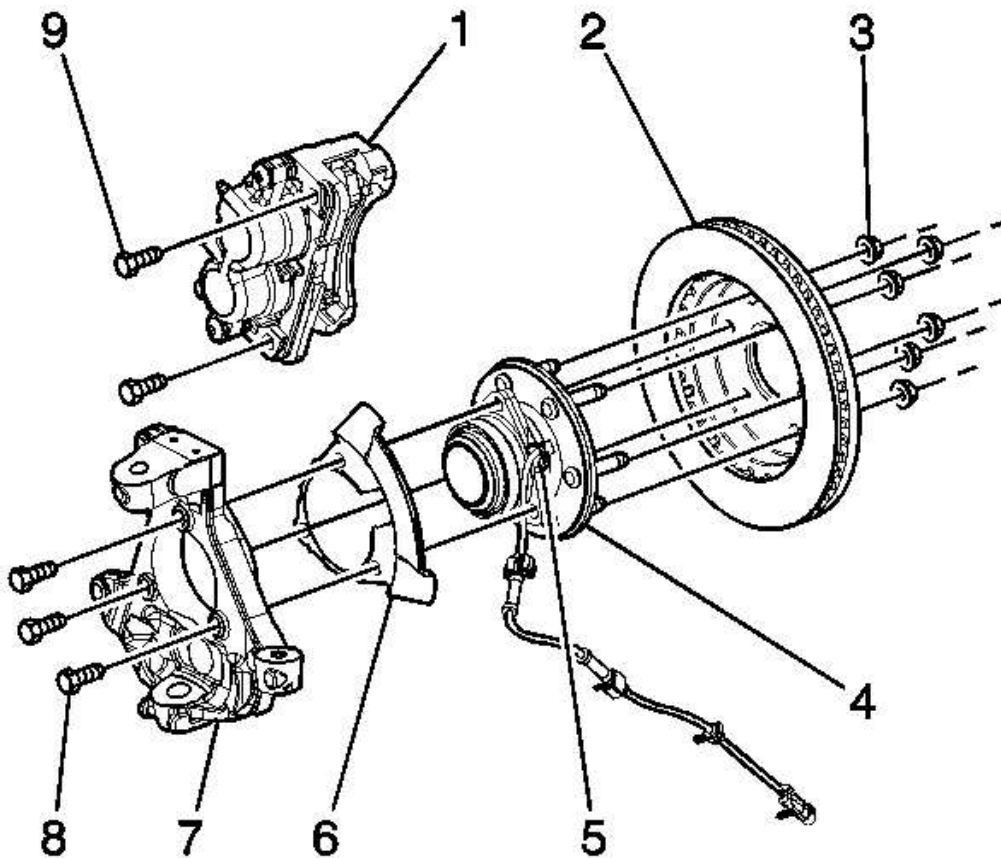

Fig. 69: Install The Wheel Hub And Bearing And Splash Shield (4WD, 15 Series)
Courtesy of GENERAL MOTORS CORP.

6. Install the wheel hub and bearing (5) and splash shield (6) to the vehicle, 15 series.
7. Install the wheel hub and bearing mounting bolts, the 15 series.
8. Install the wheel hub and bearing mounting bolts, 25/35 series.

Tighten: Tighten the wheel hub to knuckle bolts to 180 N.m (133 lb ft).

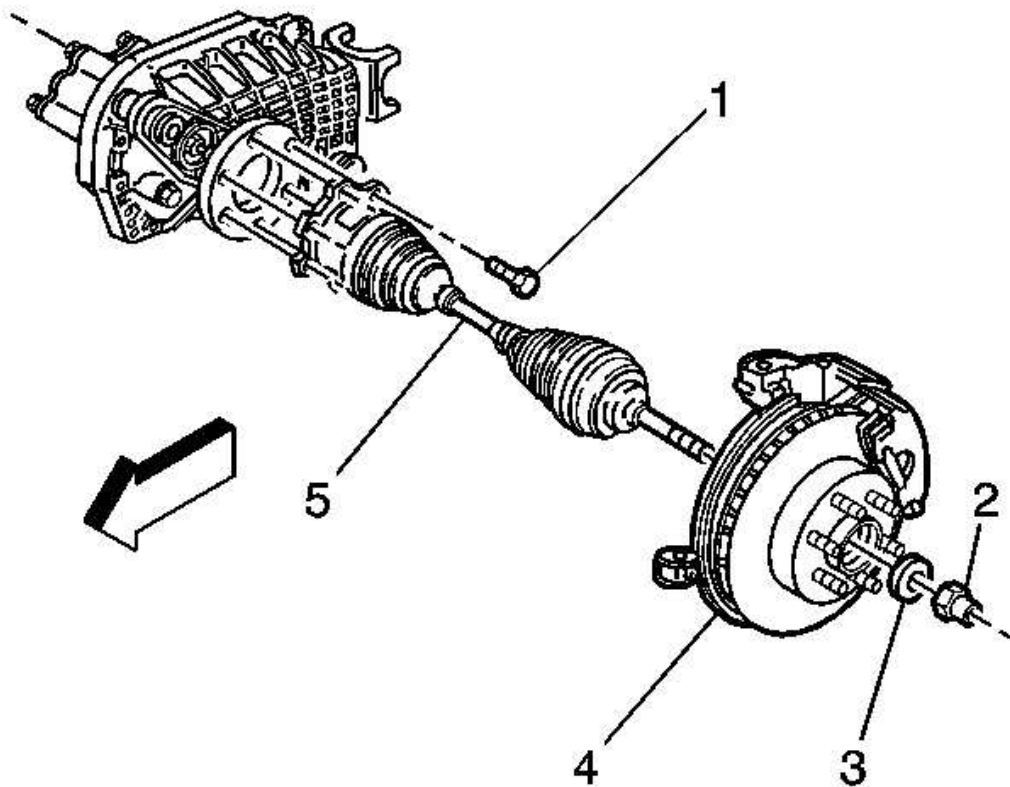
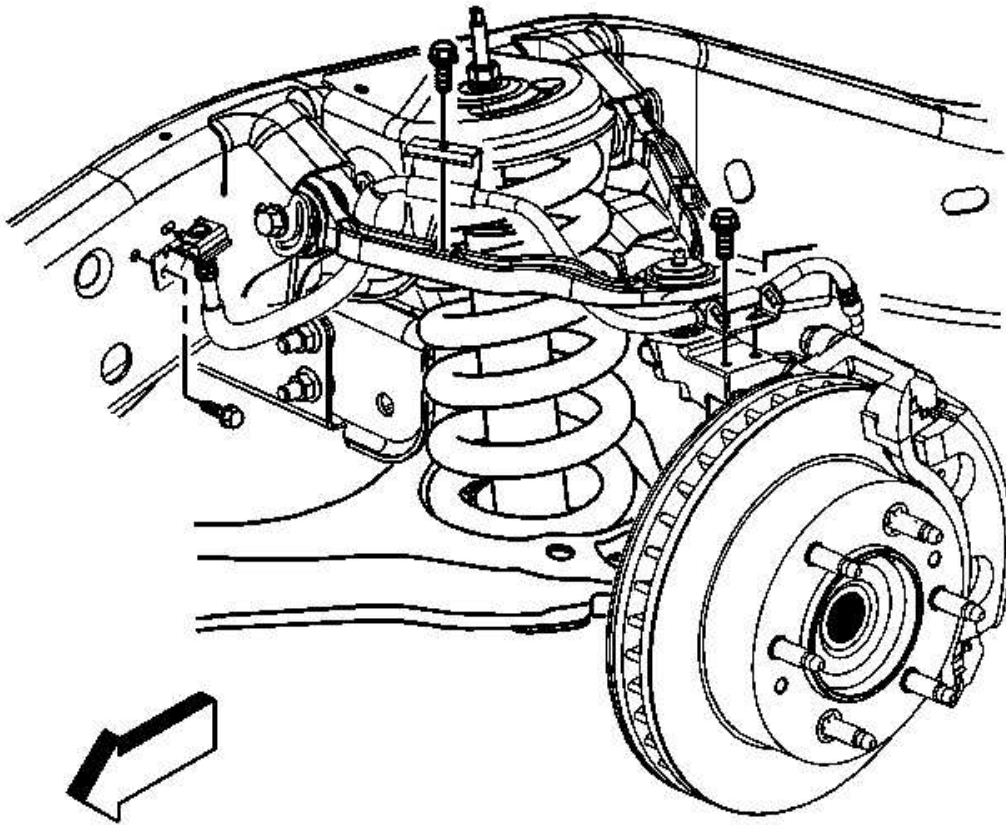

Fig. 70: Installing Nut And Washer Retaining The Wheel Drive Shaft Assembly To The Wheel Hub And Bearing (4WD)

Courtesy of GENERAL MOTORS CORP.

9. Install the nut (2) and washer (3) retaining the wheel drive shaft assembly to the wheel hub and bearing.

Tighten: Tighten the nut to 240 N.m (177 lb ft).



[Fig. 71: View Of Retaining Bolts For Brake Hose And Wheel Speed Sensor Brackets](#)
Courtesy of GENERAL MOTORS CORP.

10. Install the wheel speed sensor and brake hose mounting bracket bolt to the steering knuckle.

Tighten: Tighten the brake hose clip bolt to 12 N.m (106 lb in).

11. Install the rotor. Refer to [Brake Rotor Replacement - Front](#) in Disc Brakes.
12. Install the tire and wheel. Refer to [Tire and Wheel Removal and Installation](#) in Tires and Wheels.
13. Lower the vehicle.