

## FRONT WHEEL BEARINGS

### Dana 35-IFS & Automatic Locking Hubs

1. Raise and support vehicle. Remove front wheel assemblies. Remove retaining washers from wheel lug nut studs. See **Fig. 1**.
2. Remove automatic locking hub assemblies. Remove snap ring and axle shaft spacer. Carefully pull plastic cam assembly from bearing adjusting nut. Remove 2 plastic thrust washers from adjusting nut.

**CAUTION: Before removing adjusting nut, remove locking key from spindle keyway. Failure to clear keyway will result in thread damage on spindle.**

3. Using magnet, remove locking key from spindle keyway. It may be necessary to rotate adjusting nut slightly to relieve pressure for locking key removal. Loosen adjusting nut with 2 3/8" Hex Socket (T70T-4252-B).
4. Tighten adjusting nut to 35 ft. lbs. (47 N.m) while turning hub back and forth to seat bearings. Spin hub and back off adjusting nut 90 degrees. Retighten adjusting nut to 16 INCH lbs. (1.8 N.m).
5. Align nearest hole in adjusting nut with center of spindle keyway slot. If necessary, advance nut to next lug. Install locking key in spindle keyway under adjusting nut. Install 2 thrust washers. Press plastic cam assembly onto adjusting nut while lining up key in fixed cam with spindle keyway.
6. Install axle shaft spacer. Clip snap ring onto end of spindle. Install automatic locking hub assembly with 3 legs of hub assembly inserted into 3 pockets of cam assembly. Install retaining washers and wheel assembly. Check hub and rotor assembly end play. End play should be 0-.003" (0-.08 mm).

# 1994 Ford Explorer

## LOCKING HUBS 1994 Drive Axles - Locking Hubs

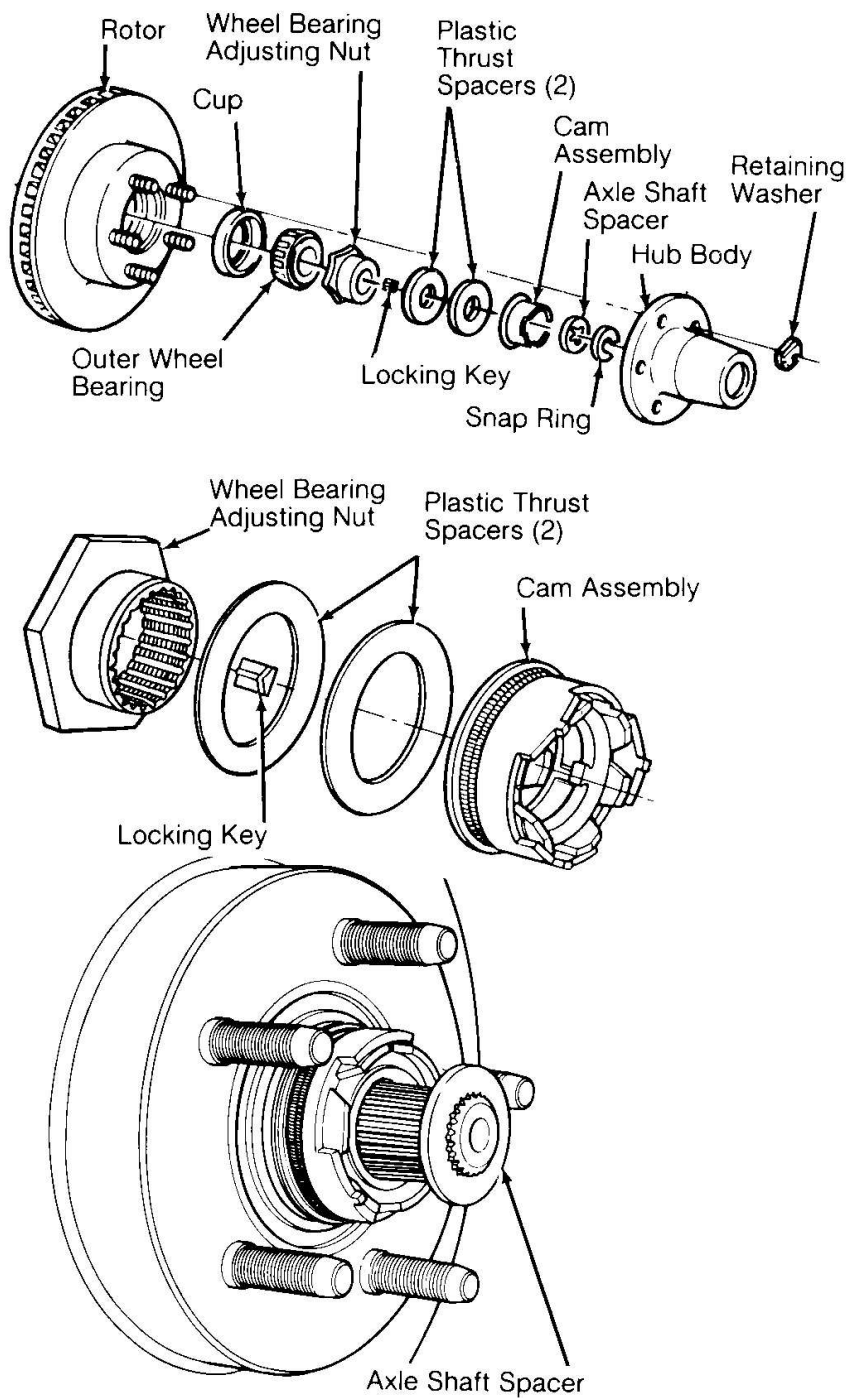

90114934

**Fig. 1: Exploded View Of Automatic Locking Hub (Explorer & Ranger)**  
Courtesy of FORD MOTOR CO.

### Dana 35-IFS & Manual Locking Hubs

many waters gallery

Tuesday, October 07, 2008 12:57:12 PM

Page 2

© 2005 Mitchell Repair Information Company, LLC.

## 1994 Ford Explorer

### LOCKING HUBS 1994 Drive Axles - Locking Hubs

1. Raise and support vehicle. Remove front wheels. Remove retaining washers from wheel lug nut studs. See **Fig. 2** . Remove manual locking hub assemblies.
2. Remove snap ring and axle shaft spacer from spindle. Remove outer bearing lock nut using Spanner Lock Nut Wrench (T86T-1197-B). Remove lock nut washer from spindle. Using spanner wrench, loosen inner wheel bearing lock nut.
3. It may be necessary to rotate adjusting nut slightly to relieve pressure for locking key removal. Loosen adjusting nut with 2 3/8" Hex Socket (T70T-4252-B). Tighten adjusting nut to 35 ft. lbs. (47 N.m) while turning hub back and forth to seat bearings.
4. Spin hub and back off adjusting nut 90 degrees. Install lock washer on spindle. Mount lock washer over pin on adjusting nut, turning nut slightly if necessary to align pin. Install and tighten outer lock nut to 150 ft. lbs. (203 N.m) using spanner lock nut wrench.
5. Install axle shaft spacer. Install snap ring on end of spindle. Install manual hub assembly. Install retaining washers and wheel assembly. Check hub and rotor assembly end play. End play should be 0-.003" (0-.08 mm).

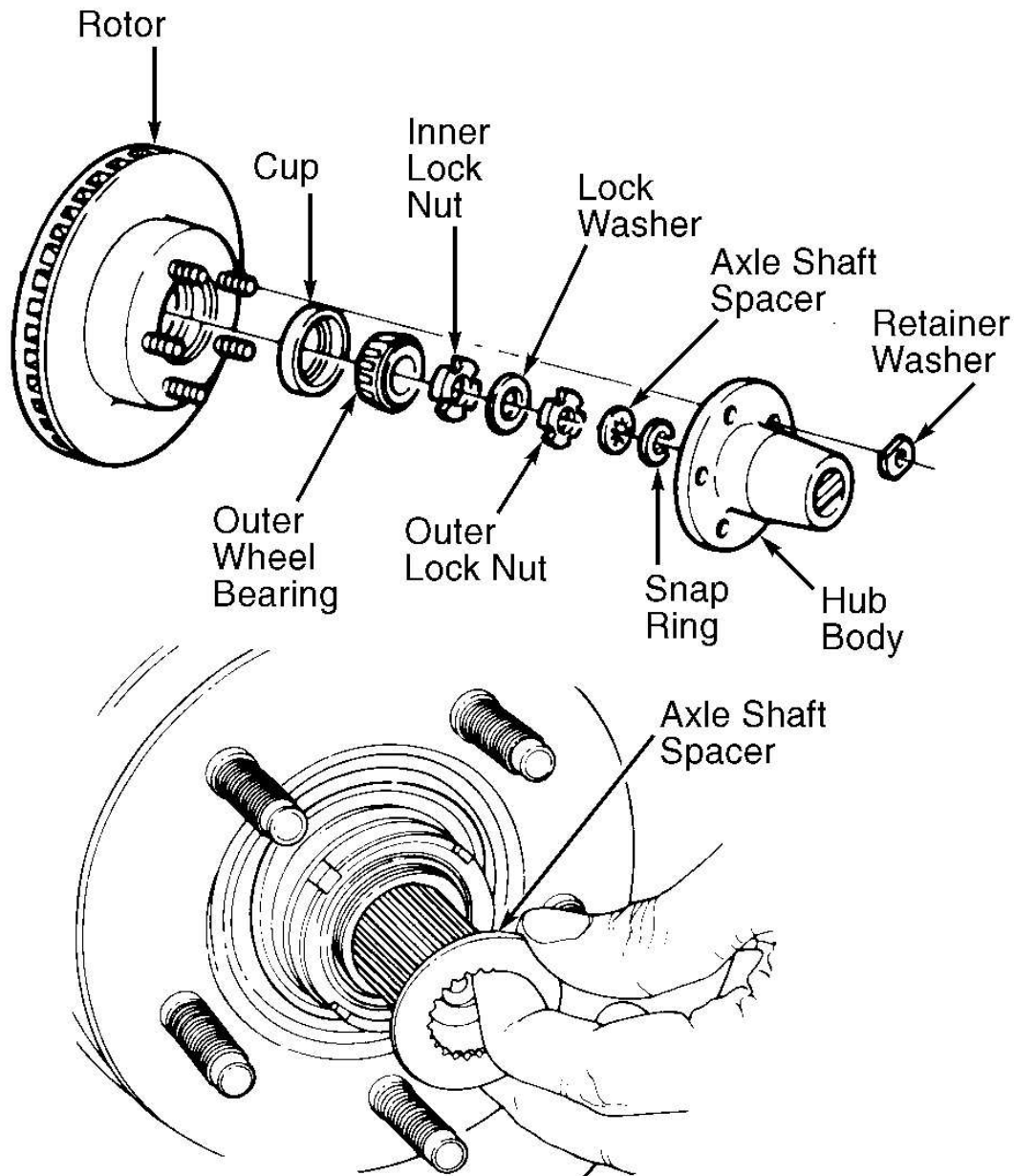

90A14936

**Fig. 2: Exploded View Of Manual Locking Hubs (Explorer & Ranger)**  
Courtesy of FORD MOTOR CO.

## REMOVAL & INSTALLATION

### AUTOMATIC LOCKING HUBS

## 1994 Ford Explorer

### LOCKING HUBS 1994 Drive Axles - Locking Hubs

#### Removal & Installation

To remove and install automatic locking hub assembly, see DANA 35-IFS & AUTOMATIC LOCKING HUBS procedure under ADJUSTMENTS.

#### MANUAL LOCKING HUBS

##### Removal

1. Raise and support vehicle. Remove wheel assembly. Remove retainer washers from lug nut studs and remove locking hub body assembly.
2. To remove internal hub lock assembly from locking hub body assembly, remove outer lock ring seated in hub body groove. Internal assembly, spring and clutch gear will now slide out of hub body. **DO NOT** remove screw from plastic dial. Reassemble hub assembly in reverse order of disassembly.

##### Installation

Install reassembled manual locking hub body assembly on spindle. Install retainer washers and wheel. Torque wheel lug nuts to specification