

VALVE BODIES

Disassembly

1. Thoroughly clean and air dry valve bodies. Remove check balls. Remove each valve train.
2. Lay valves, springs and bushings on a clean surface in the order removed. Remove solenoids, sensor, screens, servos and accumulator assemblies.

Cleaning & Inspection

Clean valves, springs and bushings in solvent. NEVER use shop rags to clean valve body components. Inspect valves and bushings for scoring, nicks and scratches. Inspect springs for damaged or distorted coils. Inspect valve body casting for porosity, interconnected oil passages and damaged machined surfaces.

Reassembly

Reassemble valve body assemblies. See [Fig. 26 -Fig. 28](#) . Using Guide Pins (J-39630-1 and J-39068-2), assemble lower valve body to channel plate. See [Fig. 29 -Fig. 31](#) . Ensure NEW pressure control solenoid filter and oil pressure screen is used. After assembly, ensure all valves move freely in respective bores.

NOTE: **Install oil pressure switch assembly to lower valve body. Illustration of oil pressure switch assembly is not available.**

1995 Cadillac Eldorado

1995-96 AUTOMATIC TRANSMISSIONS General Motors Corp. Hydra-Matic 4T80-E Overhaul

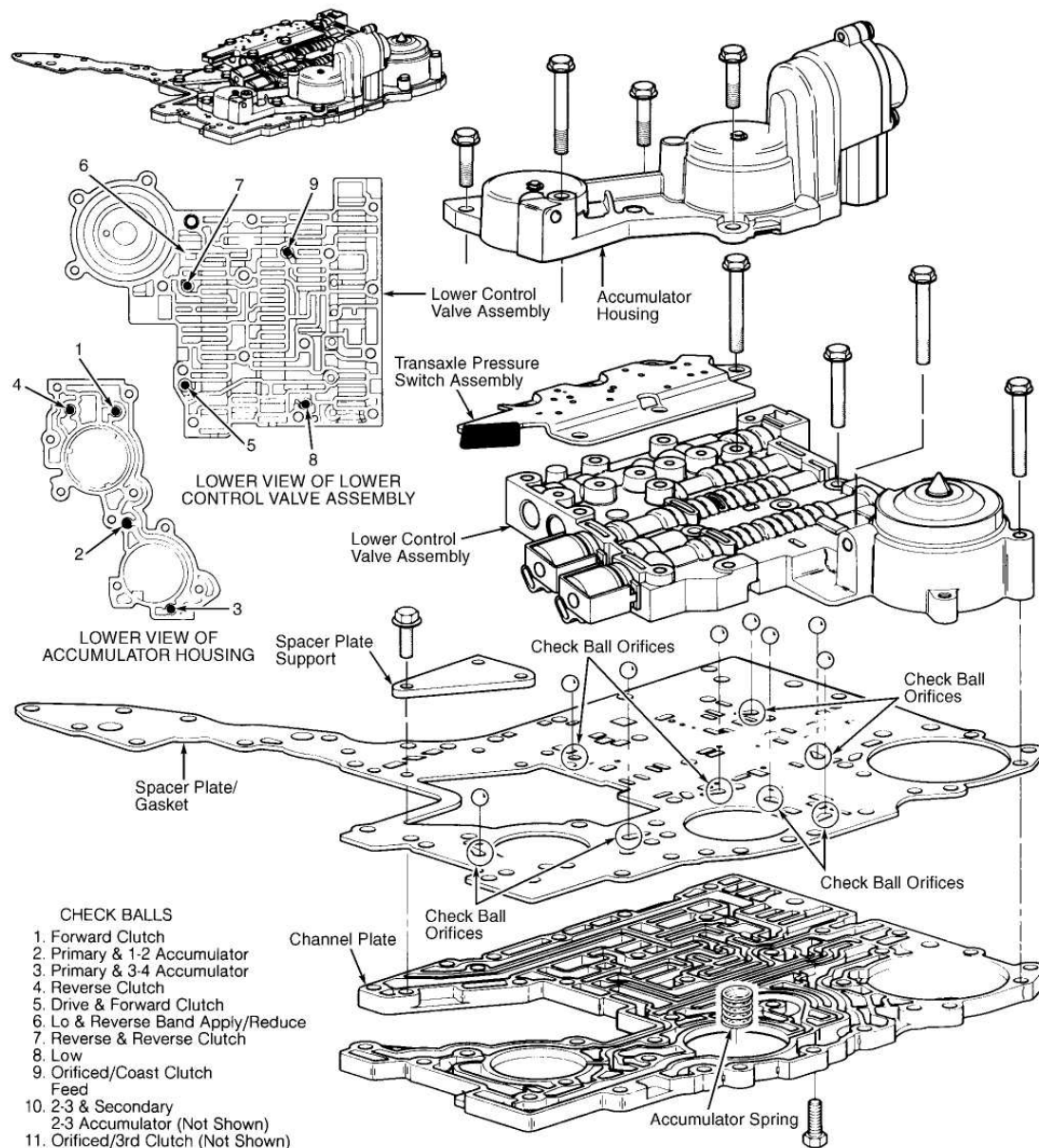

G94J38314

Fig. 26: Exploded View Of Lower Channel, Spacer & Valve Body Assembly
 Courtesy of GENERAL MOTORS CORP.

LEGEND FOR FIGURE 26

Item No.	Component
1	Forward Clutch
2	Primary & 1-2 Accumulator
3	Primary & 3-4 Accumulator
4	Reverse Clutch

many waters gallery

Saturday, October 04, 2008 2:14:18 PM

Page 2

© 2005 Mitchell Repair Information Company, LLC.

1995 Cadillac Eldorado

1995-96 AUTOMATIC TRANSMISSIONS General Motors Corp. Hydra-Matic 4T80-E Overhaul

5	Drive & Forward Clutch
6	Lo & Reverse Band Apply/Reduce
7	Reverse & Reverse Clutch
8	Lo
9	Orificed/Coast Clutch Feed (Not Shown)
10	2-3 & Secondary, 2-3 Accumulator (Not Shown)
11	Orificed/3rd Clutch (Not Shown)

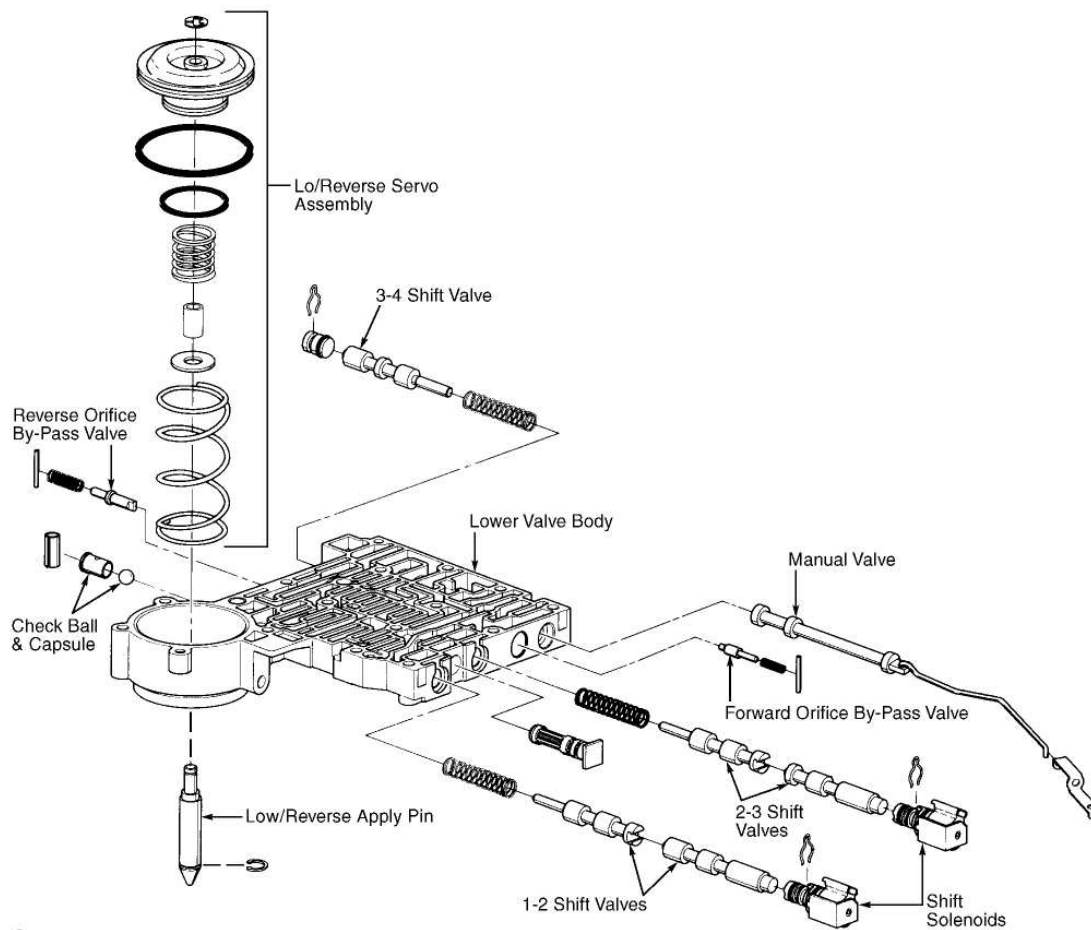
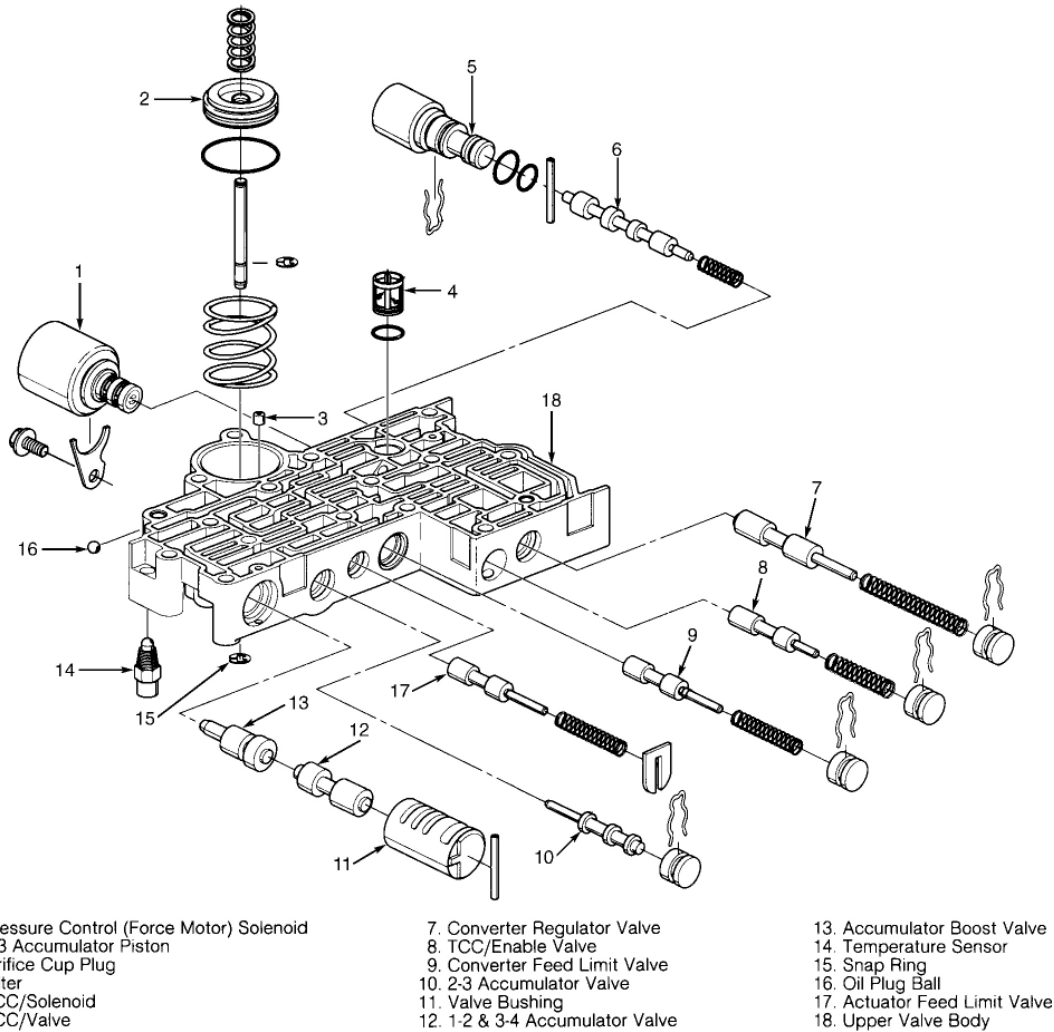

Fig. 27: Exploded View Of Lo/Reverse Servo & Lower Valve Body Assembly
 Courtesy of GENERAL MOTORS CORP.

1995 Cadillac Eldorado

1995-96 AUTOMATIC TRANSMISSIONS General Motors Corp. Hydra-Matic 4T80-E Overhaul



- 1. Pressure Control (Force Motor) Solenoid
- 2. 2-3 Accumulator Piston
- 3. Orifice Cup Plug
- 4. Filter
- 5. TCC/Solenoid
- 6. TCC/Valve

- 7. Converter Regulator Valve
- 8. TCC/Enable Valve
- 9. Converter Feed Limit Valve
- 10. 2-3 Accumulator Valve
- 11. Valve Bushing
- 12. 1-2 & 3-4 Accumulator Valve

- 13. Accumulator Boost Valve
- 14. Temperature Sensor
- 15. Snap Ring
- 16. Oil Plug Ball
- 17. Actuator Feed Limit Valve
- 18. Upper Valve Body

G99E03581

Fig. 28: Exploded View Of Upper Valve Body Assembly
 Courtesy of GENERAL MOTORS CORP.

LEGEND FOR FIGURE 28

Item No.	Component
1	Pressure Control (Force Motor) Solenoid
2	2-3 Accumulator Piston
3	Orifice Cup Plug
4	Filter
5	TCC/VCC Solenoid
6	TCC/VCC Valve
7	Converter Regulator Valve
8	TCC/VCC Enable Valve

many waters gallery

1995 Cadillac Eldorado

1995-96 AUTOMATIC TRANSMISSIONS General Motors Corp. Hydra-Matic 4T80-E Overhaul

9	Converter Feed Limit Valve
10	2-3 Accumulator Valve
11	Valve Bushing
12	1-2 & 3-4 Accumulator Valve
13	Accumulator Boost Valve
14	Temperature Sensor
15	Snap Ring
16	Oil Plug Ball
17	Actuator Feed Limit Valve
18	Upper Valve Body

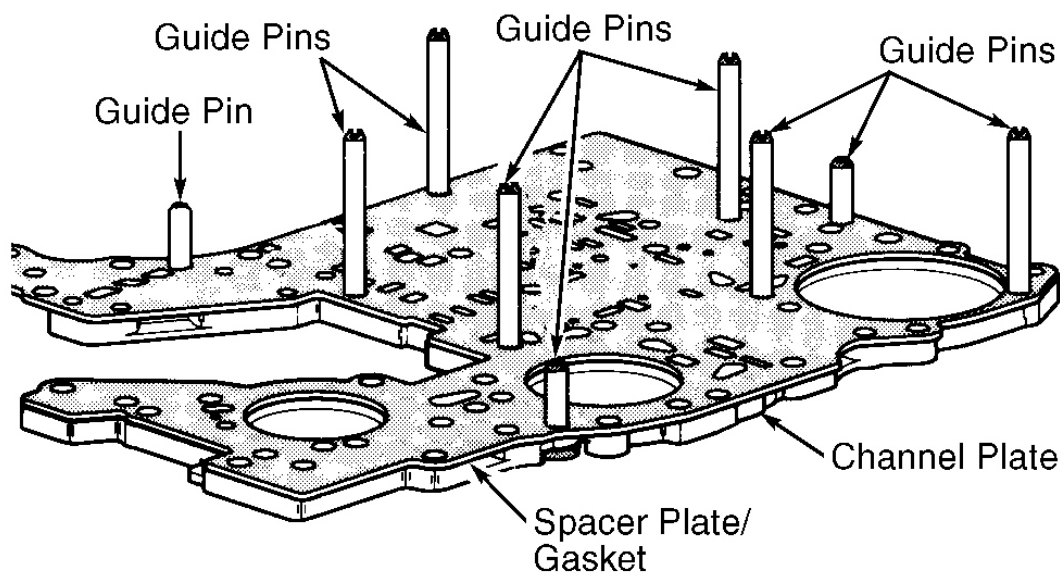

G94C38317

Fig. 29: Aligning Channel Plate & Gasket
 Courtesy of GENERAL MOTORS CORP.

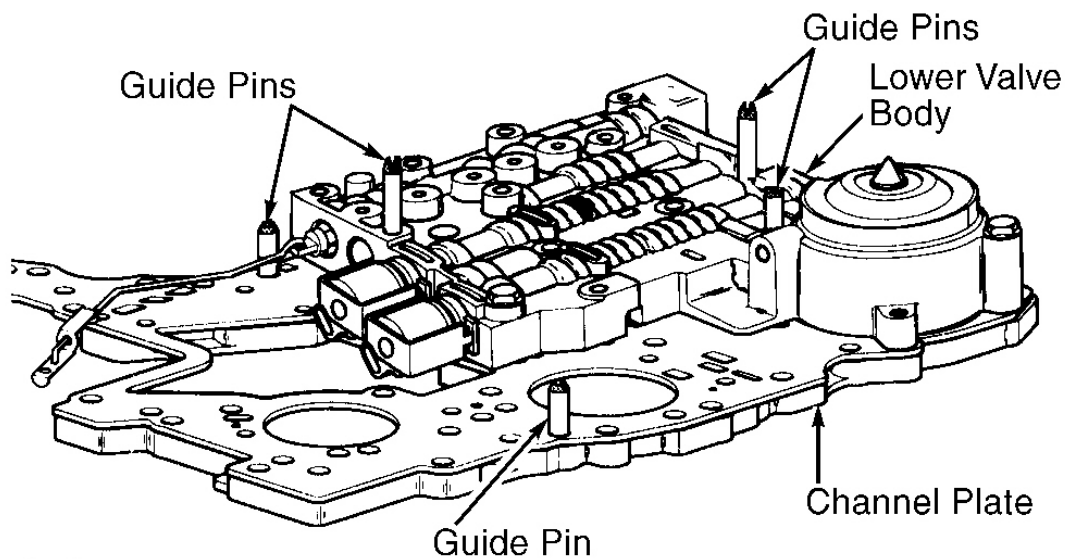

G94D38318

Fig. 30: Aligning Lower Valve Body & Channel Plate

Courtesy of GENERAL MOTORS CORP.

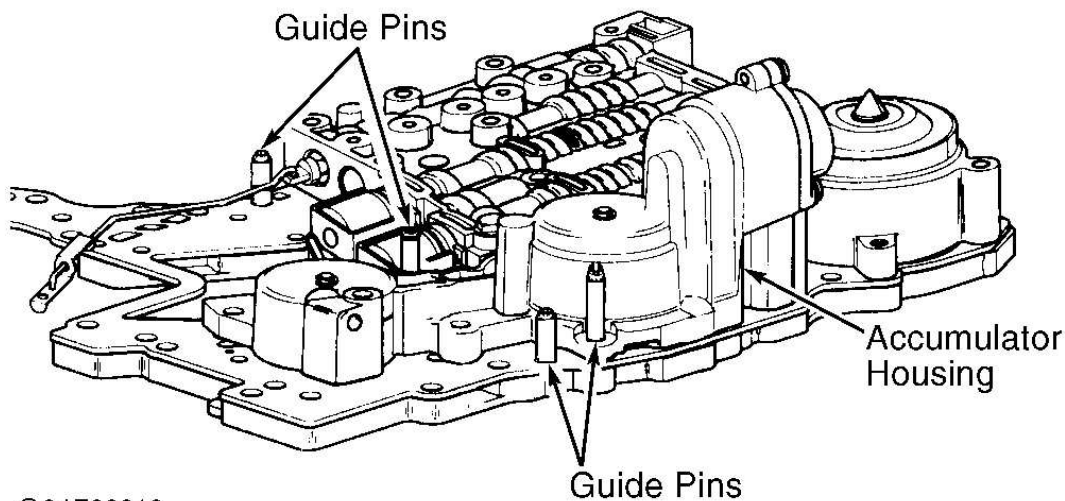

G94E38319

Fig. 31: Aligning Accumulator Assembly

Courtesy of GENERAL MOTORS CORP.