

GEAR SELECTION

The XJ incorporates a new design of transmission selector mechanism with:

- Improved setting procedure
- New design of gearshift interlock mechanism
- New design of key interlock mechanism
- Reduction in component weight

2004 MY XJ Transmission Selector Mechanism

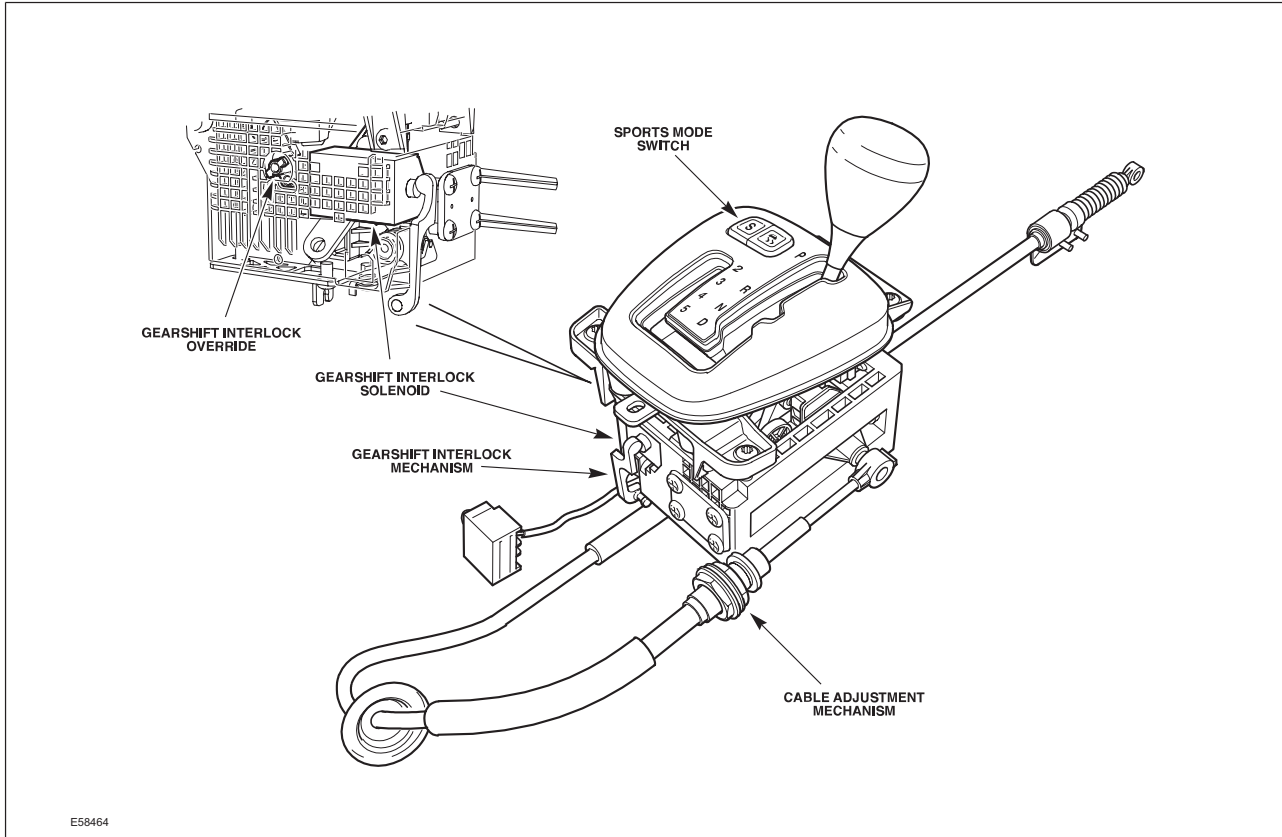

J-Gate

The J-gate is designed to allow both automatic and manual forward gear selection. On the right side of the J-gate, the gearshift lever position is sensed by the Gear Position Switch, which is linked to the lever by the shift cable. The TCM interprets the Gear Position Switch and transmits the selected gear position via CAN to illuminate the appropriate gear position LED on the J-gate.

The manual gear selection mode is activated by moving the gearshift lever to the left side of the J-gate. The shift cable does not change in manual mode. Manual gearshift

lever position is sensed by Hall-effect switches within the J-gate and transmitted by the J-vate via CAN to the TCM.