

Headliner  [Printable View \(375 KB\)](#)

Explorer/Mountaineer

NOTE: Headliner with roof opening panel shown, headliner without opening panel similar.

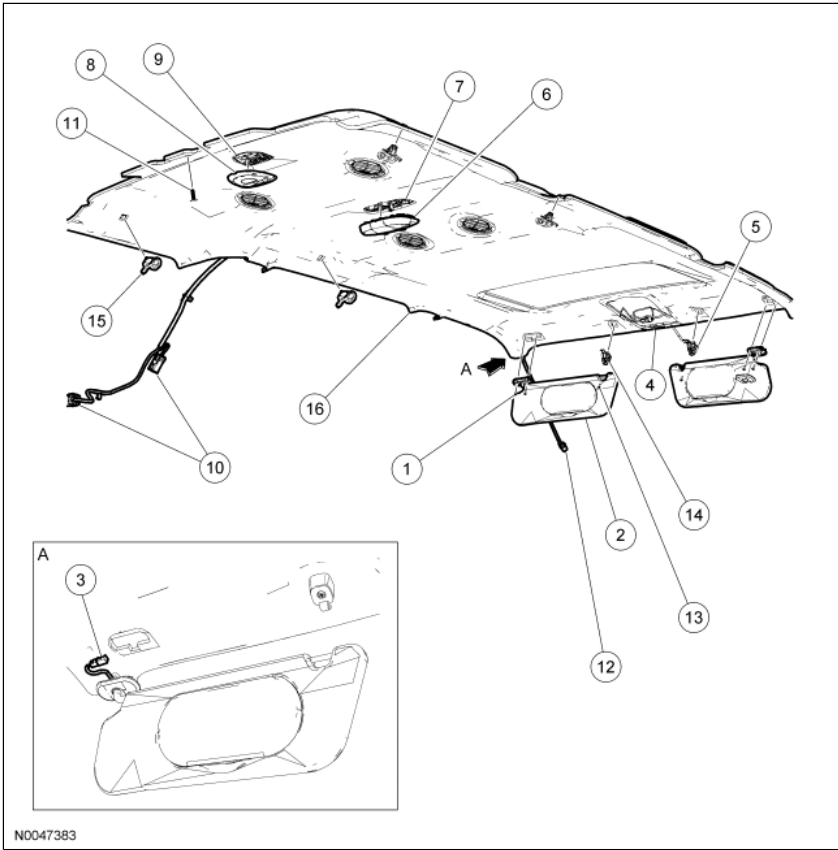

N0047383

Item	Part Number	Description
1	W707364	Sun visor retainer screw (4 required)
2	041100	Sun visor
3	14334	Sun visor electrical connector
4	14334	Roof opening panel electrical connector
5	14334	Interior mirror electrical connector
6	19893	Dome lamp cover
7	14334	Dome lamp electrical connector
8	19893	Cargo lamp cover
9	14334	Cargo lamp electrical connector
10	14334	Headliner electrical connectors (rear)
11	51968	Pin-type retainer
12	14334	Headliner electrical connector (front)
13	W707364	Sun visor center retainer screw
14	041A20	Sun visor center retainer
15	29019	Garment hook (4 required)
16	51944	Headliner

Explorer Sport Trac

NOTE: Headliner without roof opening panel shown, headliner with opening panel similar.

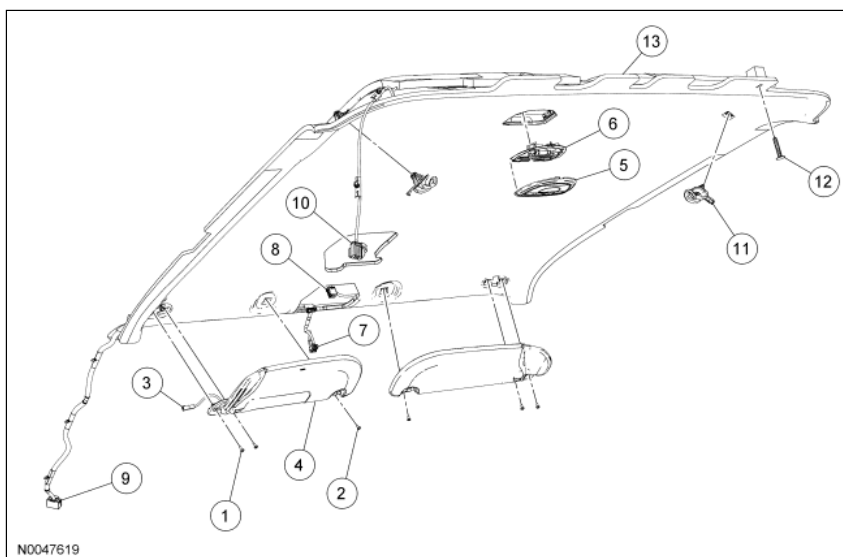

N0047619

Item	Part Number	Description
1	W707364	Sun visor retainer screw (4 required)
2	W707364	Sun visor center retainer screw (2 required)
3	14334	Sun visor electrical connector
4	04100	Sun visor
5	—	Dome lamp cover
6	—	Dome lamp
7	14334	Interior mirror electrical connector
8	14334	Overhead console electrical connector
9	14334	Headliner electrical connector (front)
10	14334	Headliner electrical connector (rear)
11	29019	Garment hook (2 required)
12	51968	Pin-type retainer
13	51944	Headliner

Explorer and Mountaineer only

1. If equipped, remove the rear entertainment system. For additional information, refer to [Section 415-00](#).

Explorer Sport Trac only

2. **NOTE:** The headliner is removed through the rear passenger door. To facilitate removal, the front passenger seat must be removed.

Remove the front passenger seat. For additional information, refer to [Section 501-10](#).

All vehicles

3. Remove the overhead console. For additional information, refer to [Section 501-12](#).
4. Remove the A-pillar trim panel. For additional information, refer to [A-Pillar Trim Panel](#) in this section.
5. Position the B-pillar upper trim panel aside. For additional information, refer to [B-Pillar Upper Trim Panel](#) in this section.

Explorer and Mountaineer only

6. Remove the C-pillar trim panel. For additional information, refer to [C-Pillar Trim Panel — Explorer, Mountaineer](#) in this section.
7. Remove the D-pillar trim panel. For additional information, refer to [D-Pillar Trim Panel](#) in this section.

Explorer Sport Trac

8. Position the C-pillar upper trim panel aside. For additional information, refer to [C-Pillar Upper Trim Panel — Explorer Sport Trac](#) in this section.

All vehicles

9. Remove the gimp around the roof opening panel, if equipped.
10. Remove the 4 sun visor retainer screws.
11. Remove the sun visors.

12. Carefully lower the headliner at the corner of the sun visor location to access the electrical connector and disconnect the electrical connector.
13. Disconnect the roof opening panel, if equipped.
14. Disconnect the interior mirror electrical connector and electronic compass sensor connector, if equipped.
15. Use a thin-blade tool and carefully remove the dome lamp cover.
16. Disconnect the dome lamp electrical connectors.

Explorer and Mountaineer only

17. Remove the upper air duct.
 - Remove the pin-type retainers.
 - Push down on the duct, tilt the top outward and pull upward to remove.

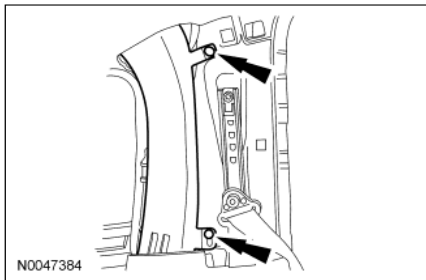

18. Remove the lower air duct.

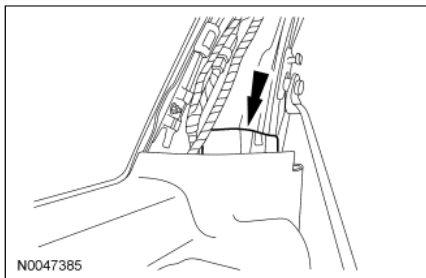

19. Disconnect the electrical connector located at the C-pillar.
 - Release the wiring harness pin-type retainers.

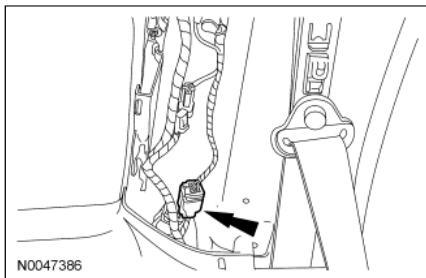

20. Disconnect all the electrical connectors.

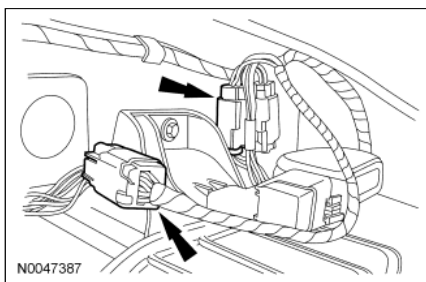

All vehicles

21. Disconnect the electrical connector and the wiring pin-type retainers on the A-pillar.

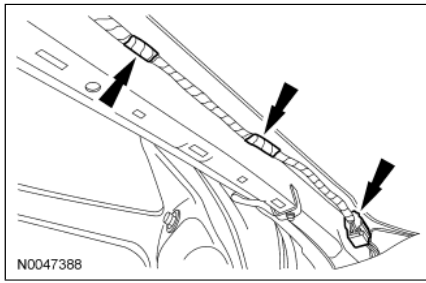

22. **CAUTION:** To prevent bending or damaging the headliner, an assistant is required to support the headliner while carrying out the remaining steps.

Open the sun visor center retainer cover and remove the screw.

23. Remove the sun visor center retainer.
24. Remove the rear pin-type retainer.

25. **CAUTION:** To prevent damaging the garment hanger retainer, use a 3/16-inch flat-blade screwdriver to carry out this step.

NOTE: The garment hanger is shown without the roof sheet metal screw to show the metal retainer clip. The metal retainer clip will remain engaged in the sheet metal after the garment hanger is removed.

Remove the garment hangers.

1. Open the access door.
2. Insert the flat-blade screwdriver fully into the garment hanger slot.
3. Rotate the screwdriver 90 degrees so that the screwdriver spreads the metal retainer clip. Remove the plastic garment hanger.

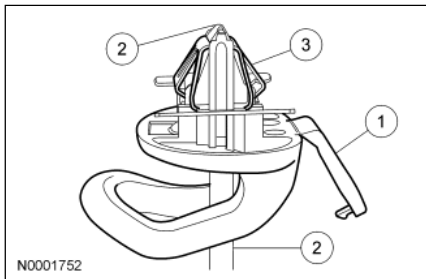

26. **NOTE:** The headliner is removed through the passenger rear door for Explorer Sport Trac.

Remove the headliner.

27. To install, reverse the removal procedure.