

2003 PILOT - Front Door Panel Removal/Installation

Special Tools Required

- Trim pad remover, Snap-on A 177A, or equivalent, commercially available.
1. Using a flat-tip screwdriver wrapped with protective tape, pry out on the lower portion of the cover (A) to release the hooks (B), then remove the cover.
 2. Remove the screws.

Fastener Locations

▶ : Screw, 2

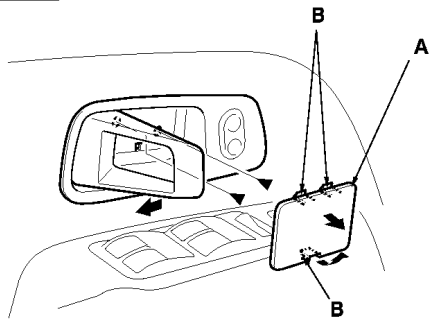

3. Remove the inner handle (A) from the door panel.
 - 1 Pull the handle forward and out half-way to release the hook (B).
 - 2 Pull out the top of the handle.

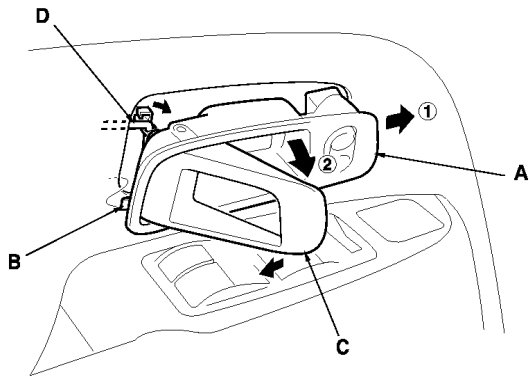

4. Disconnect the power door lock switch connector (A), then remove the inner handle (B).

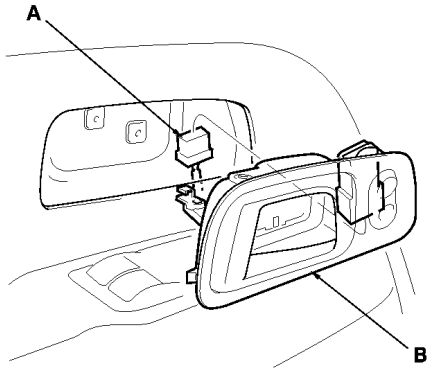

5. Detach the clips and release the hooks (A, B), then remove the switch panel (C). Take care not to scratch the door panel. Disconnect the power window switch connectors (D). On driver's side, disconnect the power mirror switch connector (E).
6. Remove the mirror mount cover.

Fastener Location

▷ : Clip, 1

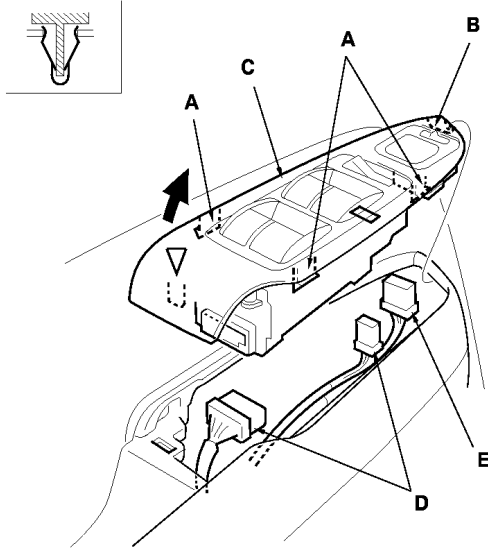

7. Remove the door panel (A) with as little bending as possible to avoid creasing or breaking it.
 - 1 Remove the screws (B).
 - 2 Release the clips (C) that hold the door panel with a commercially available trim pad remover (D).
 - 3 Starting at the rear, pull the door panel upward, then release the lock knob (E).
8. Install the door panel in the reverse order of removal, and note these items:
 - Replace any damaged clips.
 - Make sure the connectors are plugged in properly.
 - Push the clips into place securely.
 - Do the power window control unit reset procedure.
 - Check the window and power door lock operations.

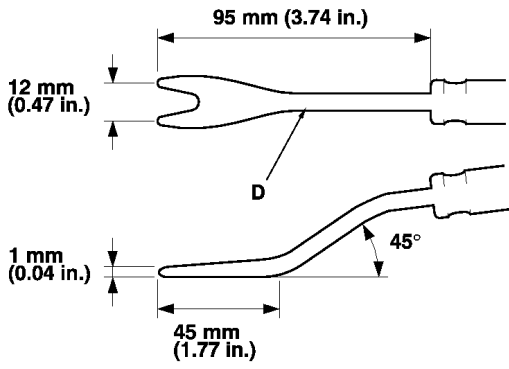

Fastener Locations

B ▶ : Screw, 2 **C** ▶ : Clip, 8

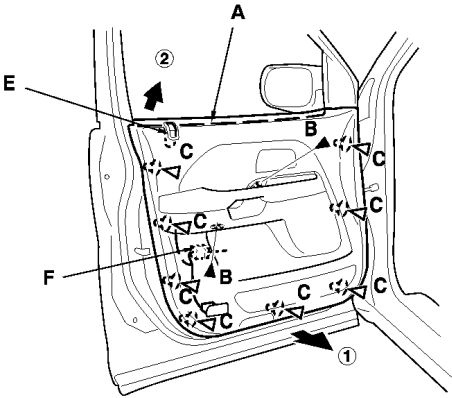
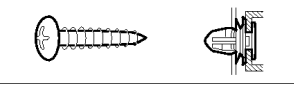

2003 PILOT - Front Door Outer Handle Replacement

NOTE: Put on gloves to protect your hands.

1. Remove these items:
 - Door panel
 - Plastic cover, as necessary
2. Raise the glass fully.
3. Remove the bolt, then remove the center lower channel (A) with the center lower glass run channel (B) by pulling it downward.

Fastener Location

▶ : Bolt, 1

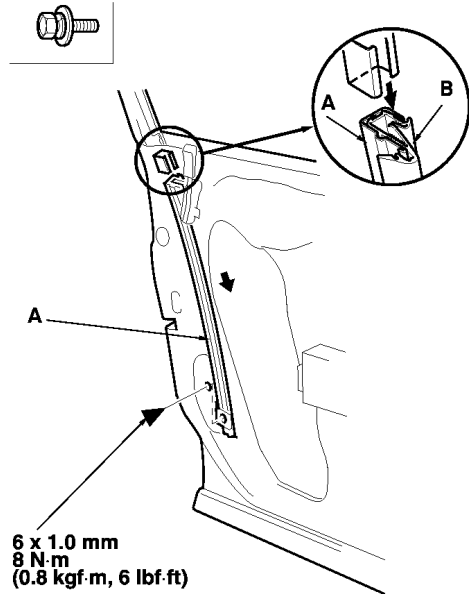

4. Remove the screw, and release the hook (A), then remove the lock rod protector (B) by detaching the clip (C).

Fastener Location

▶ : Screw, 1

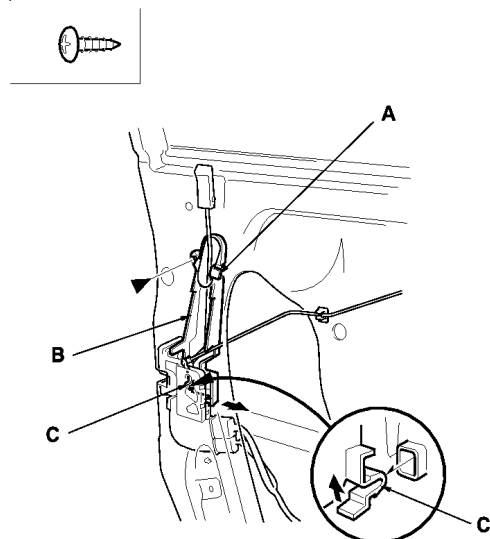

5. Disconnect the outer handle rod (A) and cylinder rod (B).

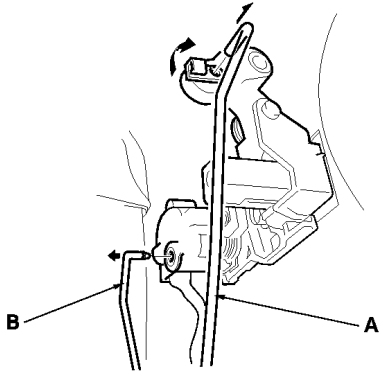

6. Release the retainer clip (A) with a hook-shaped tool. Remove the lock cylinder (B).

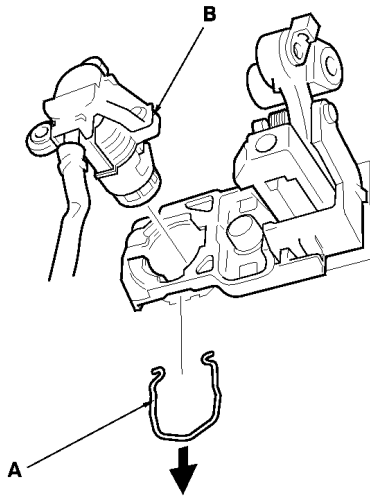

7. Remove the screw, then separate the lock cylinder (A) and cylinder switch (B).

Fastener Location

▶ : Screw, 1

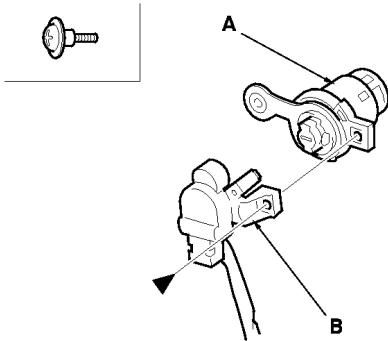

8. Disconnect the cylinder switch connector (A), and detach the harness clips (B), and remove the cylinder switch harness (C).

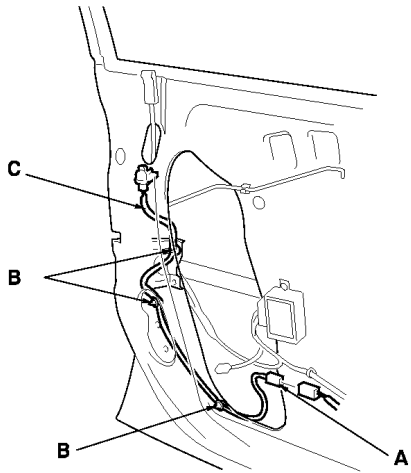

9. Remove the maintenance seal (A), and remove the bolt, then remove the cylinder protector (B).

Fastener Location

▶ : Bolt, 1

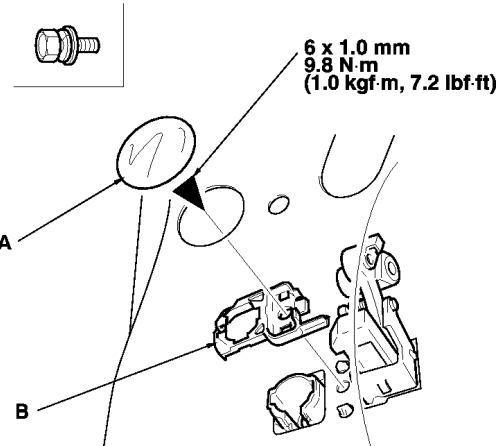

10. Remove the bolt, then remove the spacer (A).

Fastener Location

▶ : Bolt, 1

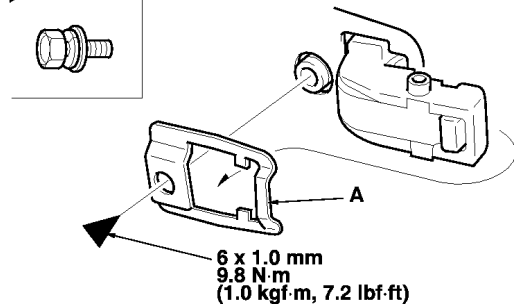

11. While pulling the outer handle (A), remove the handle from the holes in the door panel. Take care not to scratch the door.

12. Install the handle in the reverse order of removal, and note these items:

- Make sure the cylinder switch harness is routed properly.
- Make sure the connector is plugged in properly, and each rod is connected securely.
- Make sure the door locks and opens properly.
- When installing the lock cylinder, leave the outer door handle bolts loose so the inner protector does not interfere with the lock cylinder installation, then tighten the handle bolts.

- Install the lock cylinder retaining clip on the handle, then install the lock cylinder. Be sure the clip is fully seated in the slot on the lock cylinder.
- When reinstalling the door panel, make sure the plastic cover is installed properly and sealed around its perimeter.
- Do the power window control unit reset procedure.

