

2003 MDX - Intake Manifold Removal and Installation

Exploded View

Removal

1. Remove the intake manifold cover.

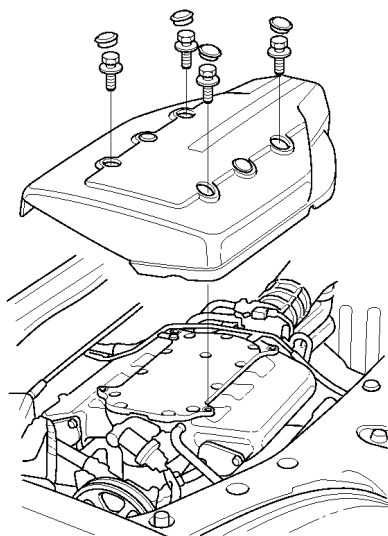

2. Disconnect the intake air temperature (IAT) sensor 2 connector (A), and remove the breather pipe (B), then remove the intake air duct (C).

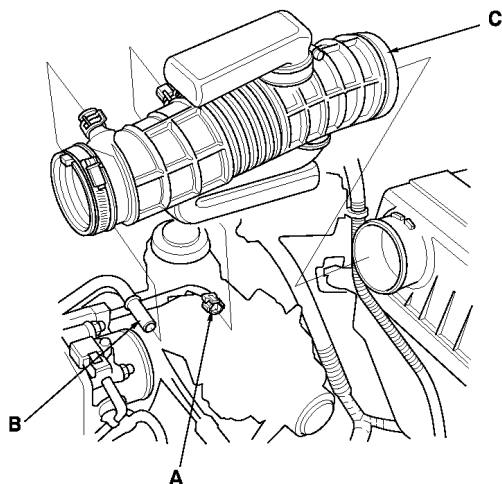

3. Remove the positive crankcase ventilation (PCV) hose (A), brake booster vacuum hose (B), vacuum hose (C) and vacuum line mounting bolts (D).

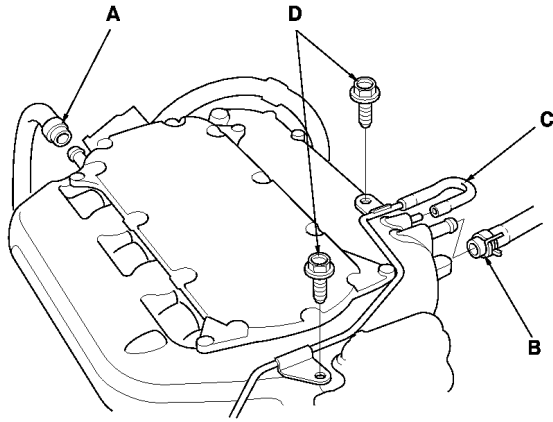

4. Remove the evaporative emission (EVAP) canister hose (A) and the transmission breather hose clamp bracket (B).
5. Remove and plug the water bypass hoses (C).
6. Remove the engine wire harness connectors and wire harness clamps from the intake manifold.
 - Intake air temperature (IAT) sensor 1 connector
 - Throttle actuator connector
 - Manifold absolute pressure (MAP) sensor connector
 - Evaporative emission (EVAP) canister purge valve connector
 - Intake manifold tuning (IMT) (intake manifold runner control (IMRC)) actuator connector

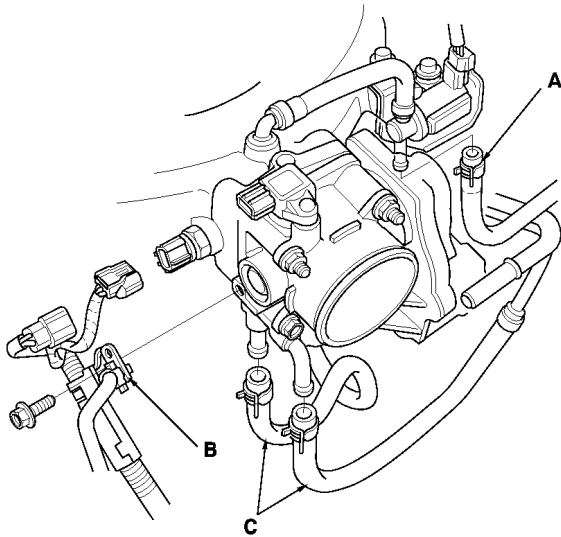

7. Remove the upper cover mounting bolts and nuts sequentially in two or three steps, then remove the upper cover.

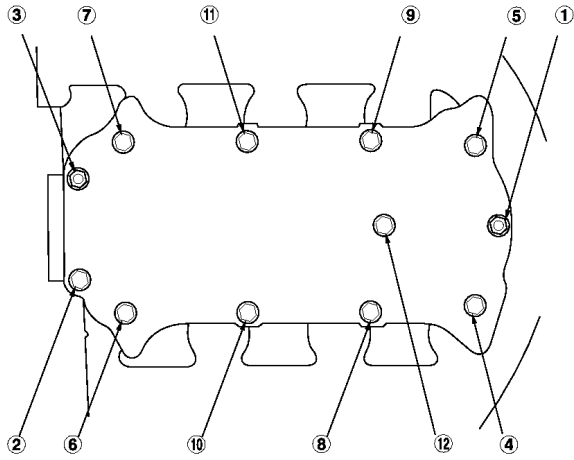

8. Remove the intake manifold mounting bolts and nuts sequentially in two or three steps, then remove the intake manifold and spacer.

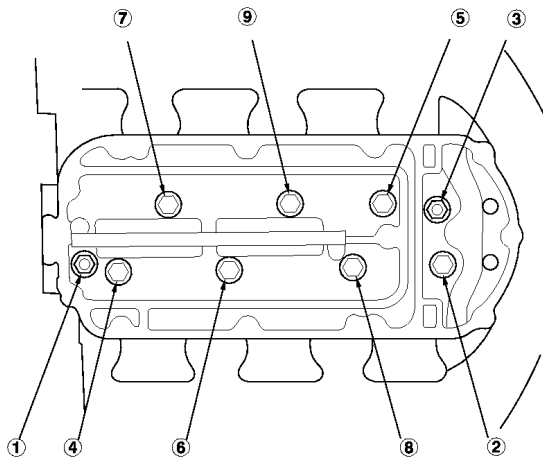

Installation

1. Install the gasket and spacer on the injector base.
2. Install the intake manifold. Tighten the bolts and nuts sequentially in two or three steps. Always use a new intake manifold gasket.

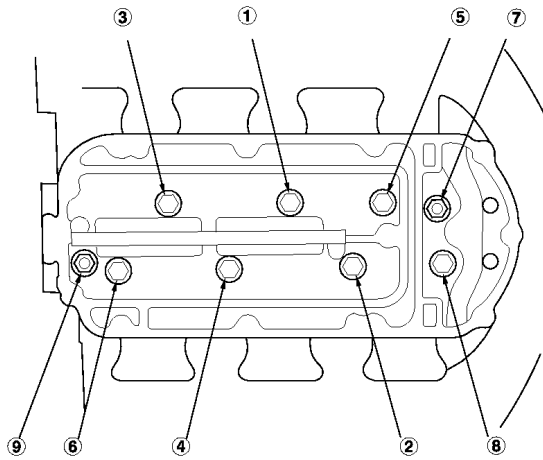

3. Install the upper cover. Tighten the bolts and nuts sequentially in two or three steps. Always use a new gasket.

4. Install the engine wire harness connectors and wire harness clamps from the intake manifold.

- Intake air temperature (IAT) sensor 1 connector
- Throttle actuator connector
- Manifold absolute pressure (MAP) sensor connector
- Evaporative emission (EVAP) canister purge valve connector
- Intake manifold tuning (IMT) (intake manifold runner control (IMRC)) actuator connector

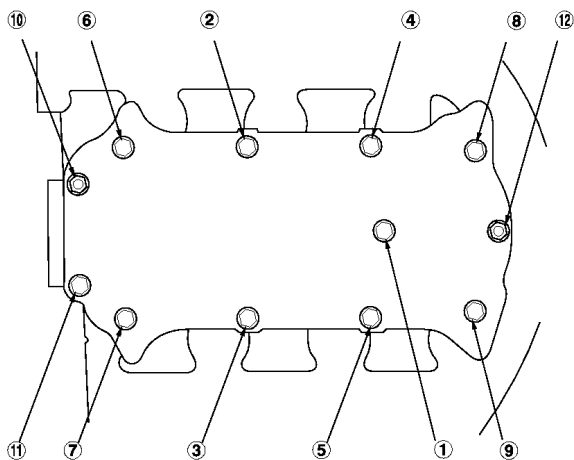

5. Install the evaporative emission (EVAP) canister hose (A), transmission breather hose clamp bracket (B), and water bypass hoses (C).

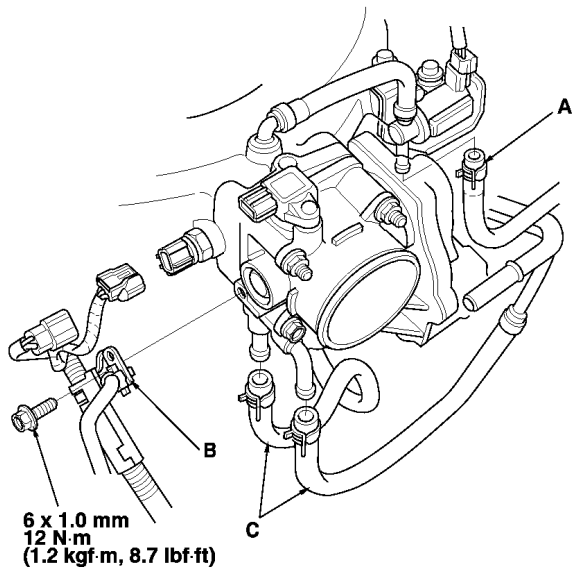

6. Install the positive crankcase ventilation (PCV) hose (A), brake booster vacuum hose (B), vacuum hose (C), and vacuum line mounting bolts (D).

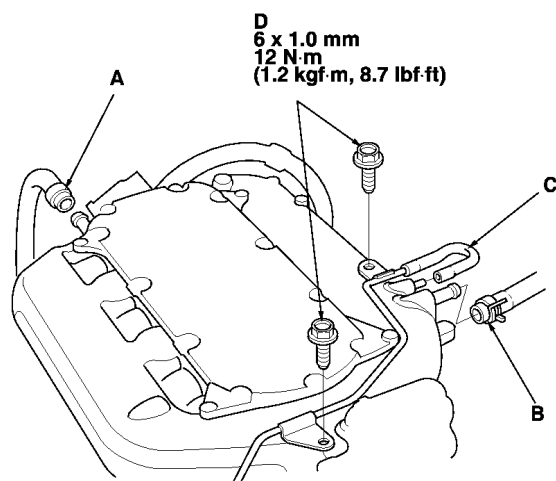

7. Install the intake air duct (A), then install the breather pipe (B).
8. Connect the IAT sensor 2 connector (C).

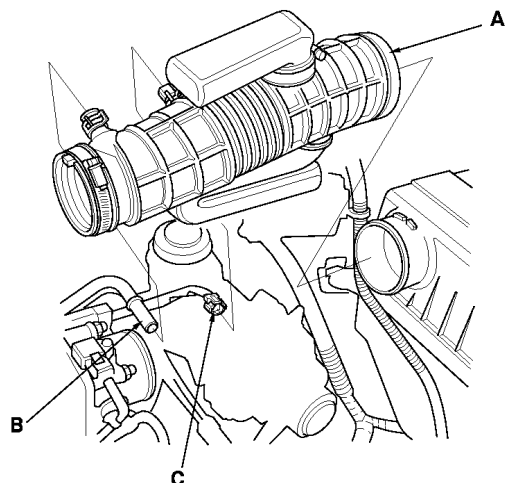

9. Install the intake manifold cover.

10. Clean up any spilled engine coolant.
11. After installation, check that all tubes, hoses, and connectors are installed correctly.
12. Refill the radiator with engine coolant, and bleed air from the cooling system with heater valve open.

