

LOWER CONTROL ARM REPLACEMENT

Tools Required

J 43631 Ball Joint Remover. See [Special Tools](#).

Removal Procedure

1. Raise and support the vehicle. Refer to [Lifting and Jacking the Vehicle](#) in General Information.
2. Remove the tire and wheel. Refer to [Tire and Wheel Removal and Installation](#) in Tires and Wheels.
3. Remove the shock module yoke. Refer to [Shock Module Yoke Replacement](#).

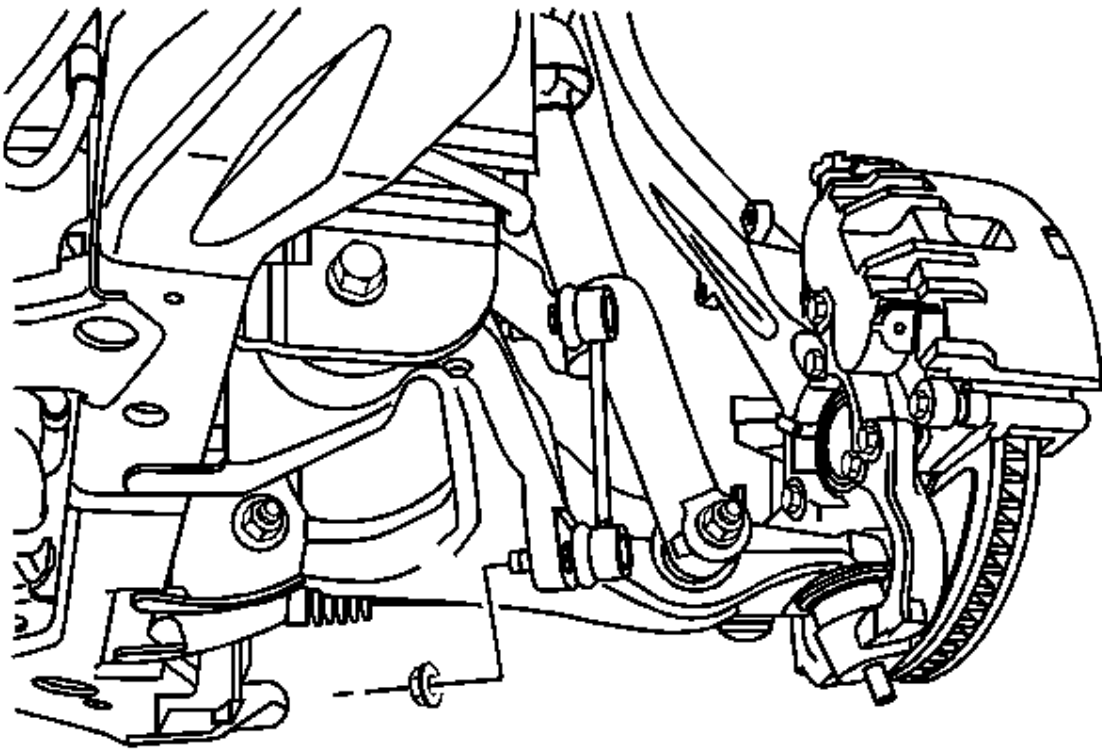

Fig. 28: View Of Stabilizer Shaft Link Lower Retaining Nut
Courtesy of GENERAL MOTORS CORP.

4. Remove the stabilizer shaft link lower retaining nut.

5. Remove the stabilizer shaft link from the lower control arm.
6. Remove the ABS wire harness from the lower control arm.

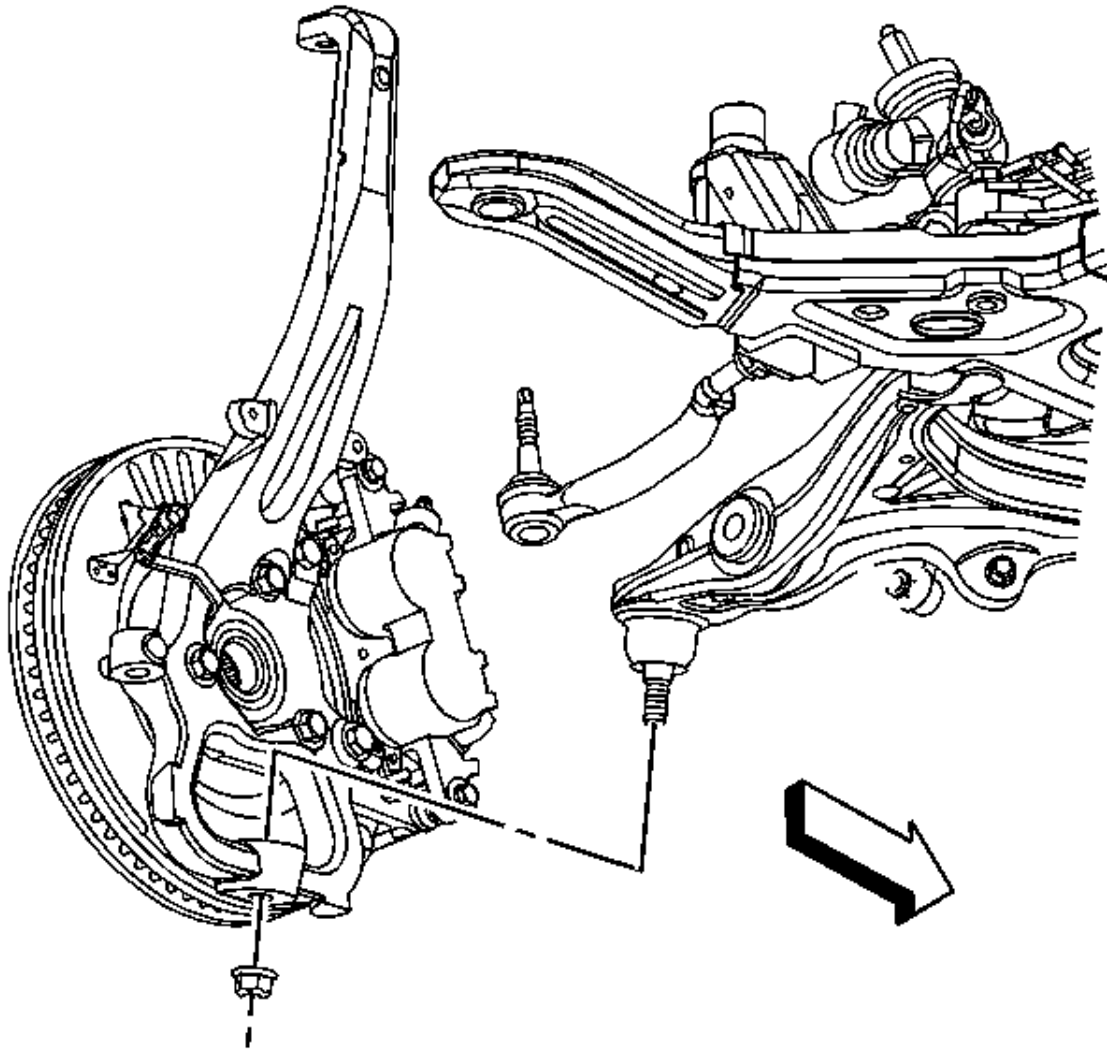

Fig. 29: View Of Lower Control Arm Ball Stud-To-Steering Knuckle Retaining Nut
Courtesy of GENERAL MOTORS CORP.

7. Remove the lower control arm to steering knuckle nut.

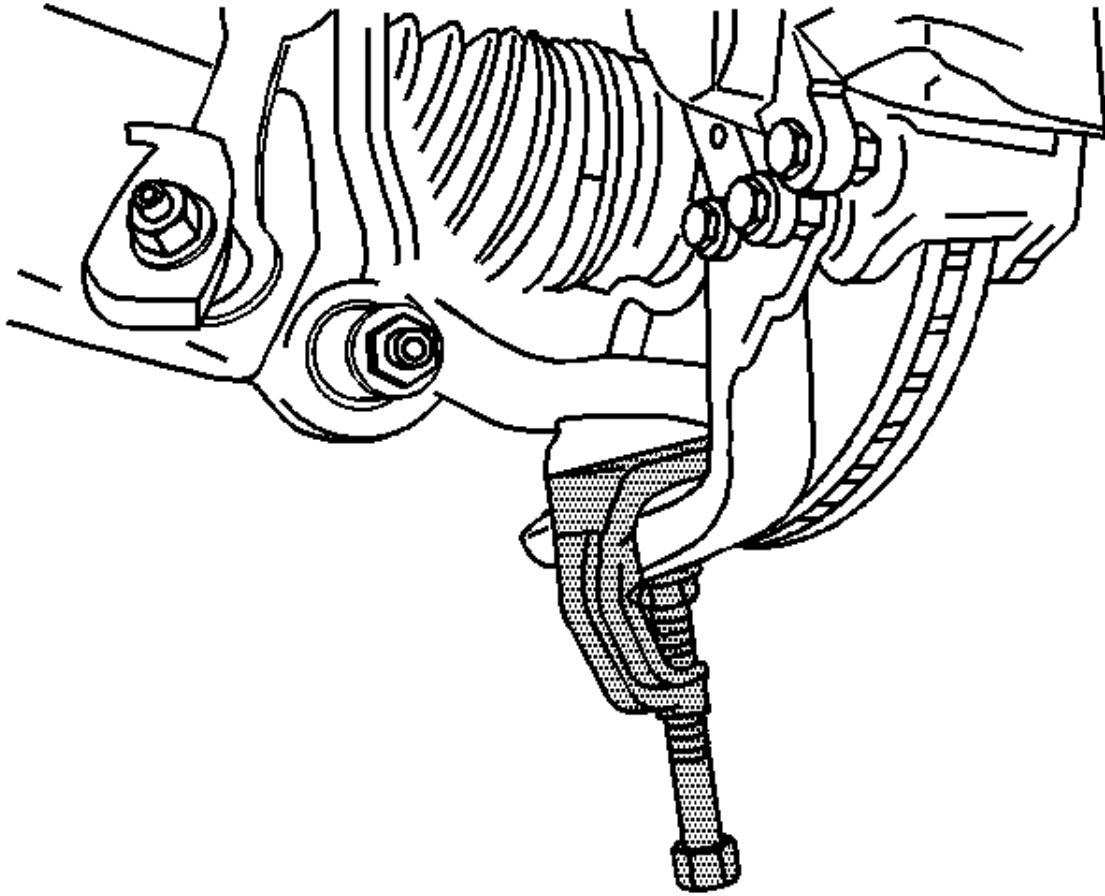

Fig. 30: Removing Steering Knuckle From Lower Control Arm

Courtesy of GENERAL MOTORS CORP.

8. Using the **J 43631** , separate the lower control arm from the steering knuckle. See **Special Tools**.

IMPORTANT: Will need to raise the power steering gear to have clearance when removing the rear lower control arm to frame retaining bolt.

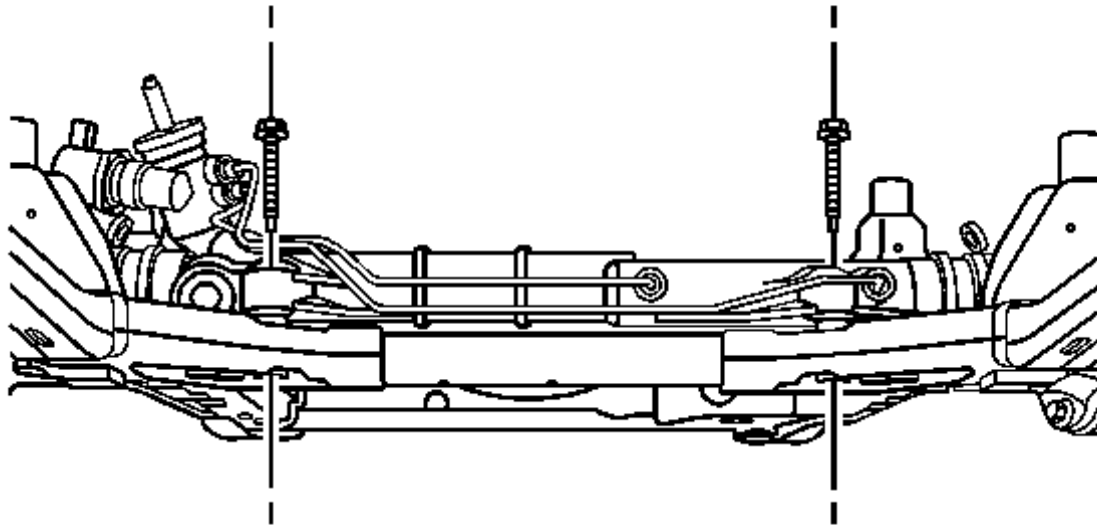

Fig. 31: View Of Power Steering Gear Mounting Bolts
Courtesy of GENERAL MOTORS CORP.

9. Loosen the power steering gear retaining bolts and raise the power steering gear.

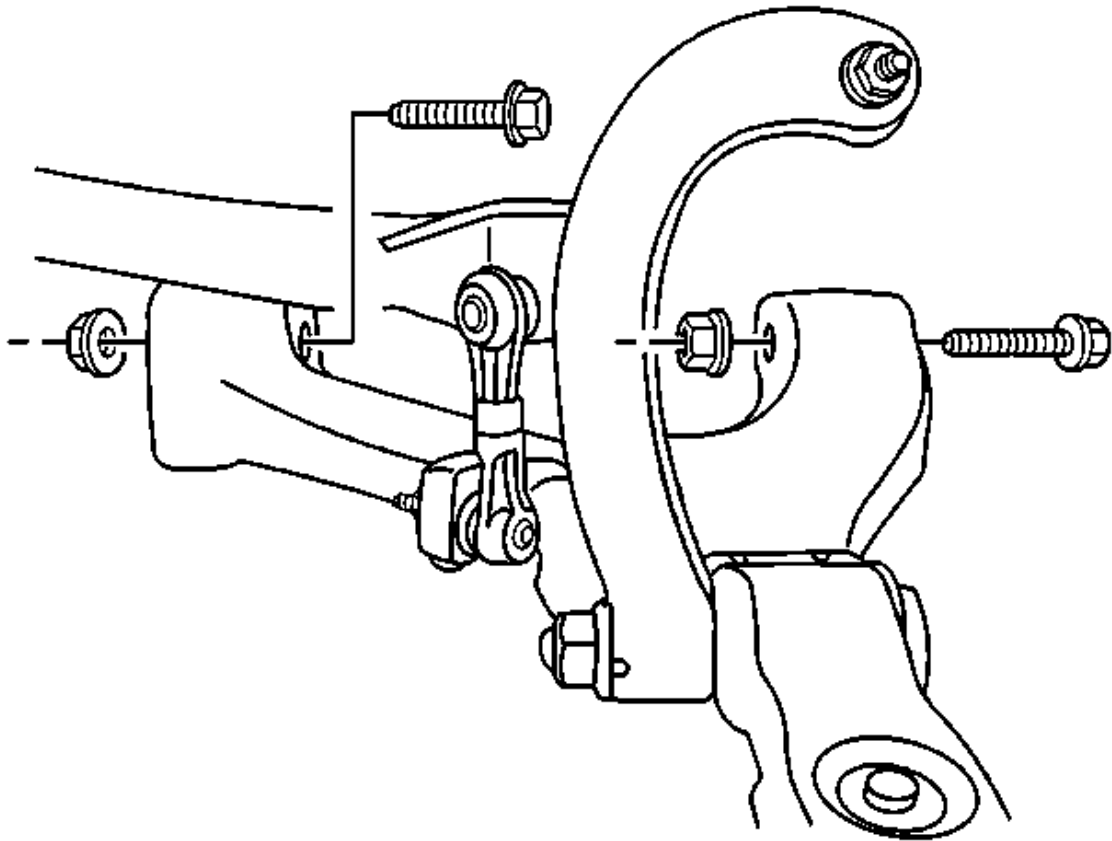

Fig. 32: Removing/Installing Lower Control Arm-To-Lower Control Arm Bracket Mounting Nuts

Courtesy of GENERAL MOTORS CORP.

10. Remove the lower control arm to cradle nuts.
11. Remove the lower control arm to cradle bolts.
12. Remove the lower control arm by lowering the lower control arm at the frame and moving the ball stud upwards.

Installation Procedure 

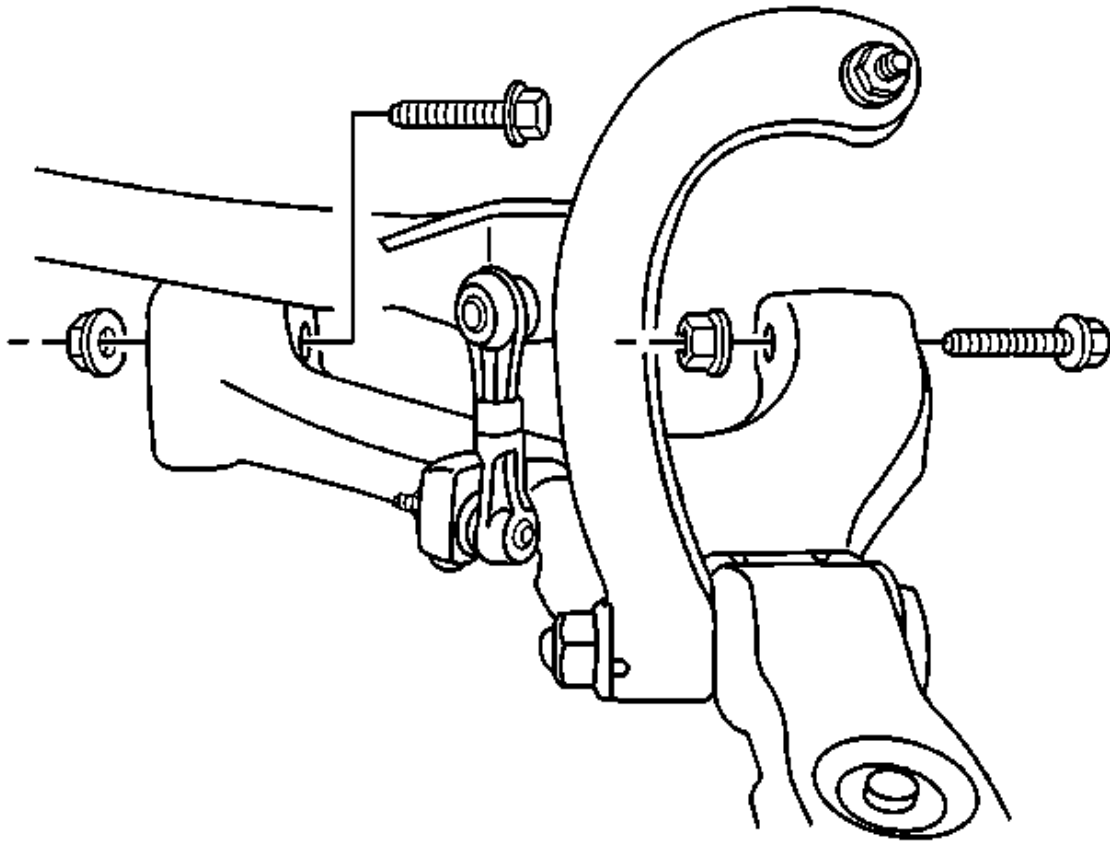

Fig. 33: Removing/Installing Lower Control Arm-To-Lower Control Arm Bracket Mounting Nuts

Courtesy of GENERAL MOTORS CORP.

1. Install the lower control arm by installing the lower control arm on the ball stud and moving the lower control arm up to the cradle.
2. Install the lower control arm to cradle bolts.

NOTE: Refer to **Fastener Notice** in Cautions and Notices.

3. Install the lower control arm to cradle nuts.

Tighten: Tighten the nuts to 135 N.m (96 lb ft).

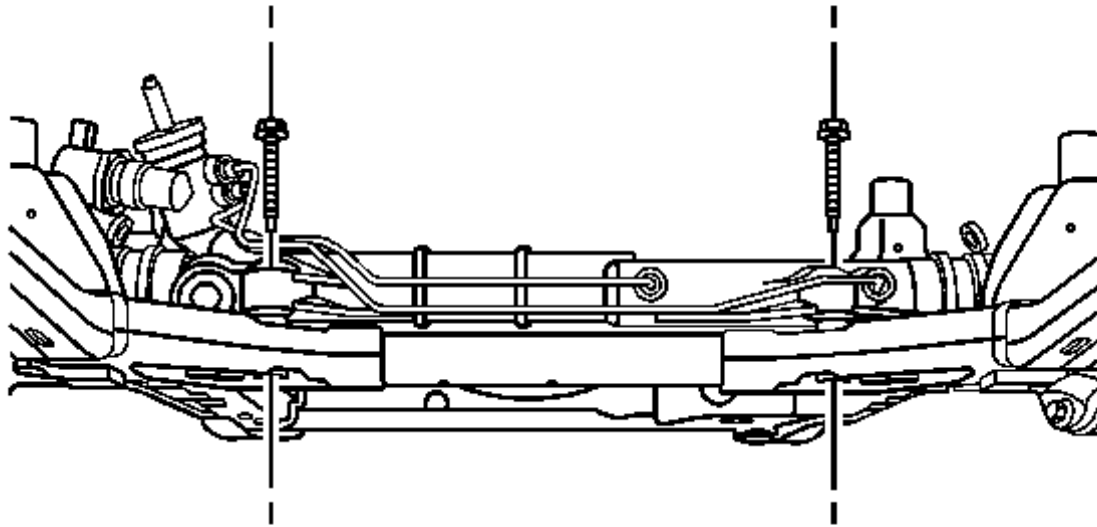

Fig. 34: View Of Power Steering Gear Mounting Bolts
Courtesy of GENERAL MOTORS CORP.

4. Tighten the power steering gear retaining bolts.

Tighten: Tighten the bolts to 120 N.m (89 lb ft).

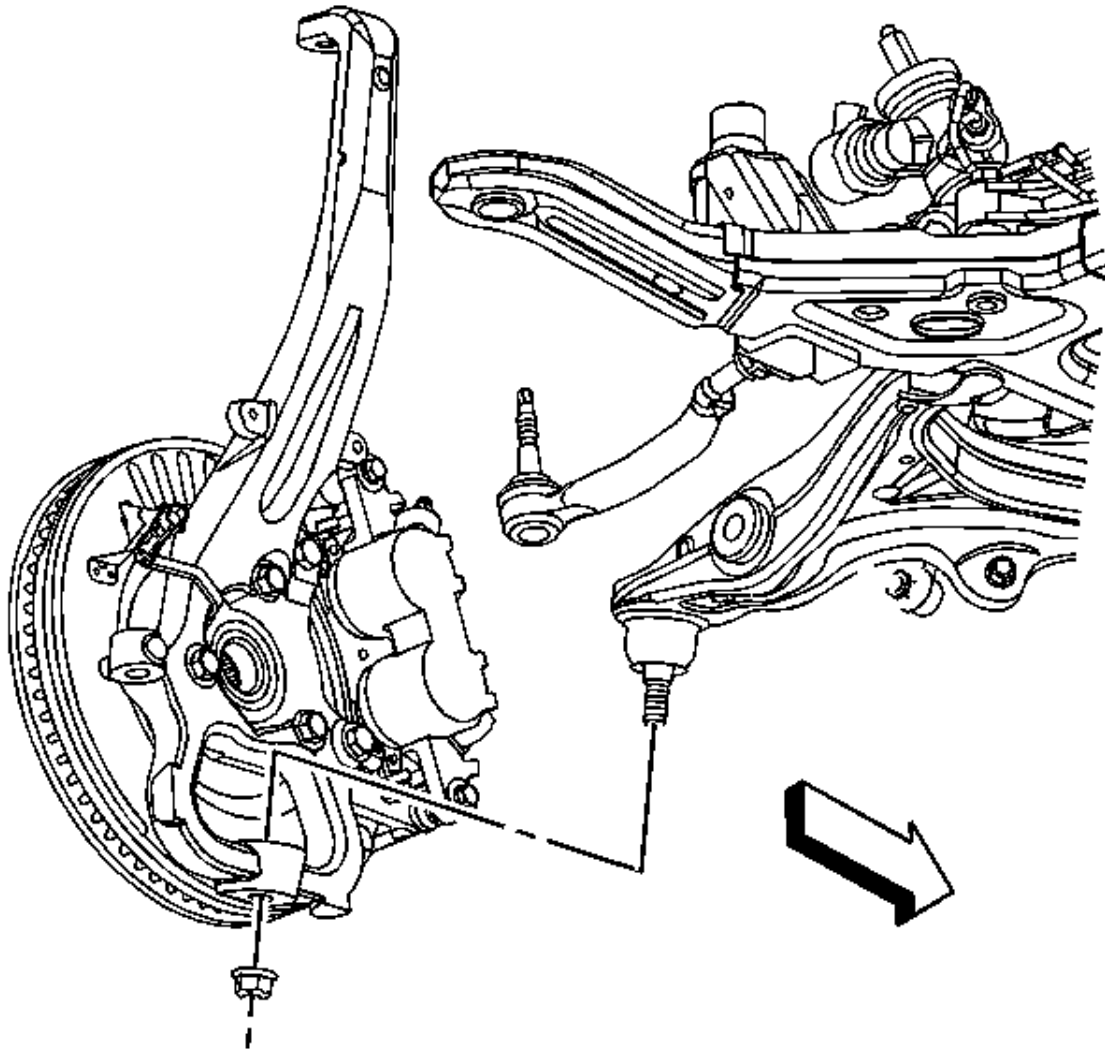

Fig. 35: View Of Lower Control Arm Ball Stud-To-Steering Knuckle Retaining Nut
Courtesy of GENERAL MOTORS CORP.

5. Install the lower control arm to steering knuckle nut.

Tighten:

1. Tighten the nut to 20 N.m (15 lb ft).
 2. Tighten the nut to an additional 210 degrees.
6. Install the ABS wire harness to the lower control arm.

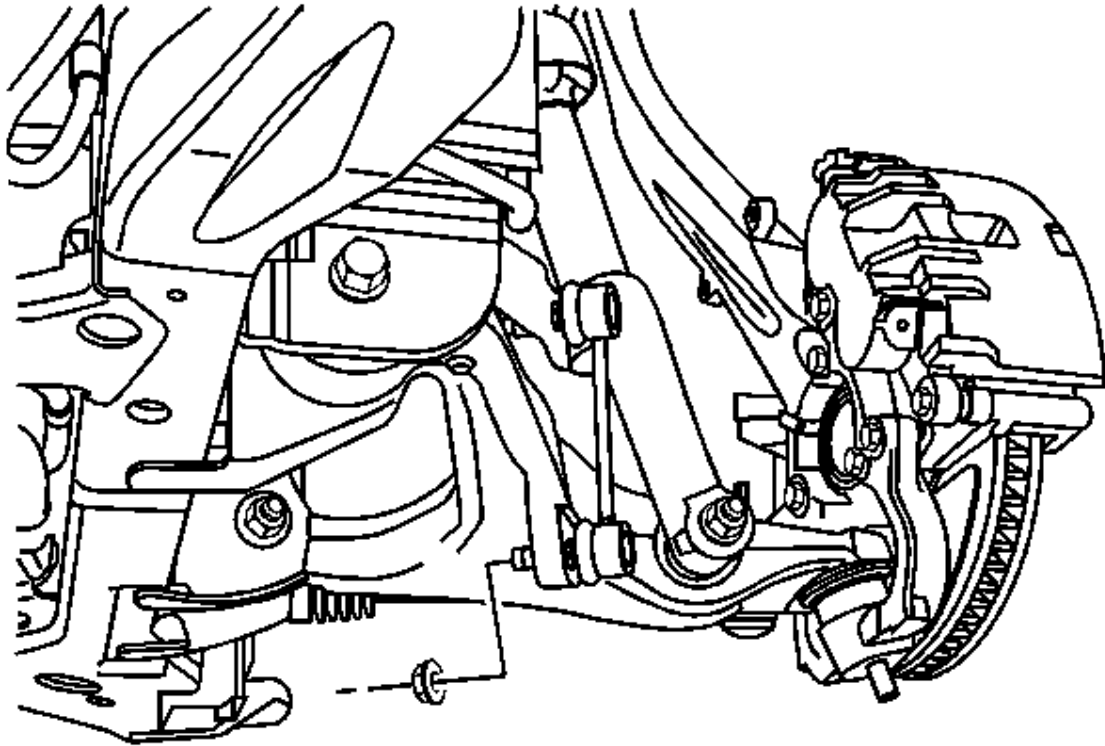

Fig. 36: View Of Stabilizer Shaft Link Lower Retaining Nut
Courtesy of GENERAL MOTORS CORP.

7. Install the stabilizer shaft link to the lower control arm.
8. Install the stabilizer shaft link lower retaining nut.

Tighten: Tighten the nut to 110 N.m (81 lb ft).

9. Install the shock module yoke. Refer to **Shock Module Yoke Replacement**.
10. Install the tire and wheel. Refer to **Tire and Wheel Removal and Installation** in Tires and Wheels.
11. Lower the vehicle.
12. Align the front end. Refer to **Measuring Wheel Alignment** in Wheel Alignment.