

HONDA**2.0L & 2.1L 4-Cylinder - DOHC - Prelude****MANUFACTURER'S SUGGESTED SCHEDULED MAINTENANCE**

Although the manufacturer does not recommend a specific scheduled maintenance interval for 1988-89 models, belt manufacturers suggest the belt be replaced at 60,000 mile intervals. On 1990-91 models, the manufacturer recommends belt be replaced every 90,000 miles.

REMOVAL & INSTALLATION

CAUTION: This application is an interference engine. Do not rotate camshaft or crankshaft when timing belt is removed, or engine damage may occur.

TIMING BELT**Removal**

1. Disconnect negative battery cable. Rotate crankshaft counterclockwise until cylinder No. 1 is at TDC of compression stroke. Remove drive belts. Remove left engine mount bolts/nuts, engine mount and bracket. Remove cruise control actuator (if equipped).
2. Remove engine splash shield. Remove power steering adjusting pulley. Remove power steering pump with hoses attached, and set aside. Remove alternator.
3. Remove A/C compressor (if equipped). Remove engine valve cover and upper timing belt cover. See **Fig. 1**. Ensure timing marks align, and UP marks on camshaft sprockets are positioned at the top. See **Fig. 2**.
4. Remove crankshaft pulley. Remove lower timing belt cover. If reusing timing belt, mark belt rotation direction before removing. Loosen timing belt tensioner adjustment bolt, and push tensioner to release belt tension. Tighten adjustment bolt and remove timing belt.

Inspection

Inspect timing belt for wear and for signs of oil contamination. Replace belt if damaged or contaminated. Inspect all drive gears for wear in drive belt area. Inspect water pump for excessive bearing play or coolant leakage. Replace if necessary.

Installation

1. Ensure cylinder No. 1 is still at TDC. Install timing belt on sprockets. **DO NOT** bend or twist belt excessively. Ensure arrow on used belt points in original rotation direction.
2. Adjust timing belt tension by rotating crankshaft counterclockwise until cylinder No. 1 is at TDC of compression stroke. Loosen, but do not remove, timing belt adjustment bolt. Rotate crankshaft counterclockwise 3 teeth on camshaft pulley to create tension on timing belt. Tighten adjustment bolt to specification. See **TORQUE SPECIFICATIONS**.
3. To complete installation, reverse removal procedure. Apply non-hardening sealant to rounded surfaces of

1988 Honda Prelude S

HONDA 2.0L & 2.1L 4-Cylinder - DOHC - Prelude

front and rear camshaft caps before installing valve cover gasket. Tighten bolts to specification. See **TORQUE SPECIFICATIONS** . Adjust drive belts to proper tension.

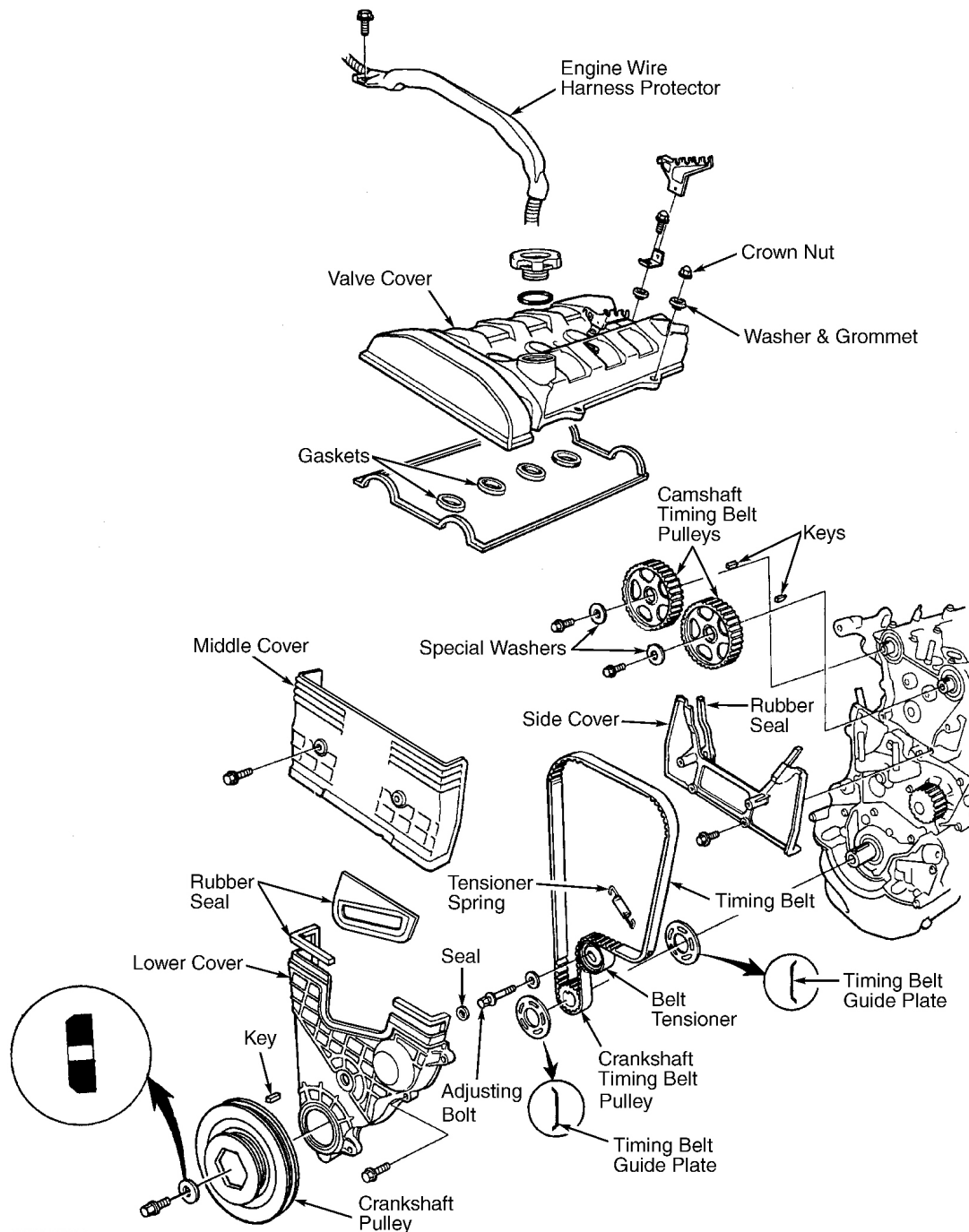
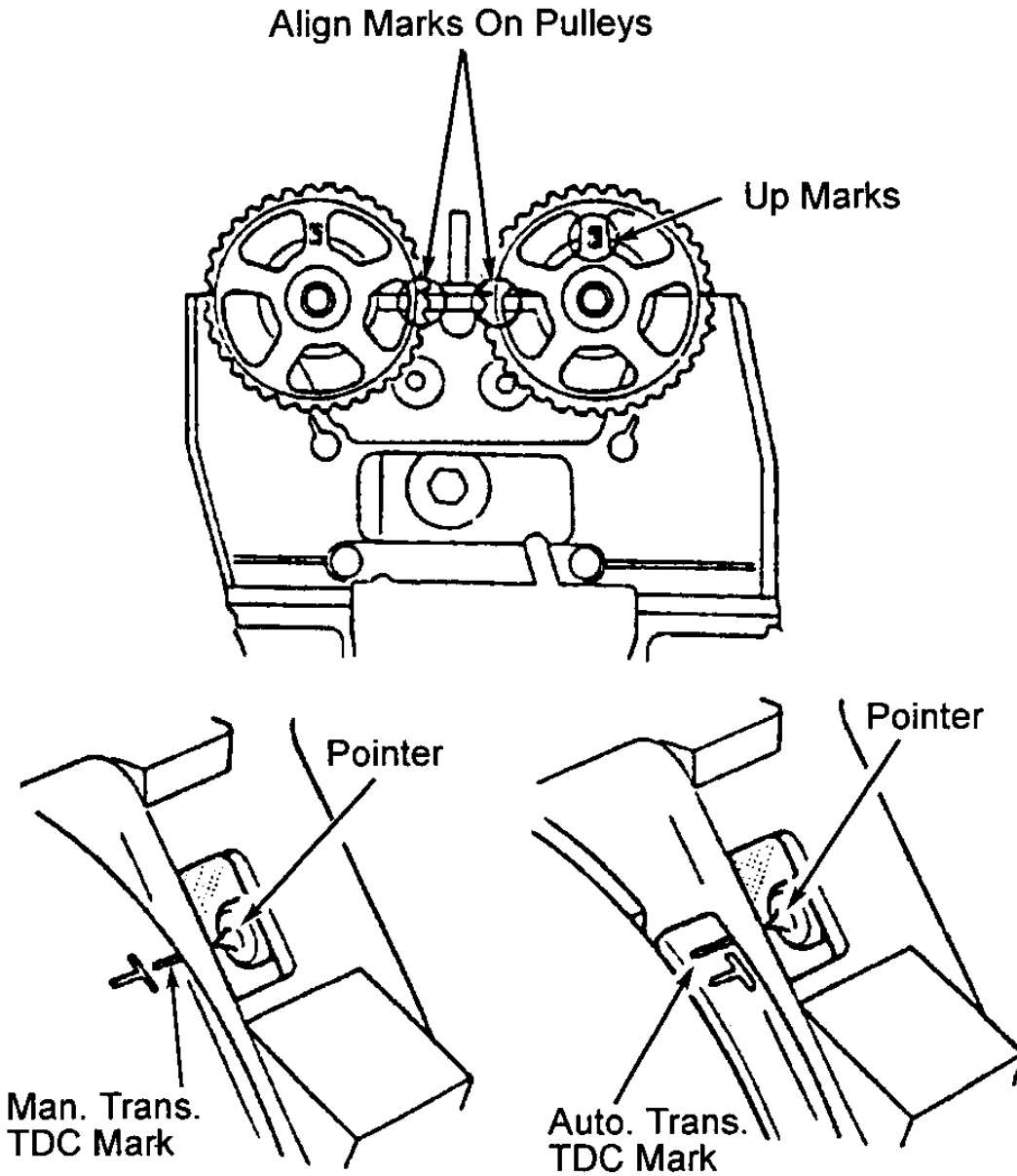

Fig. 1: Exploded View Of Timing Belt & Components
Courtesy of AMERICAN HONDA MOTOR CO., INC.



G00214446

Fig. 2: Aligning Camshaft & Crankshaft Timing Marks
 Courtesy of AMERICAN HONDA MOTOR CO., INC.

TORQUE SPECIFICATIONS

TORQUE SPECIFICATIONS

Application	Ft. Lbs. (N.m)
Virtual Wrench	
Sunday, September 27, 2009 7:49:06 AM	Page 3 © 2005 Mitchell Repair Information Company, LLC.

1988 Honda Prelude S

HONDA 2.0L & 2.1L 4-Cylinder - DOHC - Prelude

A/C Compressor Bracket Bolt	33 (45)
Alternator Bracket Adjustment Bolt	20 (27)
Alternator Bracket Bolt	33 (45)
Camshaft Pulley Bolt	27 (37)
Crankshaft Pulley Bolt	108 (146)
Power Steering Adjustment Nut	31 (42)
Power Steering Pump Bracket Bolt	33 (45)
Timing Belt Adjustment Bolt	31 (42)
	INCH Lbs. (N.m)
Timing Belt Cover Bolt	90 (10)
Valve Cover Nut	90 (10)
Water Pump Bolt	108 (12)