

## HUB & KNUCKLE ASSEMBLY

### Removal (Except Odyssey & S2000)

1. Loosen lug nuts with vehicle weight on tires. Pry lock tab away from spindle nut, and loosen nut. Raise and support vehicle. Remove lug nuts and spindle nut. Remove wheel assembly. Remove brake hose mounting bolts, caliper assembly, and support aside. DO NOT put weight on flexible brake line.
2. Remove brake disc retaining screws. Install two 8 x 1.25-mm bolts in brake disc, and tighten bolts to force brake disc from hub. Alternate tightening of bolts to prevent brake disc from binding on hub. Disconnect ABS wheel sensor (if equipped) from steering knuckle and set aside. DO NOT disconnect sensor connector. Remove cotter pin and nut from tie rod end.
3. On all models except Prelude with Active Torque Transfer System (ATTS), use Ball Joint Remover (07MAC-SL00200). Separate tie rod ball joint and lift tie rod end out of knuckle. See **Fig. 2**, **Fig. 3** and **Fig. 5**. On Prelude with Active Torque Transfer System (ATTS), remove cotter pin and radius rod ball joint nut. Using ball joint separator, separate radius rod ball joint from radius rod. On all models, remove cotter pin from lower control arm ball joint, and nut. Using ball joint remover, separate lower ball joint from control arm.
4. Remove cotter pin and upper ball joint stud nut. Using ball joint remover, separate ball joint from steering knuckle. Remove steering hub/knuckle assembly from axle shaft.

### Removal (Odyssey)

1. Loosen wheel lug nuts slightly. Raise and support vehicle. Remove wheel assembly. Pry lock tab away from spindle nut and remove nut. Remove brake hose mounting bolts. Remove caliper assembly, and hang the caliper to one side with wire. DO NOT put weight on flexible brake line.
2. Remove brake disc retaining screws. Install two 8 x 1.25-mm bolts in brake disc, and tighten bolts to force brake disc from hub. Alternate tightening of bolts to prevent brake disc from binding on hub. Disconnect ABS wheel sensor (if equipped) from steering knuckle and set aside. DO NOT disconnect sensor connector. Remove cotter pin and nut from tie rod end.
3. Remove cotter pin from lower control arm ball joint, and remove nut. See **Fig. 4**. Using ball joint remover and separate lower ball joint from control arm.
4. Remove strut fork pinch bolts and nuts. Remove steering hub/knuckle assembly from axle shaft.

### Removal (S2000)

1. Loosen wheel lug nuts slightly. Raise and support vehicle. Remove wheel assembly. Pry lock tab away from spindle nut and remove nut. Remove brake hose mounting bolts. Remove caliper assembly, and hang the caliper to one side with wire. DO NOT put weight on flexible brake line.
2. Remove the ABS wheel sensor wire bracket. Remove the wheel sensor from knuckle. Do NOT disconnect the sensor connector. Remove brake disc retaining screws. Install two 8 x 1.25-mm bolts in brake disc, and tighten bolts to force brake disc from hub. Remove cotter pin and nut from tie rod end. Using Ball Joint Remover (07MAC-SL00200), separate tie rod ball joint and lift tie rod end out of knuckle.
3. Remove cotter pin from lower control arm ball joint, and remove nut. See **Fig. 6**. Using ball joint separator, separate lower ball joint from control arm.

**2000 Honda Accord EX**

1999-2000 SUSPENSION 'Front

4. Remove hub/knuckle from control arm. Remove cotter pin and nut from upper ball joint. Using ball joint remover, separate ball joint from upper control arm. Slide axle shaft from knuckle and hub assembly. Support axle shaft with wire. Remove hub/knuckle assembly. Remove dust cover, spindle nut and ABS pulser ring from hub assembly.

**Installation**

To install hub/knuckle, reverse removal procedure. Tighten bolts and nuts to specification. Use NEW spindle nut, and stake after tightening. See **TORQUE SPECIFICATIONS** .

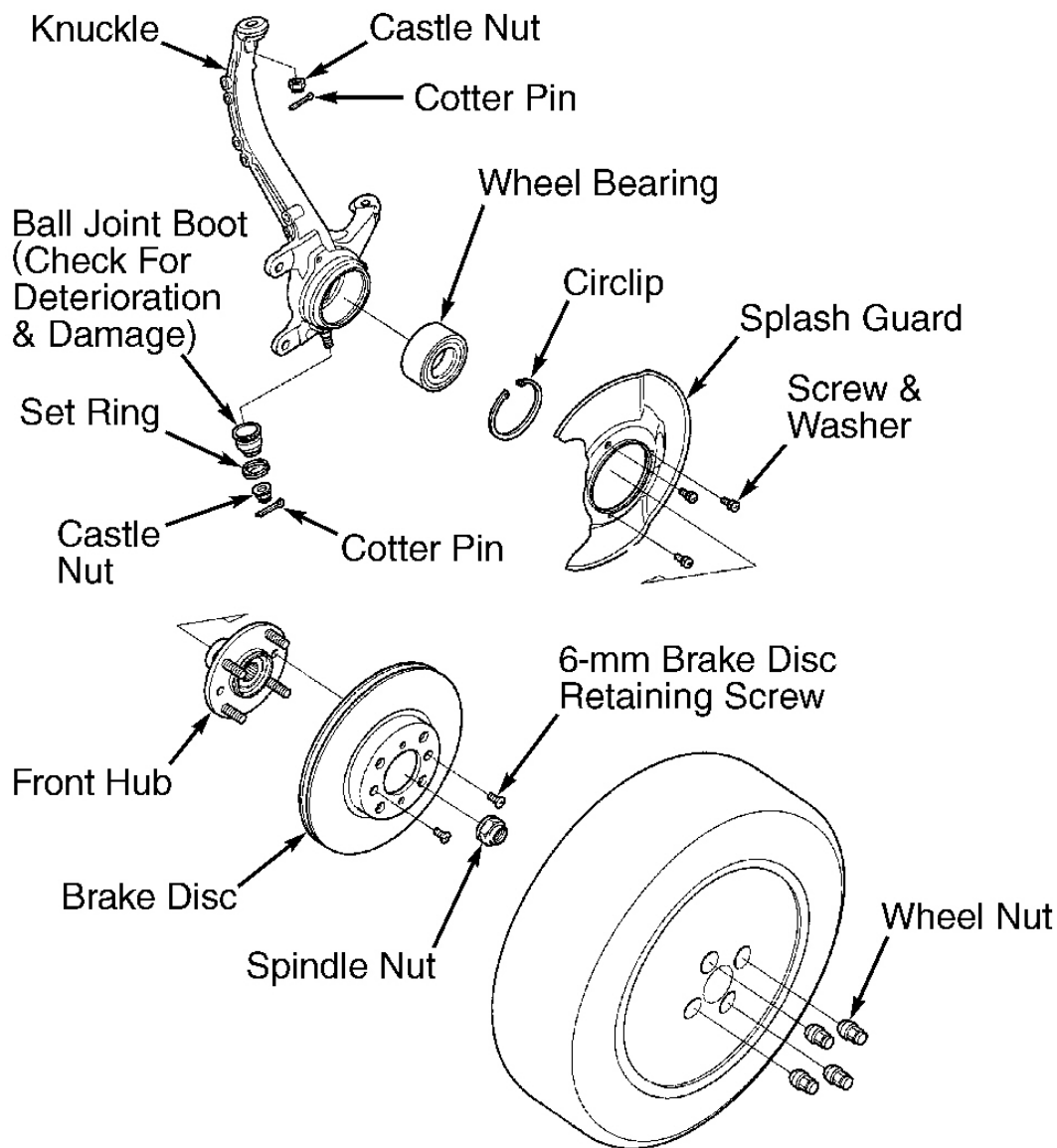

G00015926

**Fig. 2: Exploded View Of Steering Knuckle (Accord)**  
Courtesy of AMERICAN HONDA MOTOR CO., INC.

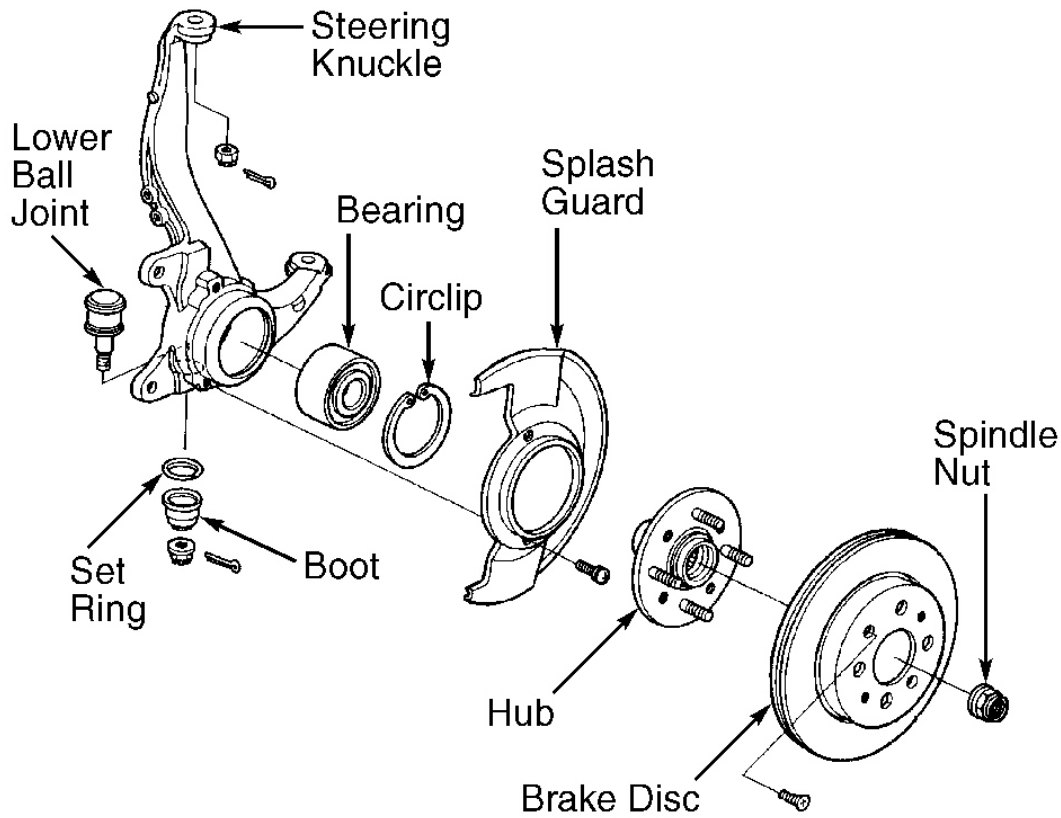

G96J20973

**Fig. 3: Exploded View Of Steering Knuckle (Civic & CR-V)**  
Courtesy of AMERICAN HONDA MOTOR CO., INC.

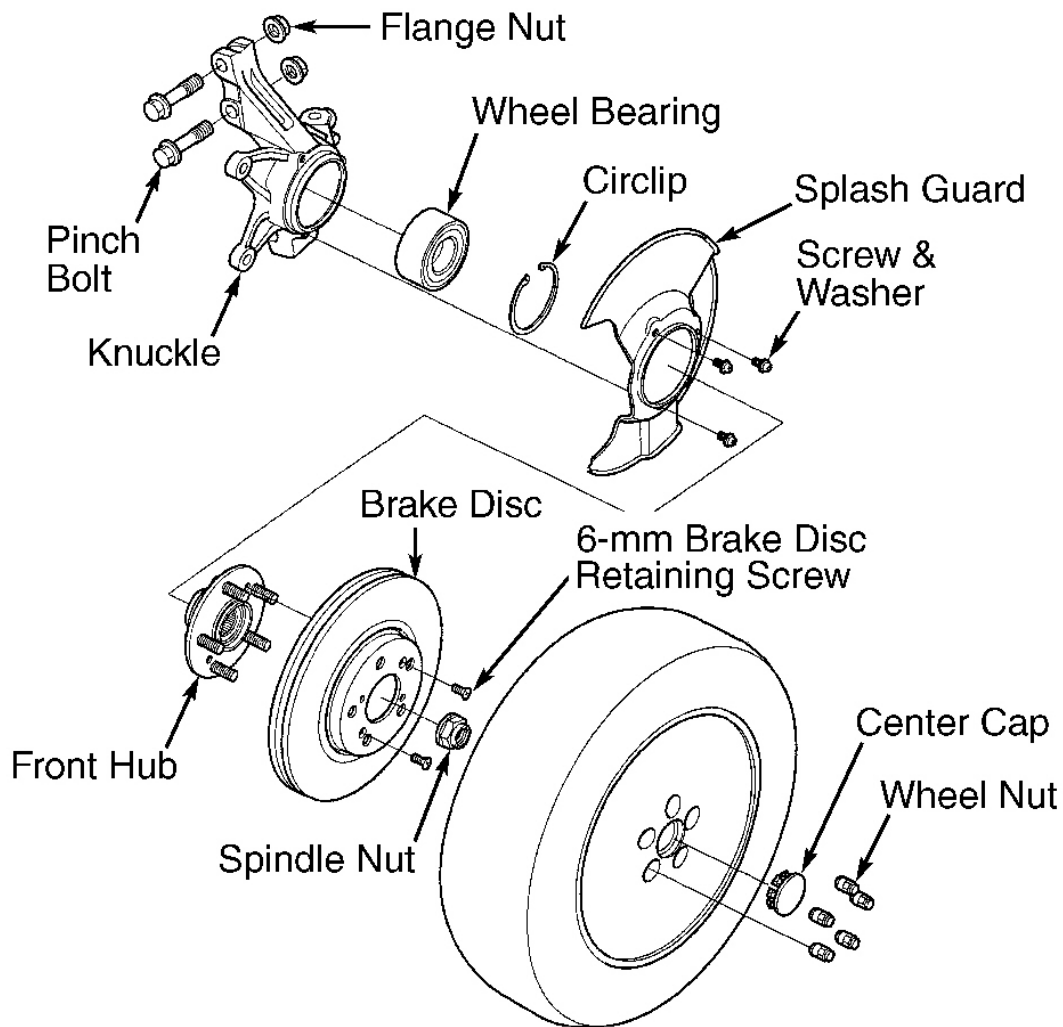

G00015924

**Fig. 4: Exploded View Of Steering Knuckle (Odyssey)**  
Courtesy of AMERICAN HONDA MOTOR CO., INC.

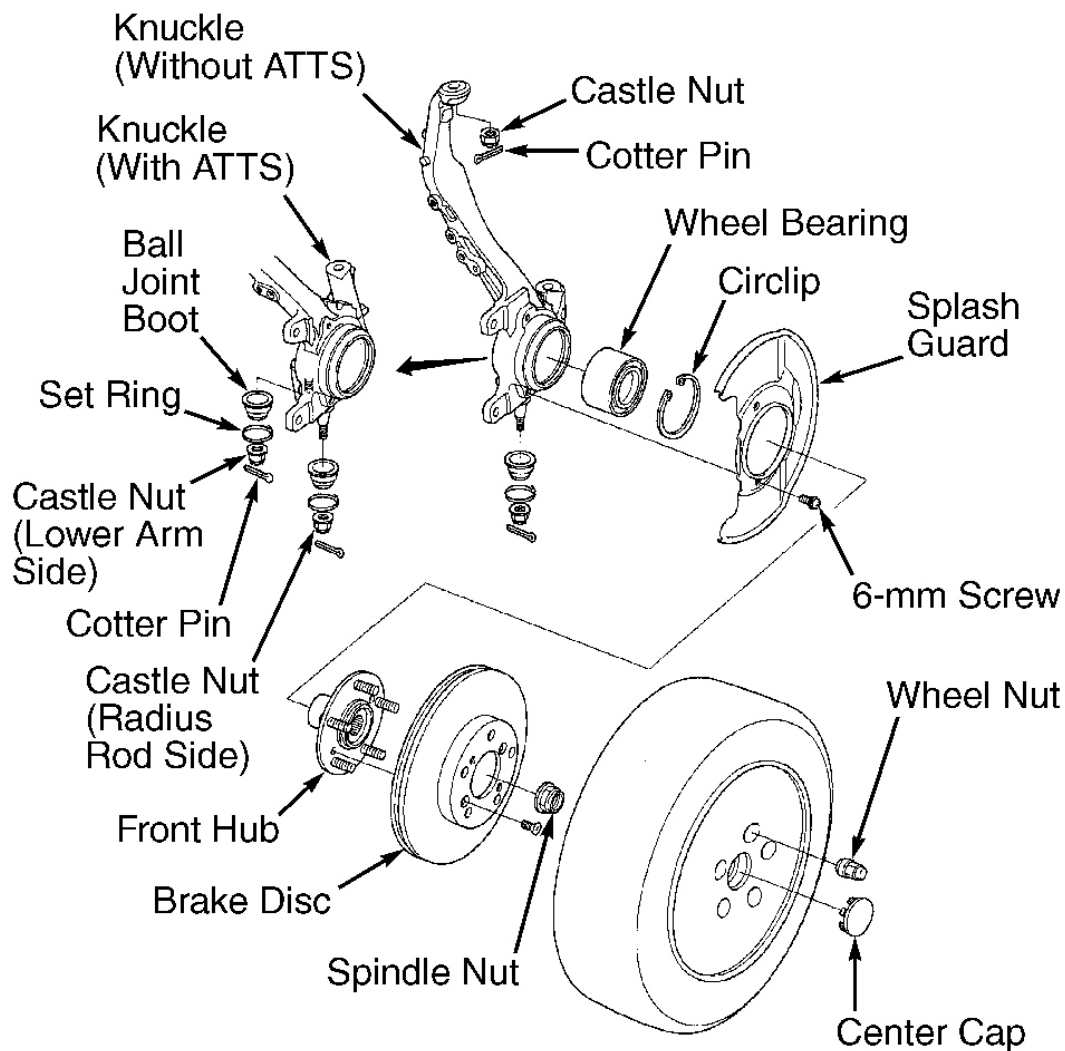

G00015925

**Fig. 5: Exploded View Of Steering Knuckle (Prelude)**  
Courtesy of AMERICAN HONDA MOTOR CO., INC.

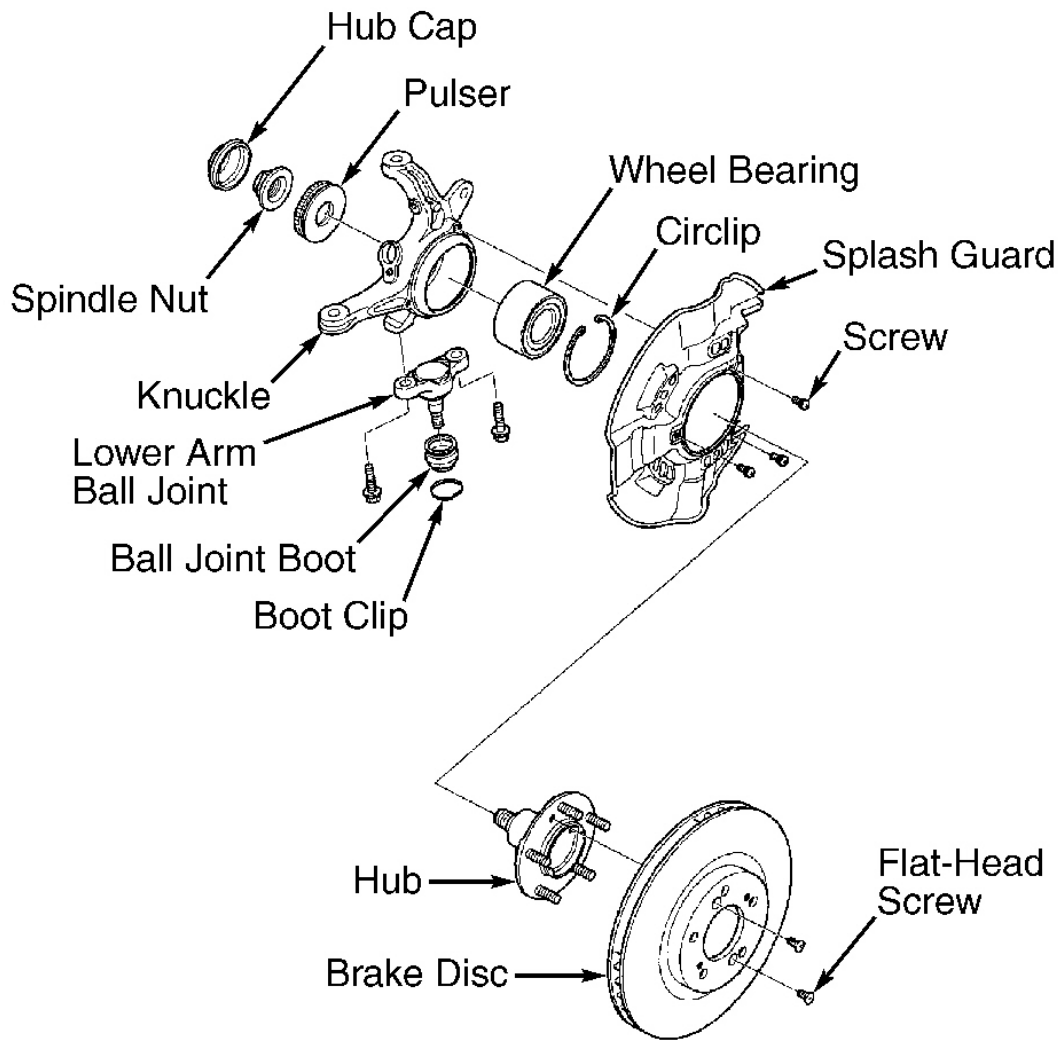

G00015927

**Fig. 6: Exploded View Of Steering Knuckle (S2000)**  
Courtesy of AMERICAN HONDA MOTOR CO., INC.