

# 1 Fuses

## 1.1 Overview of Fuses

### 1 - Fuses (SD) (on fuse panel D)

- Location through April 2008 ⇒ [page 39](#)
- Fuse Arrangements through April 2008 ⇒ [page 40](#)
- Location from May 2008 ⇒ [page 45](#)
- Fuse Arrangements from May 2008 ⇒ [page 46](#)

### 2 - Fuses (SF) on fuse panel F

- Location ⇒ [page 48](#)
- Fuse Arrangements ⇒ [page 49](#)

### 3 - Fuse 2 - terminal 30 -S205-

- Component Location ⇒ [page 50](#)
- Fuse rating ⇒ [page 50](#)

### 4 - Fuses (SC) on fuse panel C

- Location through April 2008 ⇒ [page 25](#)
- Fuse Arrangements through April 2008 ⇒ [page 26](#)
- Location from May 2008 ⇒ [page 32](#)
- Fuse Arrangements from May 2008 ⇒ [page 33](#)

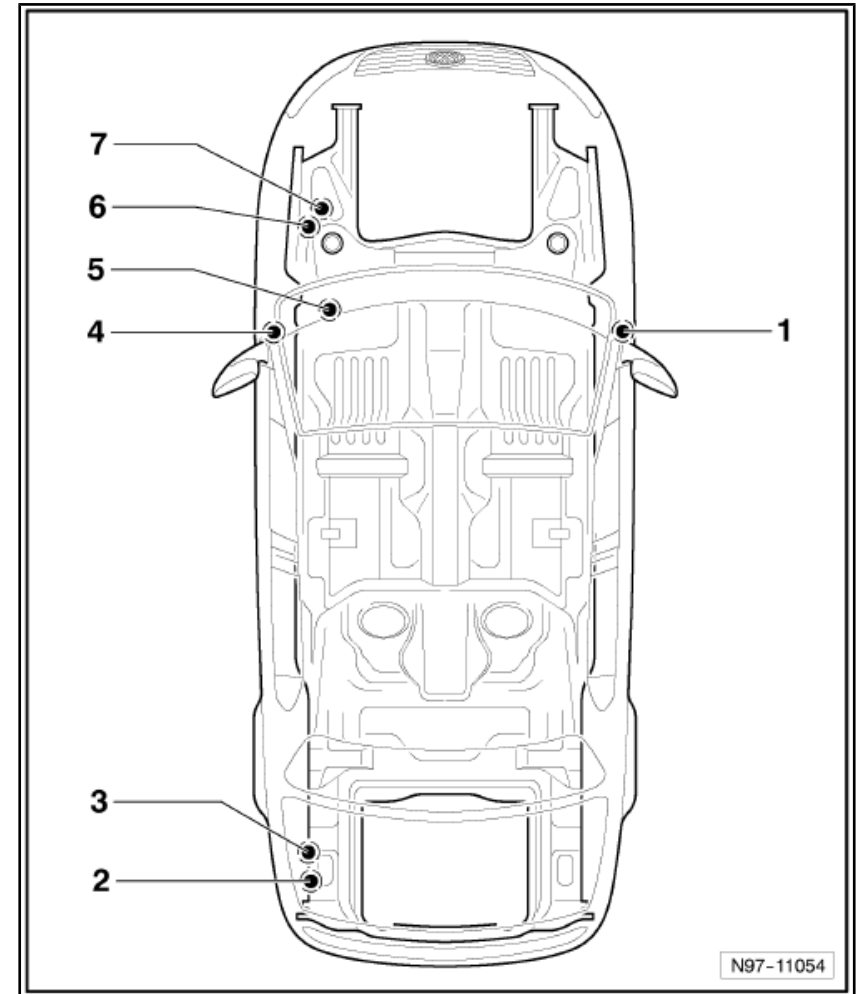

N97-11054

**5 - Safety Cutout, under left instrument panel**

- ❑ Component Location: Driver's Power Seat Adjustment Circuit Breaker 1 (15A) -S44- ⇒ [page 47](#)
- ❑ Component Location: Front Passenger's Power Seat Adjustment Circuit Breaker 1 (30A) -S46- ⇒ [page 47](#)

**6 - Fuses (SB) on fuse panel B**

- ❑ Location Electronics Box (not for AXX, AXZ, BLV, BPY, BWA) through 04.2005 ⇒ [page 7](#)
- ❑ Fuse Arrangements (not for AXX, AXZ, BLV, BPY, BWA) through 04.2005 ⇒ [page 8](#)
- ❑ Location Electronics Box High ⇒ [page 14](#)
- ❑ Fuse Arrangements Electronics Box High ⇒ [page 15](#)
- ❑ Location Electronics Box Low from 05/2005 ⇒ [page 20](#)
- ❑ Fuse Arrangements Electronics Box Low from 05/2005 ⇒ [page 21](#)

**7 - Fuses (SA) on fuse panel A**

- ❑ Location Electronics Box High ⇒ [page 3](#)
- ❑ Fuse arrangements Electronics Box High ⇒ [page 4](#)
- ❑ Location Electronics Box Low ⇒ [page 5](#)
- ❑ Fuse arrangements Electronics Box Low ⇒ [page 6](#)

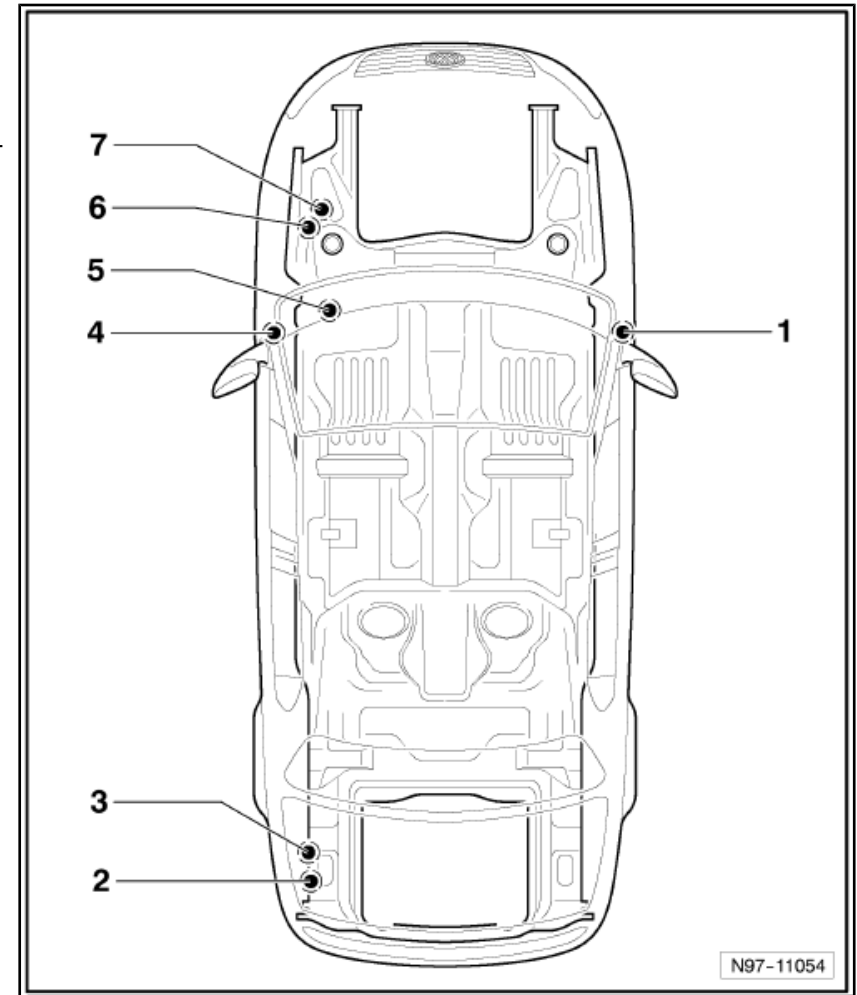

**1.2 Fuses (SA) on fuse panel on electronics box, in engine compartment, left (High box)**

**1.2.1 Torque Settings**

⇒ Electrical System, Repair Group 97, Removing and Installing Fuse Panel

**Fuse Colours**

30 A - green

25 A - white

20 A - yellow

15 A - blue

10 A - red

7,5 A - brown

5 A - beige

3 A - purple

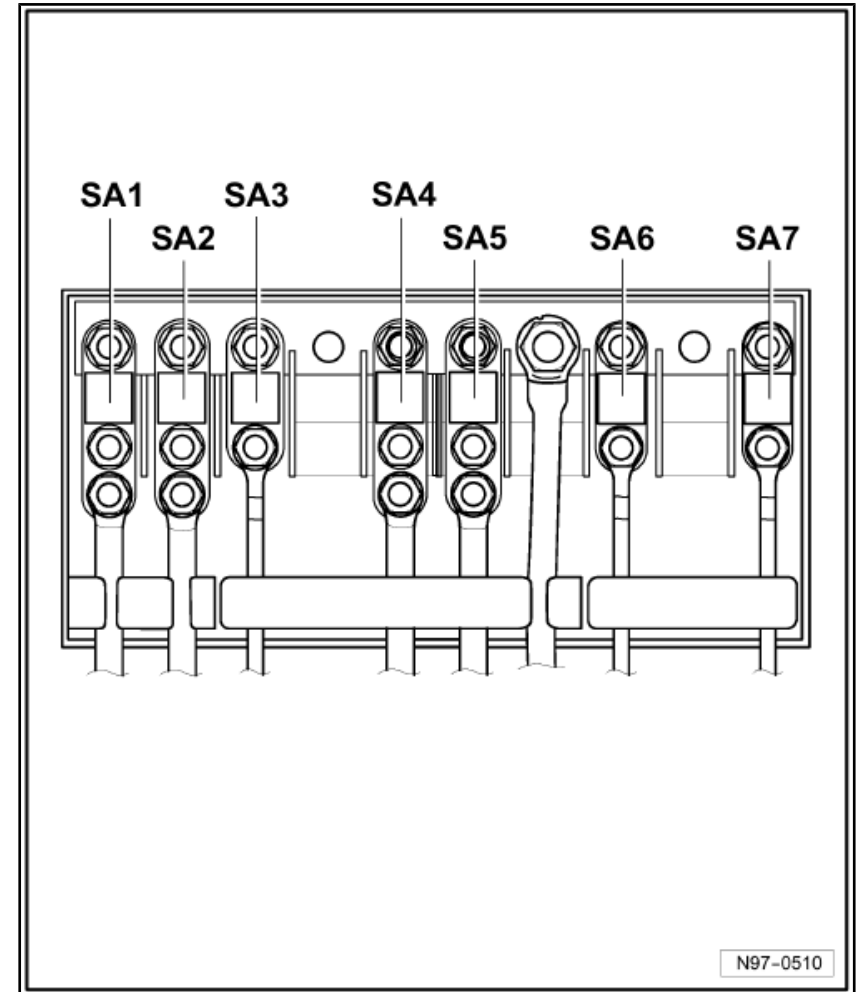

1.3 Fuse arrangements on fuse panel on electronics box, in engine compartment, left (High box)

No.	Designation in Wiring Diagram	Nominal Value	Function/Component	Terminal
1	- SA1 - Fuse 1 (on fuse panel A)	150A 180A <sup>1)</sup>	- C -Generator (GEN)	30
2	- SA2 - Fuse 2 (on fuse panel A)	80A	- V187 - Electro-mechanical Power Steering Motor	30
3	- SA3 - Fuse 3 (on fuse panel A)	80A 50A <sup>2)</sup>	- J293 - Coolant Fan Control (FC) Control Module	30
4	- SA4 - Fuse 4 (on fuse panel A)	100A <sup>4)</sup> 80A <sup>3)</sup>	- Auxiliary Fuses on Relay Carrier (S44 and S46) <sup>4)</sup> - Left Fuse Carrier (SC32 - SC37) <sup>4)</sup> - Right Fuse Carrier (SD32 - SD37) <sup>4)</sup> - Left Fuse Carrier (SC12 - SC17, SC29 - SC31) <sup>3)</sup> - Right Fuse Carrier (SD12 - SD17, SD28, SD29 - SD31) <sup>3)</sup>	30
5	- SA5 - Fuse 5 (on fuse panel A)	80A	- Right Fuse Carrier (SD22 - SD27) - Auxiliary Fuses on Relay Carrier (S44 and S46) <sup>3)</sup>	30
6	- SA6 - Fuse 6 (on fuse panel A)	100A <sup>4)</sup> 80A <sup>3)</sup>	- Left Fuse Carrier (SC12 - SC17, SC29 - SC31) <sup>4)</sup> - Right Fuse Carrier (SD12 - SD17, SD28, SD29 - SD31) <sup>4)</sup> - Left Fuse Carrier (SC32 - SC37) <sup>3)</sup>	30
7	- SA7 - Fuse 8 (on fuse panel A)	40A	- J104 - ABS Control Module	30

1) Only models with 180 A generator, installed in generator wiring

2) Only models from November 2005

3) Only models from May 2006

4) Only models through April 2006

**1.4 Fuses (SA) on fuse panel on electronics box, in engine compartment, left (Low box)**

**1.4.1 Torque Settings**

⇒ Electrical System, Repair Group 97, Removing and Installing Fuse Panel

**Fuse Colours**

30 A - green

25 A - white

20 A - yellow

15 A - blue

10 A - red

7,5 A - brown

5 A - beige

3 A - purple

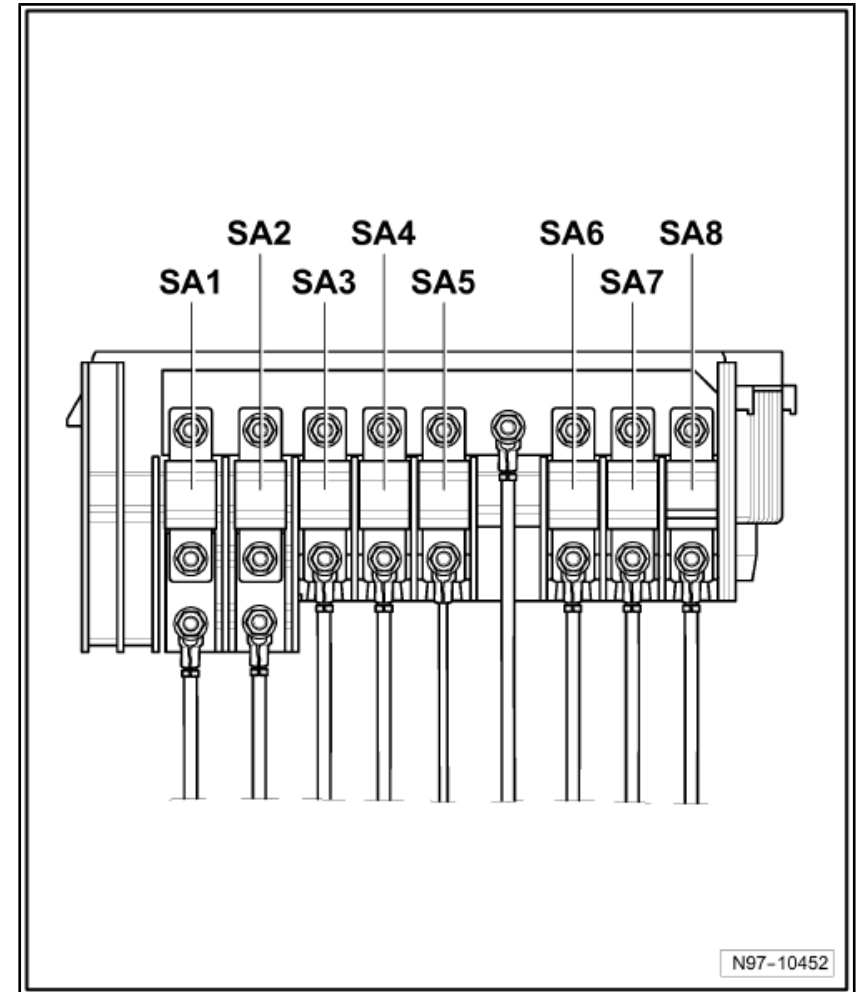

**1.5 Fuse arrangements on fuse panel on electronics box, in engine compartment, left (Low box)**

No.	Designation in Wiring Diagram	Nominal Value	Function/Component	Terminal
1	- SA1 - Fuse 1 (on fuse panel A)	150A	- C -Generator (GEN)	30
2	- SA2 - Fuse 2 (on fuse panel A)	80A	- V187 - Electro-mechanical Power Steering Motor	30
3	- SA3 - Fuse 3 (on fuse panel A)	50A <sup>1)</sup> 80A	- J293 - Coolant Fan Control (FC) Control Module	30
4	- SA4 - Fuse 4 (on fuse panel A)	100A	- Auxiliary Fuses on Relay Carrier (S44 and S46) <sup>3)</sup> - Left Fuse Carrier (SC32 - SC37) <sup>3)</sup> - Right Fuse Carrier (SD32 - SD37) <sup>3)</sup> - Left Fuse Carrier (SC12 - SC17, SC29 - SC31) <sup>2)</sup> - Right Fuse Carrier (SD12 - SD17, SD28, SD29 - SD31) <sup>2)</sup>	30
5	- SA5 - Fuse 5 (on fuse panel A)	80A	- Right Fuse Carrier (SD22 - SD27) - Auxiliary Fuses on Relay Carrier (S44 and S46) <sup>2)</sup>	30
6	- SA6 - Fuse 6 (on fuse panel A)	100A <sup>3)</sup> 80A <sup>2)</sup>	- Left Fuse Carrier (SC12 - SC17, SC29 - SC31) <sup>3)</sup> - Right Fuse Carrier (SD12 - SD17, SD28, SD29 - SD31) <sup>3)</sup> - Left Fuse Carrier (SC32 - SC37) <sup>2)</sup>	30
7	- SA7 - Fuse 7 (on fuse panel A)	60A 100A	- Auxiliary battery charge cable Z35 - Auxiliary Air Heater Heating Element J360 - Preheating Coolant, High Heat Output Relay <sup>4)</sup>	30
8	- SA8 - Fuse 8 (on fuse panel A)	40A	- J104 - ABS Control Module	30

<sup>1)</sup> Only models from November 2005

<sup>2)</sup> Only models from May 2006

<sup>3)</sup> Only models through April 2006

<sup>4)</sup> Only models from November 2006

**1.6 Fuses (SB) on electronics box, in engine compartment, left (not for AXX, AXZ, BLV, BPY, BWA) through 04.2005**

**1.6.1 Fuse Colours**

- 30 A - green
- 25 A - white
- 20 A - yellow
- 15 A - blue
- 10 A - red
- 7,5 A - brown
- 5 A - beige
- 3 A - purple

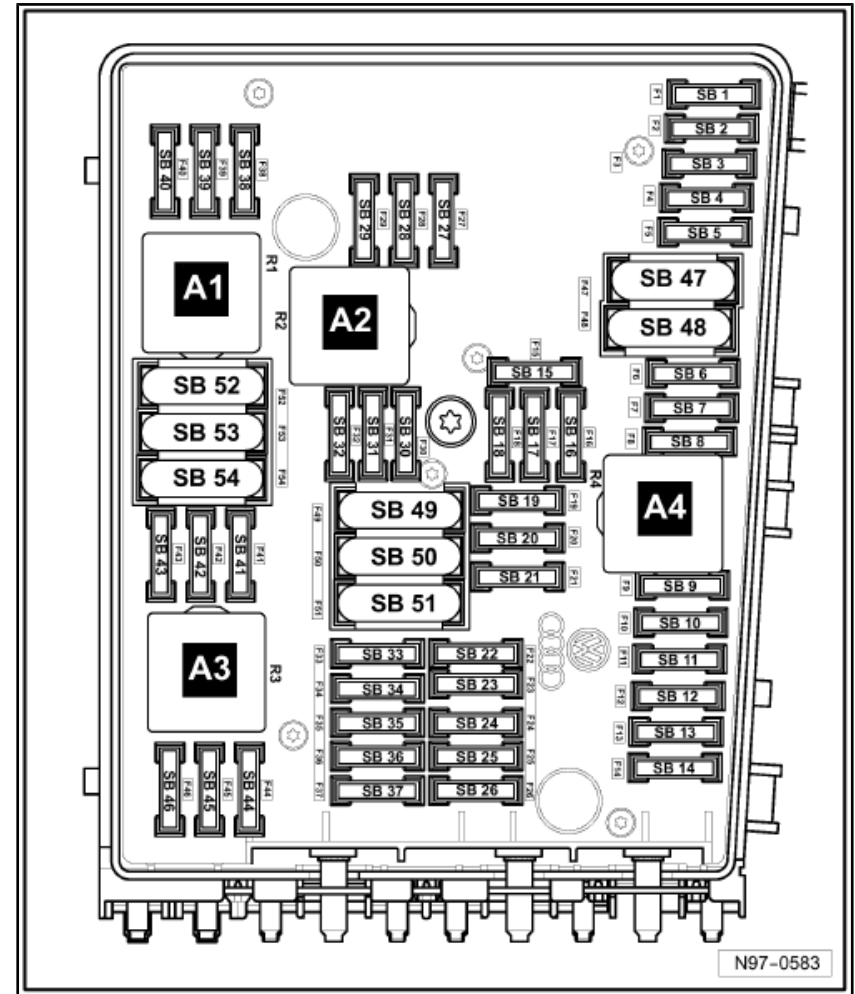

**1.7 Fuse arrangements on electronics box, in engine compartment, left (not for AXX, AXZ, BLV, BPY, BWA) through 04.2005**

No.	Designation in Wiring Diagram	Nominal Value	Function/Component	Terminal
F1	- SB1 - Fuse 1 (on fuse panel B)	5A 15A	- J217 -Transmission Control Module (TCM) J743 - Direct Shift Gearbox (DSG) Mechatronic	30
F2	- SB2 - Fuse 2 (on fuse panel B)	30A	- J104 - ABS Control Module	30
F3	- SB3 - Fuse 3 (on fuse panel B)	20A	- J393 - Comfort System Central Control Module	30
F4	- SB4 - Fuse 4 (on fuse panel B)	5A	- J519 - Vehicle Electrical System Control Module	30
F5	- SB5 - Fuse 5 (on fuse panel B)	20A	- H2 - High Tone Horn H7 - Low Tone Horn	30
F6	- SB6 - Fuse 6 (on fuse panel B)		- - Not used	30
F7	- SB7 - Fuse 7 (on fuse panel B)		- - Not used	30
F8	- SB8 - Fuse 8 (on fuse panel B)		- - Not used	87
F9	- SB9 - Fuse 9 (on fuse panel B)		- - Not used	87
F10	- SB10 - Fuse 10 (on fuse panel B)		- - Not used	87
F11	- SB11 - Fuse 11 (on fuse panel B)		- - Not used	87
F12	- SB12 - Fuse 12 (on fuse panel B)		- - Not used	87
F13	- SB13 - Fuse 13 (on fuse panel B)		- - Not used	30
F14	- SB14 - Fuse 14 (on fuse panel B)		- - Not used	30



No.	Designation in Wiring Diagram	Nominal Value	Function/Component	Terminal
F15	- SB15 - Fuse 15 (on fuse panel B)		- - Not used	87
F16	- SB16 - Fuse 16 (on fuse panel B)	10A	- J527 - Steering Column Electronic Systems Control Module	30
F17	- SB17 - Fuse 17 (on fuse panel B)	5A	- J285 - Instrument Cluster Control Module	30
F18	- SB18 - Fuse 18 (on fuse panel B)	30A	- R12 - Amplifier J608 - Special Purpose Vehicle Control Module	30
F19	- SB19 - Fuse 19 (on fuse panel B)	15A	- R - Radio J503 - Radio/Navigation Display Control Module J506 - TV/Radio/Navigation Display/Control Module (Japan)	30
F20	- SB20 - Fuse 20 (on fuse panel B)	5A	- J515 - Antenna Selection Control Module J412 - Operating Electronics and Telephone Control Module	30
F21	- SB21 - Fuse 21 (on fuse panel B)		- - Not used	30
F22	- SB22 - Fuse 22 (on fuse panel B)		- - Not used	30
F23	- SB23 - Fuse 23 (on fuse panel B)	10A	- J329 - Power Supply Relay (terminal 15) J623 - Engine Control Module (ECM) (BLF, BLR, BLY, BVY, BVZ)	30
F24	- SB24 - Fuse 24 (on fuse panel B)	10A	- J533 - Data Bus On Board Diagnostic Interface	30
F25	- SB25 - Fuse 25 (on fuse panel B)		- - Not used	30

No.	Designation in Wiring Diagram	Nominal Value	Function/Component	Terminal
F26	- SB26 - Fuse 26 (on fuse panel B)	10A	- J317 - Power Supply Relay (terminal 30)	30
F27	- SB27 - Fuse 27 (on fuse panel B)	20A 10A <sup>1)</sup>	- N...-Ignition Coils with Power Output Stages (cylinder 1 - 4) (BLF, BLR, BLY, BVY, BVZ) N152 - Ignition transformer (BSE, BSF) J49 - Fuel Pump (FP) 2 Relay (BKC, BMP) J179 - Automatic Glow Time Control Module (BKC, BMP, BMA, BKP, BLS)	87
F28	- SB28 - Fuse 28 (on fuse panel B)	25A 30A <sup>1)</sup>	- J623 - Engine Control Module (ECM)	87
F29	- SB29 - Fuse 29 (on fuse panel B)	15A 10A <sup>1)</sup>	- J299 - Secondary Air Injection (AIR) Pump Relay (BSE, BSF) N18 - EGR Vacuum Regulator Solenoid Valve (BKC, BKP, BMA) N75 - Wastegate Bypass Regulator Valve (BKC, BMP, BKP, BMA, BLS) N345 - Exhaust Gas Recirculation (EGR) Cooler Switch-Over Valve (BKC, BMP, BKP, BMA, BLS) Z19 - Oxygen Sensor (O2S) Heater (BLF, BLR, BLY, BVY, BVZ) Z28 - Oxygen Sensor (O2S) Heater 2 (BLR, BVY, BVZ) Z29 - Oxygen Sensor (O2S) Heater 1 (behind Three Way Catalytic Converter (TWC) (BLF)	87
F30	- SB30 - Fuse 30 (on fuse panel B)	20A	- J364 - Auxiliary Heater Control Module	30
F31	- SB31 - Fuse 31 (on fuse panel B)	30A	- J400 - Wiper Motor Control Module	30

<sup>1)</sup> Only diesel engines

No.	Designation in Wiring Diagram	Nominal Value	Function/Component	Terminal
F32	- SB32 - Fuse 32 (on fuse panel B)		- - Not used	87
F33	- SB33 - Fuse 33 (on fuse panel B)		- - Not used	87
F34	- SB34 - Fuse 34 (on fuse panel B)		- - Not used	87
F35	- SB35 - Fuse 35 (on fuse panel B)		- - Not used	30
F36	- SB36 - Fuse 36 (on fuse panel B)		- - Not used	30
F37	- SB37 - Fuse 37 (on fuse panel B)		- - Not used	30
F38	- SB38 - Fuse 38 (on fuse panel B)	10A	- J293 - Coolant Fan Control (FC) Control Module F265 - Map Controlled Engine Cooling Thermostat (BLY, BLR, BVY, BVZ) N18 - EGR Vacuum Regulator Solenoid Valve (BSE, BSF) N80 - Evaporative Emission (EVAP) Canister Purge Regulator Valve 1 (BLF, BLR, BLY, BSE, BSF, BVY, BVZ) N205 - Camshaft Adjustment Valve 1 (BLF, BLR, BLY, BVY, BVZ) N316 - Intake Manifold Runner Control (IMRC) Valve (BLF, BLR, BLY, BSE, BSF, BVY, BVZ) V157 - Intake Flap Motor (BKC, BKP, BMA)	87
F39	- SB39 - Fuse 39 (on fuse panel B)	15A	- N276 - Fuel Pressure Regulator Valve (BLF, BLR, BLY, BVY, BVZ) G476 - Clutch Position Sensor (BLF, BKC, BMP, BKP, BMA, BLS)	87

No.	Designation in Wiring Diagram	Nominal Value	Function/Component	Terminal
F40	- SB40 - Fuse 40 (on fuse panel B)	15A 10A <sup>1)</sup>	- J583 - NOX Sensor Control Module (BLR, BLY, BVY, BVZ) Z19 - Oxygen Sensor (O2S) Heater (BMP, BLS, BSE, BSF) Z29 - Oxygen Sensor (O2S) Heater 1 (behind Three Way Catalytic Converter (TWC)) (BLF, BLR, BLY, BSE, BSF, BVY, BVZ) Z30 - Oxygen Sensor (O2S) Heater 2 (behind Three Way Catalytic Converter (TWC)) (BLR, BVY) Z64 - Oxygen Sensor (O2S) Heater 3 (behind Three Way Catalytic Converter (TWC)) (BLR, BLY, BVY, BVZ)	87
F41	- SB41 - Fuse 41 (on fuse panel B)		- - Not used	
F42	- SB42 - Fuse 42 (on fuse panel B)		- - Not used	
F43	- SB43 - Fuse 43 (on fuse panel B)		- - Not used	
F44	- SB44 - Fuse 44 (on fuse panel B)		- - Not used	
F45	- SB45 - Fuse 45 (on fuse panel B)		- - Not used	
F46	- SB46 - Fuse 46 (on fuse panel B)		- - Not used	
F47	- SB47 - Fuse 47 (on fuse panel B)	40A	- J519 - Vehicle Electrical System Control Module, Right Parking Lamp, Left Low Beam Headlamp, Left High Beam Headlamp, Left Taillamp (outer Illumination Ring), Right Taillamp (inner Illumination Ring)	30

<sup>1)</sup> Only diesel engines and engine code BLY

No.	Designation in Wiring Diagram	Nominal Value	Function/Component	Terminal
F48	- SB48 - Fuse 48 (on fuse panel B)	40A	- J519 - Vehicle Electrical System Control Module, Left Parking Lamp, Right Low Beam Headlamp, Right High Beam Headlamp, Right Taillamp (outer Illumination Ring), Left Taillamp (inner Illumination Ring)	30
F49	- SB49 - Fuse 49 (on fuse panel B)	50A	- J519-Vehicle Electrical System Control Module (Supply Terminal 15)	30
F50	- SB50 - Fuse 50 (on fuse panel B)	60A	- J713-Second Battery Charge Relay	30
F51	- SB51 - Fuse 51 (on fuse panel B)		- - Not used	
F52	- SB52 - Fuse 52 (on fuse panel B)	60A	- Z2 -Heated Windshield	30
F53	- SB53 - Fuse 53 (on fuse panel B)	50A	- J519-Vehicle Electrical System Control Module (Supply Terminal 75) Left Fuse Carrier (SC40 - SC42, SD39)	30
F54	- SB54 - Fuse 54 (on fuse panel B)	50A	- J179 - Automatic Glow Time Control Module (BMA, BMP, BKC, BKP, BLS) V101 - Secondary Air Injection (AIR) Pump Motor (BSE, BSF)	30

**1.8 Fuses (SB) on Electronics Box High, engine compartment, left (High box)**

**1.8.1 Fuse Colours**

- 30 A - green
- 25 A - white
- 20 A - yellow
- 15 A - blue
- 10 A - red
- 7,5 A - brown
- 5 A - beige
- 3 A - purple

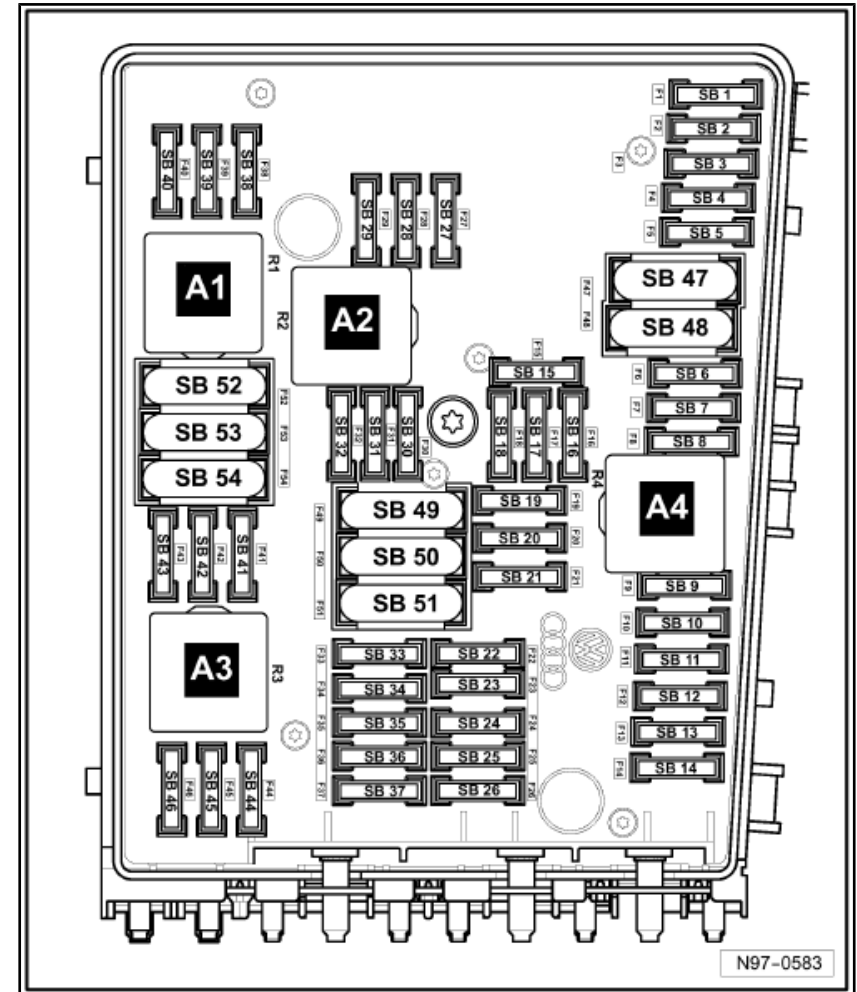

**1.9 Fuse Arrangements on Electronics Box, engine compartment, left (High box)**

No.	Designation in Wiring Diagram	Nominal Value	Function/Component	Terminal
F1	- SB1 - Fuse 1 (on fuse panel B)	5A 15A	- J217 - Transmission Control Module (TCM) J743 - Direct Shift Gearbox (DSG) Mechatronic	30
F2	- SB2 - Fuse 2 (on fuse panel B)	30A	- J104 - ABS Control Module	30
F3	- SB3 - Fuse 3 (on fuse panel B)	20A	- J393 - Comfort System Central Control Module (through April 2006) J345 - Towing Recognition Control Module (from May 2006)	30
F4	- SB4 - Fuse 4 (on fuse panel B)	5A	- J519 - Vehicle Electrical System Control Module	30
F5	- SB5 - Fuse 5 (on fuse panel B)	20A	- H2 - High Tone Horn H7 - Low Tone Horn	30
F6	- SB6 - Fuse 6 (on fuse panel B)	20A	- N...-Ignition Coils with Power Output Stage (AXX, AXZ, BPY, BLV, BWA)	87
F7	- SB7 - Fuse 7 (on fuse panel B)	15A 5A	- N276 - Fuel Pressure Regulator Valve (AXZ, BLV) G476 - Clutch Position Sensor (AXX, BPY, BWA)	87
F8	- SB8 - Fuse 8 (on fuse panel B)	10A	- J293 - Coolant Fan Control (FC) Control Module N80 - Evaporative Emission (EVAP) Canister Purge Regulator Valve 1 (AXZ, BLV) N205 - Camshaft Adjustment Valve 1 (AXZ, AXX, BLV, BPY, BWA) N316 - Intake Manifold Runner Control (IMRC) Valve (AXZ, BLV) N318 - Camshaft Adjustment Valve 1 (exhaust) (AXZ, BLV) N401 - Vacuum Booster Pump Valve (AXZ, BLV)	87
F9	- SB9 - Fuse 9 (on fuse panel B)	5A	- J160 - Recirculation Pump Relay (AXX, AXZ, BLV, BPY, BWA)	87
F10	- SB10 - Fuse 10 (on fuse panel B)	10A	- J670-Motronic Engine Control Module (ECM) Power Supply Relay 2 (AXX, BPY, BWA)	87

No.	Designation in Wiring Diagram	Nominal Value	Function/Component	Terminal
F11	- SB11 - Fuse 11 (on fuse panel B)	25A 30A <sup>1)</sup>	- J623 - Engine Control Module (ECM)	87
F12	- SB12 - Fuse 12 (on fuse panel B)		- - Not used	87
F13	- SB13 - Fuse 13 (on fuse panel B)		- - Not used	30
F14	- SB14 - Fuse 14 (on fuse panel B)		- - Not used	
F15	- SB15 - Fuse 15 (on fuse panel B)	10A	- V55 -Recirculation Pump (AXZ, AXX, BPY, BLV, BWA)	87
F16	- SB16 - Fuse 16 (on fuse panel B)	5A	- J527 - Steering Column Electronic Systems Control Module	30
F17	- SB17 - Fuse 17 (on fuse panel B)	5A	- J285 - Instrument Cluster Control Module	30
F18	- SB18 - Fuse 18 (on fuse panel B)	30A	- R12 - Amplifier J608 - Special Purpose Vehicle Control Module (Taxi, Police)	30
F19	- SB19 - Fuse 19 (on fuse panel B)	15A	- R - Radio J503 - Radio/Navigation Display Control Module J506 - TV/Radio/Navigation Display/Control Module (Japan)	30
F20	- SB20 - Fuse 20 (on fuse panel B)	5A	- J515 - Antenna Selection Control Module (through April 2006) R36 - Telephone Transceiver (through April 2006) E508 - Cellular Telephone Preparation Control Head (from May 2006) J412 - Operating Electronics and Telephone Control Module (from May 2006)	30

<sup>1)</sup> Only diesel engines



No.	Designation in Wiring Diagram	Nominal Value	Function/Component	Terminal
F21	- SB21 - Fuse 21 (on fuse panel B)	10A	- R78 -TV Tuner R190 - Digital Satellite Radio Tuner	30
F22	- SB22 - Fuse 22 (on fuse panel B)	7,5A	- J650 -Multimedia Control Module	30
F23	- SB23 - Fuse 23 (on fuse panel B)	10A 5A	- J293 - Coolant Fan Control (FC) Control Module G197 - Magnetic Field Sensor for Compass <sup>1)</sup>	30
F24	- SB24 - Fuse 24 (on fuse panel B)	10A	- J533 - Data Bus On Board Diagnostic Interface	30
F25	- SB25 - Fuse 25 (on fuse panel B)		- - Not used	
F26	- SB26 - Fuse 26 (on fuse panel B)	10A	- J271 - Motronic Engine Control Module (ECM) Power Supply Relay (AXX, AXZ, BLV, BPY, BWA) J623 - Engine Control Module (ECM)	30
F27	- SB27 - Fuse 27 (on fuse panel B)		- - Not used	
F28	- SB28 - Fuse 28 (on fuse panel B)		- - Not used	
F29	- SB29 - Fuse 29 (on fuse panel B)		- - Not used	
F30	- SB30 - Fuse 30 (on fuse panel B)	20A	- J364 - Auxiliary Heater Control Module	30
F31	- SB31 - Fuse 31 (on fuse panel B)	30A	- V - Windshield Wiper Motor	30

<sup>1)</sup> Applicable from May 2006

No.	Designation in Wiring Diagram	Nominal Value	Function/Component	Terminal
F32	- SB32 - Fuse 32 (on fuse panel B)	10A	- N75 - Wastegate Bypass Regulator Valve (AXX, BPY, BWA) N80 - Evaporative Emission (EVAP) Canister Purge Regulator Valve 1 (AXX, BPY, BWA) N249 - Turbocharger Recirculating Valve (AXX, BPY, BWA)	87
F33	- SB33 - Fuse 33 (on fuse panel B)	15A	- N276 -Fuel Pressure Regulator Valve (AXX, BPY, BWA) Z19 - Heated Oxygen Sensor (HO2S) (AXZ, BLV) Z28 - Heated Oxygen Sensor (HO2S) 2 (AXZ, BLV)	87
F34	- SB34 - Fuse 34 (on fuse panel B)		- - Not used	
F35	- SB35 - Fuse 35 (on fuse panel B)		- - Not used	
F36	- SB36 - Fuse 36 (on fuse panel B)		- - Not used	
F37	- SB37 - Fuse 37 (on fuse panel B)		- - Not used	
F38	- SB38 - Fuse 38 (on fuse panel B)		- - Not used	
F39	- SB39 - Fuse 39 (on fuse panel B)		- - Not used	
F40	- SB40 - Fuse 40 (on fuse panel B)		- - Not used	
F41	- SB41 - Fuse 41 (on fuse panel B)		- - Not used	
F42	- SB42 - Fuse 42 (on fuse panel B)		- - Not used	
F43	- SB43 - Fuse 43 (on fuse panel B)		- - Not used	
F44	- SB44 - Fuse 44 (on fuse panel B)	10A	- V144-Leak Detection Pump (LDP) (AXZ, BLV, BPY)	87

No.	Designation in Wiring Diagram	Nominal Value	Function/Component	Terminal
F45	- SB45 - Fuse 45 (on fuse panel B)	10A	- Z19 - Oxygen Sensor (O2S) Heater (AXX, BPY, BWA) Z29 - Oxygen Sensor (O2S) Heater 1 (behind Three Way Catalytic Converter (TWC)) (AXZ, BLV) Z30 - Oxygen Sensor (O2S) Heater 2 (behind Three Way Catalytic Converter (TWC)) (AXZ, BLV) Z92 - Oxygen Sensor (O2S) 3, Bank 1 - Heater (AXZ, BLV) Z93 - Oxygen Sensor (O2S) 3, Bank 2 - Heater (AXZ, BLV)	87
F46	- SB46 - Fuse 46 (on fuse panel B)	10A	- Z29-Oxygen Sensor (O2S) Heater 1 (behind Three Way Catalytic Converter (TWC)) (AXX, BPY, BWA)	87
F47	- SB47 - Fuse 47 (on fuse panel B)	40A	- J519 - Vehicle Electrical System Control Module, Right Parking Lamp, Left Low Beam and High Beam Lamp, Left Taillamp (outer Illumination Ring), Right Taillamp (inner Illumination Ring)	30
F48	- SB48 - Fuse 48 (on fuse panel B)	40A	- J519 - Vehicle Electrical System Control Module, Left Parking Lamp, Right Low Beam and High Beam Lamp, Right Taillamp (outer Illumination Ring), Left Taillamp (inner Illumination Ring)	30
F49	- SB49 - Fuse 49 (on fuse panel B)	50A	- J519-Vehicle Electrical System Control Module (Supply Terminal 15)	30
F50	- SB50 - Fuse 50 (on fuse panel B)	60A	- J713-Second Battery Charge Relay	30
F51	- SB51 - Fuse 51 (on fuse panel B)		- - Not used	
F52	- SB52 - Fuse 52 (on fuse panel B)	60A	- Z2 -Heated Windshield	30
F53	- SB53 - Fuse 53 (on fuse panel B)	50A	- J519-Vehicle Electrical System Control Module (Supply Terminal 75) - Left Fuse Carrier (SC40 - SC42, SD39)	30
F54	- SB54 - Fuse 54 (on fuse panel B)		- - Not used	30

1.10 Fuses (SB) on Electronics Box High, engine compartment, left (Low Box) from 05/2005

1.10.1 Fuse Colours

30 A - green

25 A - white

20 A - yellow

15 A - blue

10 A - red

7,5 A - brown

5 A - beige

3 A - purple

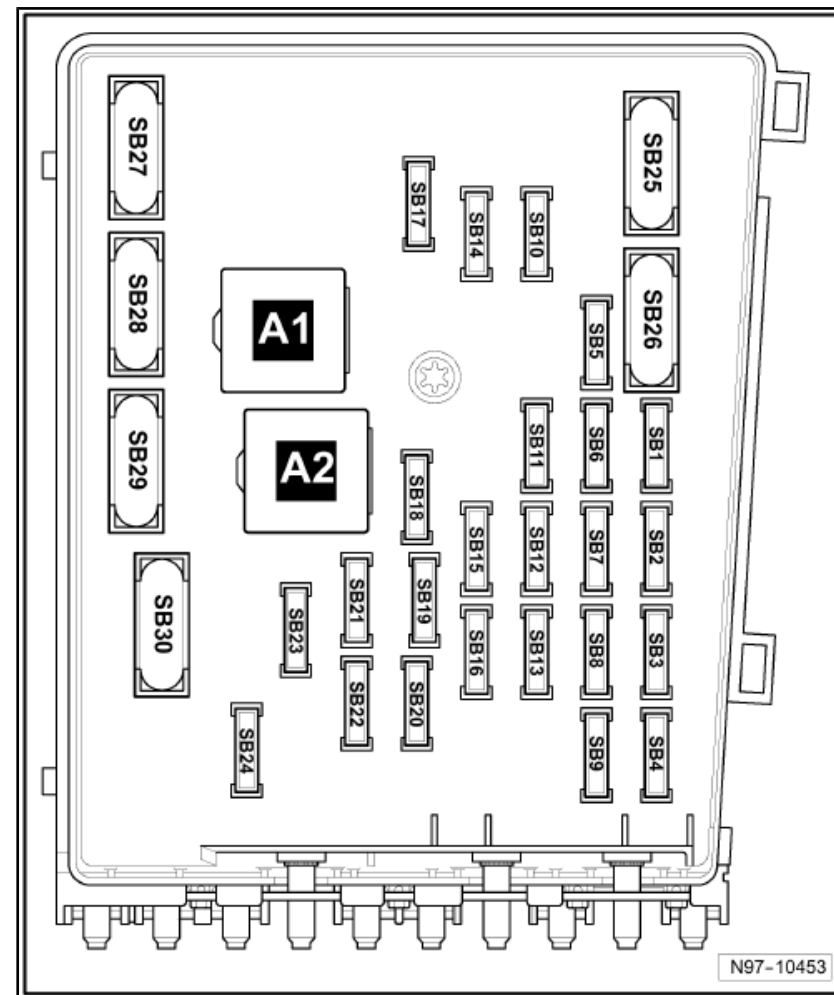

**1.11 Fuse Arrangements on Electronics Box High, engine compartment, left (Low Box) from 05/2005**

No.	Designation in Wiring Diagram	Nominal Value	Function/Component	Terminal
F1	- SB1 - Fuse 1 (on fuse panel B)	7,5A	- J650 -Multimedia Control Module	30
F2	- SB2 - Fuse 2 (on fuse panel B)	30A	- J104 - ABS Control Module	30
F3	- SB3 - Fuse 3 (on fuse panel B)	20A	- J519 - Vehicle Electrical System Control Module	30
F4	- SB4 - Fuse 4 (on fuse panel B)	20A 25A	- J393 - Comfort System Central Control Module (through April 2006) J345 - Towing Recognition Control Module (from May 2006)	30
F5	- SB5 - Fuse 5 (on fuse panel B)	5A	- J519 - Vehicle Electrical System Control Module	30
F6	- SB6 - Fuse 6 (on fuse panel B)	5A 15A	- J217 -Transmission Control Module (TCM) J743 - Direct Shift Gearbox (DSG) Mechatronic (BMP, BKP, BMA, BVE, BVW)	30
F7	- SB7 - Fuse 7 (on fuse panel B)	15A	- J503 - Radio/Navigation Display Control Module R - Radio J506 - TV/Radio/Navigation Display/Control Module (Japan)	30
F8	- SB8 - Fuse 8 (on fuse panel B)		- - Not used	
F9	- SB9 - Fuse 9 (on fuse panel B)	5A	- J527 - Steering Column Electronic Systems Control Module	30
F10	- SB10 - Fuse 10 (on fuse panel B)	20A	- J17 - Fuel Pump (FP) Relay <sup>1)</sup> J179 - Automatic Glow Time Control Module <sup>1)</sup> N... - Ignition Coils with Power Output Stages (cylinder 1 - 4) (BLF, BLR, BLX, BLY, BSE, BSF, BVX, BVY, BVZ)	87

<sup>1)</sup> Only diesel engines

No.	Designation in Wiring Diagram	Nominal Value	Function/Component	Terminal
F11	- SB11 - Fuse 11 (on fuse panel B)	5A	- J285 - Instrument Cluster Control Module	30
F12	- SB12 - Fuse 12 (on fuse panel B)	5A	- J412 - Operating Electronics and Telephone Control Module J515 - Antenna Selection Control Module (through April 2006) E508 - Cellular Telephone Preparation Control Head (from May 2006)	30
F13	- SB13 - Fuse 13 (on fuse panel B)	10A	- J271 - Motronic Engine Control Module (ECM) Power Supply Relay J317 - Power Supply Relay (terminal 30) (BMP, BKC, BMA, BKP, BVE, BVW, BLS, BMR, BUZ) J623 - Engine Control Module (ECM) (BLF, BLR, BLX, BLY, BVX, BVY, BVZ)	30
F14	- SB14 - Fuse 14 (on fuse panel B)	30A	- J623 - Engine Control Module (ECM)	87
F15	- SB15 - Fuse 15 (on fuse panel B)	10A	- J533 - Data Bus On Board Diagnostic Interface	30
F16	- SB16 - Fuse 16 (on fuse panel B)	10A <sup>1)</sup> 15A	- J299 - Secondary Air Injection (AIR) Pump Relay (BSE, BSF) N18 - EGR Vacuum Regulator Solenoid Valve <sup>2)</sup> N75 - Wastegate Bypass Regulator Valve <sup>2)</sup> N249 - Turbocharger Recirculating Valve <sup>2)</sup> N316 - Intake Manifold Runner Control (IMRC) Valve (BMR, BUZ) N345 - Exhaust Gas Recirculation (EGR) Cooler Switch-Over Valve <sup>2)</sup> Z19 - Oxygen Sensor (O2S) Heater (BLY, BLF, BLR, BLX, BVX, BVY, BVZ) Z28 - Oxygen Sensor (O2S) Heater 2 (BLR, BLX, BVX, BVY, BLF)	87
F17	- SB17 - Fuse 17 (on fuse panel B)	40A	- J359 - Preheating Coolant, Low Heat Output Relay <sup>3)</sup>	30

<sup>1)</sup> Only engine code BLY, BLF, BLR, BLX, BVX, BVY, BVZ

<sup>2)</sup> Only diesel engines

<sup>3)</sup> Applicable from November 2006

No.	Designation in Wiring Diagram	Nominal Value	Function/Component	Terminal
F18	- SB18 - Fuse 18 (on fuse panel B)	5A	- J359 - Preheating Coolant, Low Heat Output Relay <sup>2)</sup> J360 - Preheating Coolant, High Heat Output Relay <sup>2)</sup>	87
F19	- SB19 - Fuse 19 (on fuse panel B)	30A	- R12 - Amplifier - Special Purpose Vehicle	30
F20	- SB20 - Fuse 20 (on fuse panel B)	5A <sup>1)</sup> 15A	- G476 - Clutch Position Sensor (BSE, BSF, BLF, BMP, BKC, BMA, BKP, BVE, BVW, BLS, BMR, BUZ) N276 - Fuel Pressure Regulator Valve (BLF, BLR, BLX, BLY, BVX, BVY, BVZ)	87
F21	- SB21 - Fuse 21 (on fuse panel B)	20A	- J364 - Auxiliary Heater Control Module	30
F22	- SB22 - Fuse 22 (on fuse panel B)	30A	- J400 - Wiper Motor Control Module	30
F23	- SB23 - Fuse 23 (on fuse panel B)	10A	- F265 - Map Controlled Engine Cooling Thermostat (BLR, BLX, BLY, BVX, BVY, BVZ) J293 - Coolant Fan Control (FC) Control Module N80 - Evaporative Emission (EVAP) Canister Purge Regulator Valve 1 (BLF, BLR, BLX, BLY, BVX, BVY, BVZ, BSE, BSF) N156 - Intake Manifold Tuning (IMT) Valve (BLF, BLR, BLX, BLY, BVX, BVY, BVZ) N205 - Camshaft Adjustment Valve 1 (BLF, BLR, BLX, BLY, BVX, BVY, BVZ) N316 - Intake Manifold Runner Control (IMRC) Valve (BLF, BSE, BSF) V157 - Intake Flap Motor (BKC, BMA, BKP, BVE, BVW) Z19 - Heated Oxygen Sensor (HO2S) (BLS)	87

<sup>1)</sup> Only engine code BLY, BLF, BLR, BLX, BVX, BVY, BVZ

<sup>2)</sup> Applicable from November 2006

No.	Designation in Wiring Diagram	Nominal Value	Function/Component	Terminal
F24	- SB24 - Fuse 24 (on fuse panel B)	10A <sup>2)</sup> 15A	- J583 - NOx Sensor Control Module (BLX, BVY) Z19 - Oxygen Sensor (O2S) Heater (BLS, BMP, BMR, BUZ, BSE, BSF, BLY, BVZ) Z29 - Oxygen Sensor (O2S) Heater 1 (behind Three Way Catalytic Converter (TWC)) (BSE, BSF, BLY, BVZ, BMP, BUZ, BLR, BLX, BVX, BVY) Z30 - Oxygen Sensor (O2S) Heater 2 (behind Three Way Catalytic Converter (TWC)) (BLR, BLX) Z64 - Oxygen Sensor (O2S) Heater 3 (behind Three Way Catalytic Converter (TWC)) (BLR, BVY)	87
F25	- SB25 - Fuse 25 (on fuse panel B)	40A	- J519 - Vehicle Electrical System Control Module	30
F26	- SB26 - Fuse 26 (on fuse panel B)	40A	- J519 - Vehicle Electrical System Control Module	30
F27	- SB27 - Fuse 27 (on fuse panel B)	60A	- Z2 -Heated Windshield	30
F28	- SB28 - Fuse 28 (on fuse panel B)	40A 50A <sup>1)</sup>	- V101 - Secondary Air Injection (AIR) Pump Motor (BSE, BSF) J179 - Automatic Glow Time Control Module <sup>1)</sup>	30
F29	- SB29 - Fuse 29 (on fuse panel B)	50A	- J519 - Vehicle Electrical System Control Module	30
F30	- SB30 - Fuse 30 (on fuse panel B)	50A	- J519 - Vehicle Electrical System Control Module	30

<sup>1)</sup> Only diesel engines

<sup>2)</sup> Only engine code BLY, BLR, BVY, BVZ, BKC, BLS, BMP, BMR, BUZ



1.12 Fuses (SC) (on fuse panel C), instrument panel driver's door, through April 2008

1.12.1 Fuse Colours

- 30 A - green
- 25 A - white
- 20 A - yellow
- 15 A - blue
- 10 A - red
- 7,5 A - brown
- 5 A - beige
- 3 A - purple

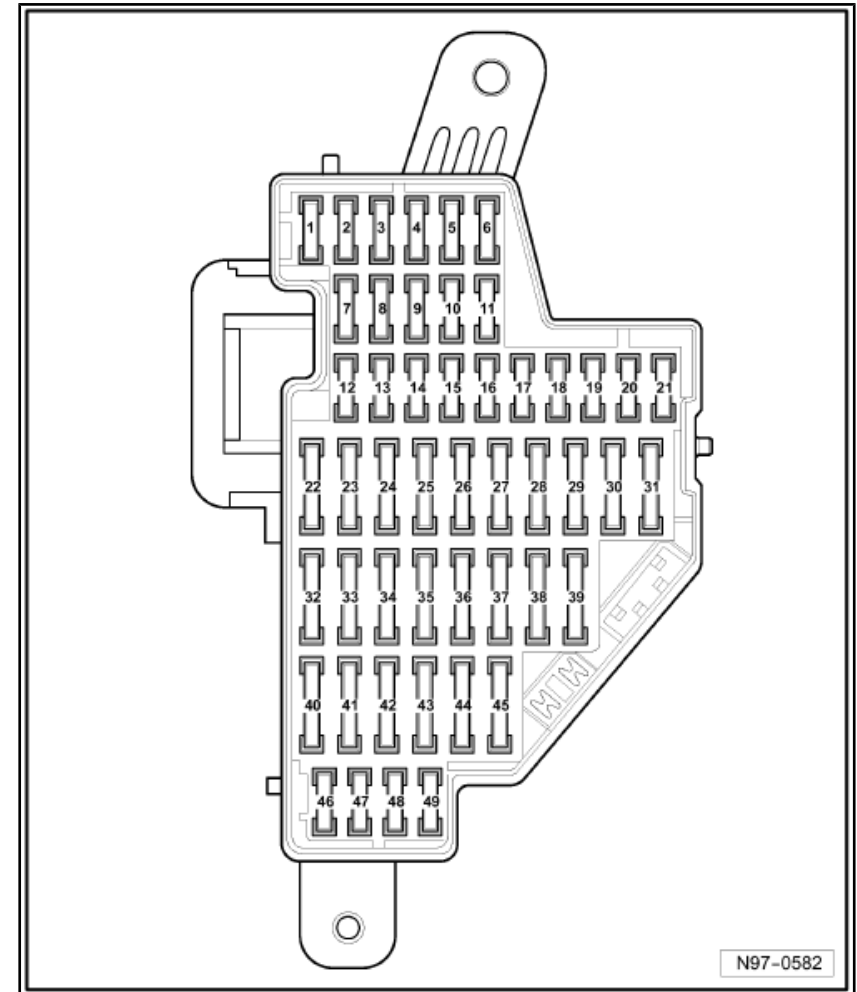

**1.13 Fuse Arrangements (on fuse panel C), instrument panel driver's door, through April 2008**

No.	Designation in Wiring Diagram	Nominal Value	Function/Component	Terminal
1	- SC1 - Fuse 1 (on fuse panel C)	10A	- T16 -Data Link Connector (DLC)	15
2	- SC2 - Fuse 2 (on fuse panel C)	5A	- E256 - ASR/ESP Button E540 - -AUTO HOLD- Button	15
3	- SC3 - Fuse 3 (on fuse panel C)	5A	- J500 - Power Steering Control Module	15
4	- SC4 - Fuse 4 (on fuse panel C)	5A	- F - Brake Light Switch	15
5	- SC5 - Fuse 5 (on fuse panel C)	10A	- E102 - Headlamp Adjuster J667 - Left Headlamp Power Output Stage (only for gas discharge headlamp) V48 - Left Headlamp Beam Adjustment Motor V49 - Right Headlamp Beam Adjustment Motor	15
6	- SC6 - Fuse 6 (on fuse panel C)	5A	- J345 - Towing Recognition Control Module	15
7	- SC7 - Fuse 7 (on fuse panel C)	5A	- J285 - Instrument Cluster Control Module J533 - Data Bus On Board Diagnostic Interface	15
8	- SC8 - Fuse 8 (on fuse panel C)	5A	- E149 - Rear Window Shade Switch (through May 2005) E284 - Garage Door Opener Control Head (through May 2005) J262 - Rear Window Shade Control Module (through May 2005) Y7 - Automatic Day/Night Interior Mirror	15
9	- SC9 - Fuse 9 (on fuse panel C)	10A	- J492-All-Wheel Drive Control Module	15
10	- SC10 - Fuse 10 (on fuse panel C)	5A	- J271 - Motronic Engine Control Module (ECM) Power Supply Relay (BSE, BSF) J623 - Engine Control Module (ECM) J670 - Motronic Engine Control Module (ECM) Power Supply Relay 2 (AXZ, BLV)	15

No.	Designation in Wiring Diagram	Nominal Value	Function/Component	Terminal
11	- SC11 - Fuse 11 (on fuse panel C)	5A	- E497 - Crash Data Recorder Button (Police) G41 - Taximeter (Taxi) G511 - Mirror Taximeter (Taxi) J754-Crash Data Recorder - Trip Odometer connection point (Police) - Special Signals System connection point (Police) F349 - Front Passenger's Warning Buzzer Pedal Switch (Driving School)	15
12	- SC12 - Fuse 12 (on fuse panel C)	10A	- J386 - Driver's Door Control Module J389 - Right Rear Door Control Module (from May 2006)	30
13	- SC13 - Fuse 13 (on fuse panel C)	10A	- E1 - Light Switch T16 -Data Link Connector (DLC)	30
14	- SC14 - Fuse 14 (on fuse panel C)	5A	- J764 -Electronic Steering Column Lock Control Module	30
15	- SC15 - Fuse 15 (on fuse panel C)	5A	- J519-Vehicle Electrical System Control Module (30g)	30
16	- SC16 - Fuse 16 (on fuse panel C)	10A	- D9 -Electronic Ignition Switch	30
17	- SC17 - Fuse 17 (on fuse panel C)	10A	- G303 - Radar Interior Monitoring Control Module 1 G397 - Rain/Light Recognition Sensor G384 - Vehicle Inclination Sensor H12 - Alarm Horn R149 - Auxiliary Engine Coolant Heating RF Receiver	30
18	- SC18 - Fuse 18 (on fuse panel C)	-	- - Not used	
19	- SC19 - Fuse 19 (on fuse panel C)	-	- - Not used	
20	- SC20 - Fuse 20 (on fuse panel C)	-	- - Not used	

No.	Designation in Wiring Diagram	Nominal Value	Function/Component	Terminal
21	- SC21 - Fuse 21 (on fuse panel C)	-	- Not used	
22	- SC22 - Fuse 22 (on fuse panel C)	10A 5A	- G70 - Mass Air Flow (MAF) Sensor (diesel engines and AXX, BPY, BWA) J49 - Fuel Pump (FP) 2 Relay (BSE, BSF)	15
23	- S23 - Fuse 23 (on fuse panel C)	10A	- N79 -Positive Crankcase Ventilation (PCV) Heating Element (where applicable)	15
24	- SC24 - Fuse 24 (on fuse panel C)	5A 20A <sup>1)</sup>	- F4 - Back-Up Light Switch F125 - Multi-Function Transmission Range (TR) Switch J217 -Transmission Control Module (TCM) J743 - Direct Shift Gearbox (DSG) Mechatronic	15
25	- SC25 - Fuse 25 (on fuse panel C)	10A	- N... - Injectors (BSE, BSF) <sup>2)</sup> E284 - Garage Door Opener Control Head (through April 2006)	15
26	- SC26 - Fuse 26 (on fuse panel C)	10A	- E149 - Rear Window Shade Switch (from May 2005) J262 - Rear Window Shade Control Module (from May 2005)	15
27	- SC27 - Fuse 27 (on fuse panel C)	5A	- J13 - Fresh Air Blower Relay (only Climatic with additional water heater) J255 - Climatronic Control Module (without additional water heater)	15
28	- SC28 - Fuse 28 (on fuse panel C)	20A	- J345 - Towing Recognition Control Module <sup>3)</sup>	30
29	- SC29 - Fuse 29 (on fuse panel C)	20A	- J345 - Towing Recognition Control Module (Left Taillamp, Brake Lamp, Right/Left Turn Signal) (through April 2006) J540 - Electro-Mechanical Parking Brake Control Module <sup>3)</sup>	30

<sup>1)</sup> Only automatic transmission

<sup>2)</sup> Only models through November 2005

<sup>3)</sup> Only models from May 2006

No.	Designation in Wiring Diagram	Nominal Value	Function/Component	Terminal
30	- SC30 - Fuse 30 (on fuse panel C)	15A	- J345 - Towing Recognition Control Module (Right Taillamp, Rear Fog Light, Backup Lamps) through April 2006 J540 - Electro-Mechanical Parking Brake Control Module <sup>1)</sup>	30
31	- SC31 - Fuse 31 (on fuse panel C)	25A 15A <sup>2)</sup>	- J345 - Towing Recognition Control Module (through April 2006) J17 - Fuel Pump (FP) Relay J49 - Fuel Pump (FP) 2 Relay J538 - Fuel Pump (FP) Control Module (BLF) <sup>2)</sup>	30
32	- SC32 - Fuse 32 (on fuse panel C)	30A	- J519-Vehicle Electrical System Control Module (heated rear window)	30
33	- SC33 - Fuse 33 (on fuse panel C)	20A	- J245-Power Sunroof Control Module	30
34	- SC34 - Fuse 34 (on fuse panel C)	15A	- G6 - Transfer Fuel Pump (FP) (BKC, BLS, BMP, BVW, BKP, BMA, BVE, BMR, BUZ)	30
35	- SC35 - Fuse 35 (on fuse panel C)	30A 25A <sup>2)</sup>	- J39 -Headlamp Washer Relay V11 - Headlamp Washer Pump	30
36	- SC36 - Fuse 36 (on fuse panel C)	20A	- J485 -Auxiliary Heater Operation Relay (not with Climatronic)	30
37	- SC37 - Fuse 37 (on fuse panel C)	25A	- J774 -Front Heated Seats Control Module	30
38	- SC38 - Fuse 38 (on fuse panel C)	15A	- J345 - Towing Recognition Control Module <sup>1)</sup> U1 - Cigarette Lighter <sup>3)</sup> U9 - Rear Cigarette Lighter <sup>3)</sup>	30
39	- SC39 - Fuse 39 (on fuse panel C)	40A	- J126 -Fresh Air Blower Control Module (Climatronic) J301 - A/C Control Module (Climatic) <sup>1)</sup>	30

<sup>1)</sup> Only models from May 2006

<sup>2)</sup> Only models from November 2006

<sup>3)</sup> Only models through April 2006

No.	Designation in Wiring Diagram	Nominal Value	Function/Component	Terminal
39	- SC39 - Fuse 39 (on fuse panel C)	40A	- J126 -Fresh Air Blower Control Module (Climatronic) J301 - A/C Control Module (Climatic) <sup>3)</sup>	30
40	- SC40 - Fuse 40 (on fuse panel C)	5A	- E1 - Light Switch	75
41	- SC41 - Fuse 41 (on fuse panel C)	40A <sup>2)</sup> 15A	- V2 - Fresh Air Blower (Climatic) <sup>2)</sup> J13 - Fresh Air Blower Relay <sup>2)</sup> U1 - Cigarette Lighter <sup>3)</sup> U9 - Rear Cigarette Lighter <sup>3)</sup>	75
42	- SC42 - Fuse 42 (on fuse panel C)	15A	- V59 - Windshield and Rear Window Washer Pump V12 -Rear Window Wiper Motor	75
43	- SC43 - Fuse 43 (on fuse panel C)	20A	- J364 -Auxiliary Heater Control Module (only Auxiliary Battery)	30
44	- SC44 - Fuse 44 (on fuse panel C)	20A	- J485 -Auxiliary Heater Operation Relay (only Auxiliary Battery)	30
45	- SC45 - Fuse 45 (on fuse panel C)	25A	- U5 - 12 V Socket (Police) U19 - 12V Socket 3 (Taxi) <sup>1)</sup>	30
46	- SC46 - Fuse 46 (on fuse panel C)	5A	- E72 - Radio Switch (Police) E489 - Engine -RUN- Button (Police) J754 - Crash Data Recorder (Taxi, Police) <sup>1)</sup> - Trip Odometer connection point	30

<sup>1)</sup> Only models with taxi equipment from May 2005

<sup>2)</sup> Only models through April 2006

<sup>3)</sup> Only models from May 2006

No.	Designation in Wiring Diagram	Nominal Value	Function/Component	Terminal
47	- SC47 - Fuse 47 (on fuse panel C)	15A	- G41 - Taximeter (Taxi) <sup>1)</sup> - G511 - Mirror Taximeter (Taxi) <sup>1)</sup> - K222 - Taxi Roof Sign Indicator Lamp (Taxi) <sup>1)</sup> - K224 - Interior Illumination Indicator Lamp (Taxi) <sup>1)</sup> - L128 - Silent Alarm Lamp (Taxi) <sup>1)</sup> - L180 - Button Illumination (alarm activated) (Taxi) <sup>1)</sup> - W18 - Left Luggage Compartment Light (Police) - Two-way Radio connection point, in luggage compartment (Police/Criminal Investigation) - Glove Compartment connection point (Taxi) <sup>1)</sup> - Luggage Compartment connection point (Taxi) <sup>1)</sup>	30
48	- SC48 - Fuse 48 (on fuse panel C)	20A	- - Charging Preparation Connection Point (Police)	75
49	- SC49 - Fuse 49 (on fuse panel C)		- - Not used	

<sup>1)</sup> Only models with taxi equipment from May 2005

1.14 Fuses (SC) (on fuse panel C), instrument panel driver's door, from May 2008

1.14.1 Fuse Colours

- 30 A - green
- 25 A - white
- 20 A - yellow
- 15 A - blue
- 10 A - red
- 7,5 A - brown
- 5 A - beige
- 3 A - purple

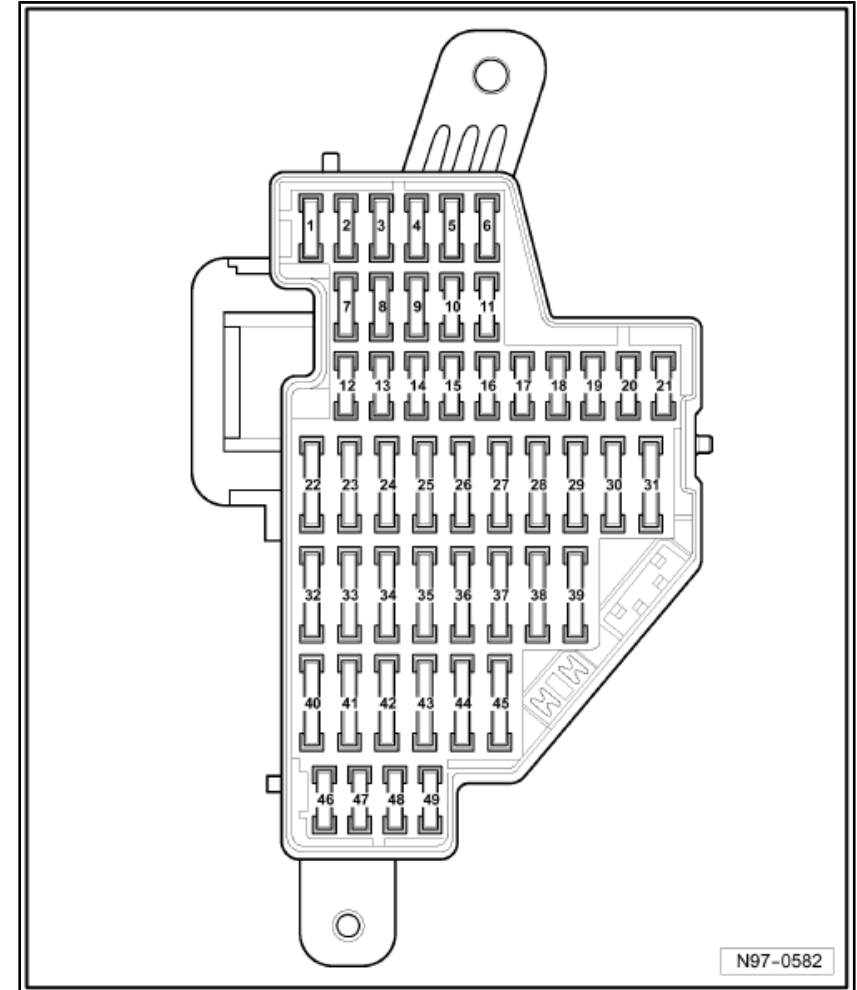

N97-0582



**1.15 Fuse Arrangements (on fuse panel C), instrument panel driver's door, from May 2008**

No.	Designation in Wiring Diagram	Nominal Value	Function/Component	Terminal
1	- SC1 - Fuse 1 (on fuse panel C)	10A	- E149 - Rear Window Shade Switch V91 - Rear Window Shade Motor	15
2	- SC2 - Fuse 2 (on fuse panel C)	5A	- E256 - ASR/ESP Button E540 - -AUTO HOLD- Button J104 - ABS Control Module J540 - Electro-Mechanical Parking Brake Control Module	15
3	- SC3 - Fuse 3 (on fuse panel C)	5A	- E1 - Light Switch F - Brake Light Switch G266 - Oil Level Thermal Sensor J500 - Power Steering Control Module	15
4	- SC4 - Fuse 4 (on fuse panel C)	5A	- J250 - Electronic Damping Control Module J345 - Towing Recognition Control Module J745 - Headlamp Range/Cornering Lamp Control Module T16 -Data Link Connector (DLC)	15
5	- SC5 - Fuse 5 (on fuse panel C)	10A	- E20 - Instrument Panel Illumination Dimmer Switch E102 - Headlamp Adjuster J667 - Left Headlamp Power Output Stage (only for gas discharge headlamp) V48 - Left Headlamp Beam Adjustment Motor	15
6	- SC6 - Fuse 6 (on fuse panel C)	10A	- J492-All-Wheel Drive Control Module	15
7	- SC7 - Fuse 7 (on fuse panel C)	5A	- J285 - Instrument Cluster Control Module J533 - Data Bus On Board Diagnostic Interface	15

No.	Designation in Wiring Diagram	Nominal Value	Function/Component	Terminal
8	- SC8 - Fuse 8 (on fuse panel C)	10A	- J668 - Right Headlamp Power Output Stage V49 - Right Headlamp Beam Adjustment Motor	15
9	- SC9 - Fuse 9 (on fuse panel C)	10A	- J234 - Airbag Control Module J706 - Seat Occupied Recognition Control Module K145 - Front Passenger's Airbag Disabled Indicator Lamp	15
10	- SC10 - Fuse 10 (on fuse panel C)	10A	- F189-Tiptronic Switch G70 - Mass Air Flow (MAF) Sensor J538 - Fuel Pump (FP) Control Module J623 - Engine Control Module (ECM) J670 - Motronic Engine Control Module (ECM) Power Supply Relay 2 (BLV, BWS) J271 - Motronic Engine Control Module (ECM) Power Supply Relay (BSE, BSF)	15
11	- SC11 - Fuse 11 (on fuse panel C)	5A	- - Special Purpose Vehicle	15
12	- SC12 - Fuse 12 (on fuse panel C)	10A	- J386 - Driver's Door Control Module J387 - Front Passenger's Door Control Module	30
13	- SC13 - Fuse 13 (on fuse panel C)	10A	- E1 - Light Switch F189-Tiptronic Switch T16 -Data Link Connector (DLC)	30
14	- SC14 - Fuse 14 (on fuse panel C)	10A	- J641 - Alarm Horn Relay (only applicable to US/CDN) H12 - Alarm Horn	30
15	- SC15 - Fuse 15 (on fuse panel C)	5A	- G303 - Radar Interior Monitoring Control Module 1 J519-Vehicle Electrical System Control Module (30g)	30
16	- SC16 - Fuse 16 (on fuse panel C)	10A	- D9 -Electronic Ignition Switch J764 -Electronic Steering Column Lock Control Module	30
17	- SC17 - Fuse 17 (on fuse panel C)	5A	- E538 - Electro-Mechanical Parking Brake Button J104 - ABS Control Module	30

No.	Designation in Wiring Diagram	Nominal Value	Function/Component	Terminal
18	- SC18 - Fuse 18 (on fuse panel C)	10A	- N79 -Positive Crankcase Ventilation (PCV) Heating Element (where applicable)	15
19	- SC19 - Fuse 19 (on fuse panel C)	7,5A	- J428-Distance Regulation Control Module J446 - Parking Aid Control Module J759 - Directional Stabilization Assistance Control Module J791 - Parallel Parking Assistance Control Module	15
20	- SC20 - Fuse 20 (on fuse panel C)	5A	- E284 - Garage Door Opener Control Head (not for right-hand drive)	15
21	- SC21 - Fuse 21 (on fuse panel C)	10A	- E128 - Left Rear Heated Seat Regulating Switch E129 - Right Rear Heated Seat Regulating Switch G65 - High Pressure Sensor G238 - Air Quality Sensor J13 - Fresh Air Blower Relay Y7 - Automatic Day/Night Interior Mirror Z20 - Left Washer Nozzle Heater Z21 - Right Washer Nozzle Heater J301 - A/C Control Module J813 - Power Supply Relay (RSE)	15
22	- SC22 - Fuse 22 (on fuse panel C)	20A	- J540 - Electro-Mechanical Parking Brake Control Module	30
23	- S23 - Fuse 23 (on fuse panel C)	15A	- J345 - Towing Recognition Control Module	30
24	- SC24 - Fuse 24 (on fuse panel C)	20A	- J540 - Electro-Mechanical Parking Brake Control Module	30
25	- SC25 - Fuse 25 (on fuse panel C)	20A	- J345 - Towing Recognition Control Module	30

No.	Designation in Wiring Diagram	Nominal Value	Function/Component	Terminal
26	- SC26 - Fuse 26 (on fuse panel C)	15A	- J250 - Electronic Damping Control Module	30
27	- SC27 - Fuse 27 (on fuse panel C)	15A <sup>1)</sup> 20A <sup>2)</sup>	- J17 - Fuel Pump (FP) Relay <sup>2)</sup> J49 - Fuel Pump (FP) 2 Relay <sup>2)</sup> J538 - Fuel Pump (FP) Control Module <sup>1)</sup> J832 - Auxiliary Fuel Pump Relay <sup>2)</sup>	30 <sup>1)</sup> 15 <sup>2)</sup>
28	- SC28 - Fuse 28 (on fuse panel C)	10A	- J388 - Left Rear Door Control Module J389 - Right Rear Door Control Module J393 - Comfort System Central Control Module	30
29	- SC29 - Fuse 29 (on fuse panel C)	25A	- J786 -Heated Rear Seats Control Module	30
30	- SC30 - Fuse 30 (on fuse panel C)	20A	- J245-Power Sunroof Control Module	30
31	- SC31 - Fuse 31 (on fuse panel C)	30A	- U13-Converter with Socket, 12 V-230 V U27 - Converter with Socket, 12V - 115V (only applicable to US/CDN)	30
32	- SC32 - Fuse 32 (on fuse panel C)	30A	- J519-Vehicle Electrical System Control Module (heated rear window)	30
33	- SC33 - Fuse 33 (on fuse panel C)	30A	- J39 -Headlamp Washer Relay V11 - Headlamp Washer Pump	30
34	- SC34 - Fuse 34 (on fuse panel C)	25A	- J774 -Front Heated Seats Control Module	30

<sup>1)</sup> Only gasoline engines

<sup>2)</sup> Only diesel engines

No.	Designation in Wiring Diagram	Nominal Value	Function/Component	Terminal
35	- SC35 - Fuse 35 (on fuse panel C)	30A	- J388 - Left Rear Door Control Module J389 - Right Rear Door Control Module	30
36	- SC36 - Fuse 36 (on fuse panel C)	15A	- E176 - Driver's Seat Lumbar Support Adjustment Switch E421 - Inclination Adjustment Button E425 - Backrest Adjustment Button	30
37	- SC37 - Fuse 37 (on fuse panel C)	10A	- G197 - Magnetic Field Sensor for Compass G397 - Rain/Light Recognition Sensor J255 - Climatronic Control Module J301 - A/C Control Module J772 - Rear View Camera System Control Module R149 - Auxiliary Engine Coolant Heating RF Receiver J813 - Power Supply Relay (RSE)	30
38	- SC38 - Fuse 38 (on fuse panel C)	40A	- J13 - Fresh Air Blower Relay J126 - Fresh Air Blower Control Module (Climatronic) J301 - A/C Control Module (Climatic)	75
39	- SC39 - Fuse 39 (on fuse panel C)	15A <sup>1)</sup> 5A	- F4 - Back-Up Light Switch F125 - Multi-Function Transmission Range (TR) Switch <sup>1)</sup> J217 - Transmission Control Module (TCM) <sup>1)</sup> J743 - Direct Shift Gearbox (DSG) Mechatronic	15
40	- SC40 - Fuse 40 (on fuse panel C)	15A	- J713 - Second Battery Charge Relay V5 - Windshield Washer Pump V12 - Rear Window Wiper Motor	75
41	- SC41 - Fuse 41 (on fuse panel C)	20A	- U1 - Cigarette Lighter U9 - Rear Cigarette Lighter	75

<sup>1)</sup> Only models with 6-speed automatic transmission

No.	Designation in Wiring Diagram	Nominal Value	Function/Component	Terminal
42	- SC42 - Fuse 42 (on fuse panel C)	15A	- U5 - 12 V Socket	75
43	- SC43 - Fuse 43 (on fuse panel C)	20A	- J364 -Auxiliary Heater Control Module (only Auxiliary Battery)	30
44	- SC44 - Fuse 44 (on fuse panel C)	30A	- J386 - Driver's Door Control Module J387 - Front Passenger's Door Control Module	30
45	- SC45 - Fuse 45 (on fuse panel C)	20A	- J485 -Auxiliary Heater Operation Relay (only Auxiliary Battery)	30
46	- SC46 - Fuse 46 (on fuse panel C)		- - Not used	
47	- SC47 - Fuse 47 (on fuse panel C)		- - Not used	
48	- SC48 - Fuse 48 (on fuse panel C)		- - Not used	
49	- SC49 - Fuse 49 (on fuse panel C)		- - Not used	

**1.16 Fuses (SD) (on fuse panel D), instrument panel front passenger's door, through April 2008**

**1.16.1 Fuse Colours**

- 30 A - green
- 25 A - white
- 20 A - yellow
- 15 A - blue
- 10 A - red
- 7,5 A - brown
- 5 A - beige
- 3 A - purple

**i Note:**

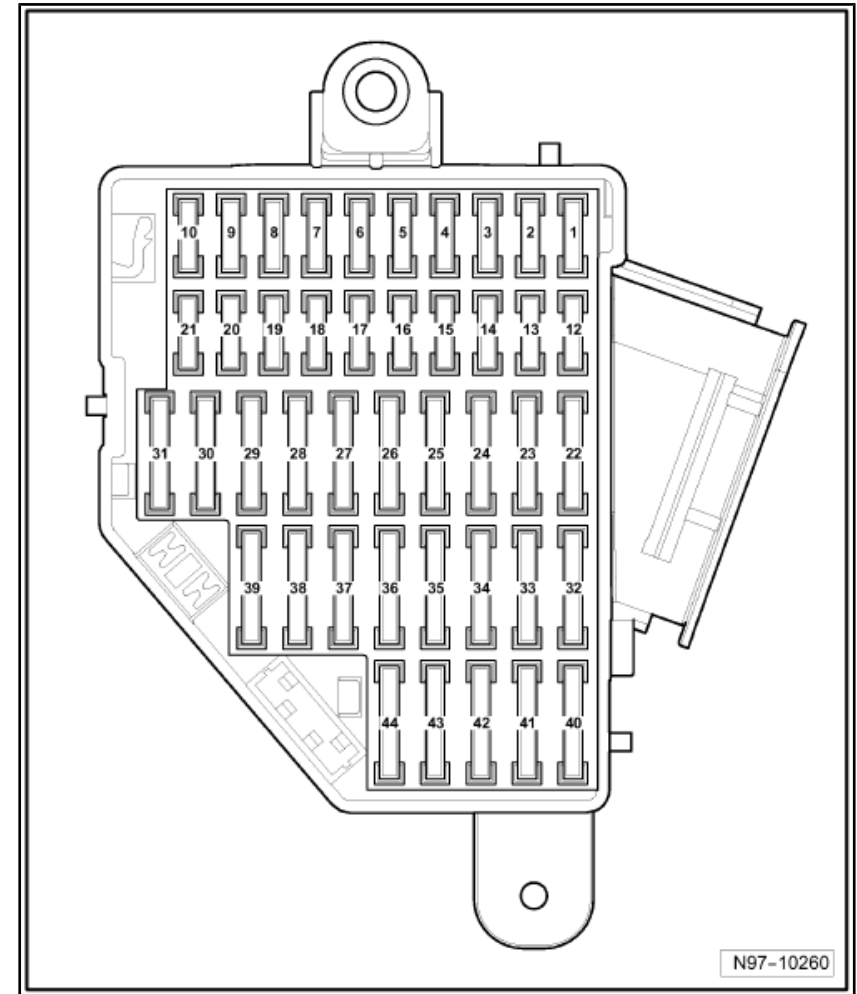

**1.17 Fuse Arrangements (on fuse panel D), instrument panel front passenger's door, through April 2008**

No.	Designation in Wiring Diagram	Nominal Value	Function/Component	Terminal
1	- SD1 - Fuse 1 (on fuse panel D)	5A	- G197 - Magnetic Field Sensor for Compass <sup>1)</sup>	15
2	- SD2 - Fuse 2 (on fuse panel D)	5A	- J540-Electric Park/Handbrake Control Module J104 - ABS Control Module	15
3	- SD3 - Fuse 3 (on fuse panel D)	5A	- G197 - Magnetic Field Sensor for Compass <sup>2)</sup> J446 - Parking Aid Control Module	15
4	- SD4 - Fuse 4 (on fuse panel D)	5A	- J428-Distance Regulation Control Module	15
5	- SD5 - Fuse 5 (on fuse panel D)	10A	- J668-Right Headlamp Power Output Stage (only for gas discharge headlamp)	15
6	- SD6 - Fuse 6 (on fuse panel D)	5A	- F189-Tiptronic Switch	15
7	- SD7 - Fuse 7 (on fuse panel D)	5A	- J745-Headlamp Range/Cornering Lamp Control Module (only for gas discharge headlamp)	15
8	- SD8 - Fuse 8 (on fuse panel D)	5A	- G65 - High Pressure Sensor G266 - Oil Level Thermal Sensor	15
9	- SD9 - Fuse 9 (on fuse panel D)	10A	- K145 - Front Passenger's Airbag Disabled Indicator Lamp J234 - Airbag Control Module J706 - Seat Occupied Recognition Control Module	15
10	- SD10 - Fuse 10 (on fuse panel D)	5A	- J538-Fuel Pump (FP) Control Module (BLF, BLR, BLY, AXX, BPY, BLX, BVX, BVY, BVZ, BWA)	15
11	- SD11 - Fuse 11 (on fuse panel D)		- - Not used	

<sup>1)</sup> Only models from May 2005

<sup>2)</sup> Only models through April 2006



No.	Designation in Wiring Diagram	Nominal Value	Function/Component	Terminal
12	- SD12 - Fuse 12 (on fuse panel D)	10A	- J387 - Front Passenger's Door Control Module J389 - Right Rear Door Control Module <sup>3)</sup>	30
13	- SD13 - Fuse 13 (on fuse panel D)	10A	- J446 - Parking Aid Control Module <sup>2)</sup>	30
14	- SD14 - Fuse 14 (on fuse panel D)	10A 5A	- J714-Closing Assist Relay J772 - Rear View Camera System Control Module <sup>4)</sup>	30
15	- SD15 - Fuse 15 (on fuse panel D)	5A	- J255 - Climatronic Control Module J301 - A/C Control Module	30
16	- SD16 - Fuse 16 (on fuse panel D)	5A	- F189-Tiptronic Switch	30
17	- SD17 - Fuse 17 (on fuse panel D)	5A	- K213 - Electro-mechanical Parking Brake Indicator Lamp J104 - ABS Control Module	30
18	- SD18 - Fuse 18 (on fuse panel D)		- - Not used	
19	- SD19 - Fuse 19 (on fuse panel D)		- - Not used	
20	- SD20 - Fuse 20 (on fuse panel D)		- - Not used	
21	- SD21 - Fuse 21 (on fuse panel D)		- - Not used	
22	- SD22 - Fuse 22 (on fuse panel D)	30A	- U13-Converter with Socket, 12 V-230 V U27 - Converter with Socket, 12V, 115V <sup>1)</sup>	30

<sup>1)</sup> Only applicable to US/CDN

<sup>2)</sup> Only models through April 2006

<sup>3)</sup> Only models from May 2006

<sup>4)</sup> Only models from November 2007

No.	Designation in Wiring Diagram	Nominal Value	Function/Component	Terminal
23	- SD23 - Fuse 23 (on fuse panel D)	30A	- J388 - Left Rear Door Control Module J389 - Right Rear Door Control Module	30
24	- SD24 - Fuse 24 (on fuse panel D)	30A	- J762-Left Rear Door Closing Assistance Control Module (wagon)	30
25	- SD25 - Fuse 25 (on fuse panel D)	30A	- J763-Right Rear Door Closing Assistance Control Module (wagon)	30
26	- SD26 - Fuse 26 (on fuse panel D)		- - Not used	
27	- SD27 - Fuse 27 (on fuse panel D)	25A	- J786 -Heated Rear Seats Control Module	30
28	- SD28 - Fuse 28 (on fuse panel D)	15A	- J538 - Fuel Pump (FP) Control Module (AXZ, BLV) <sup>1)</sup>	30
29	- SD29 - Fuse 29 (on fuse panel D)	30A	- J386 - Driver's Door Control Module J387 - Front Passenger's Door Control Module	30
30	- SD30 - Fuse 30 (on fuse panel D)	20A	- J540 - Electric Park/Handbrake Control Module <sup>1)</sup> J393 - Comfort System Central Control Module <sup>2)</sup>	30
31	- SD31 - Fuse 31 (on fuse panel D)	20A 15A	- J540 - Electric Park/Handbrake Control Module <sup>1)</sup> J538 - Fuel Pump (FP) Control Module <sup>2)</sup>	30
32	- SD32 - Fuse 32 (on fuse panel D)		- - Not used	

<sup>1)</sup> Only models through April 2006

<sup>2)</sup> Only models from May 2006 and through October 2006

No.	Designation in Wiring Diagram	Nominal Value	Function/Component	Terminal
33	- SD33 - Fuse 33 (on fuse panel D)	20A	- U5 - 12 V Socket <sup>2)</sup> U18 - 12V Socket 2 <sup>2)</sup>	30
34	- SD34 - Fuse 34 (on fuse panel D)	15A	- J538 - Fuel Pump (FP) Control Module (AXX, BPY, BLF, BLR, BLY, BLX, BVX, BVY, BVZ, BWA) <sup>2)</sup>	30
35	- SD35 - Fuse 35 (on fuse panel D)	20A	- U1 - Cigarette Lighter <sup>2)</sup> U9 - Rear Cigarette Lighter <sup>2)</sup>	30
36	- SD36 - Fuse 36 (on fuse panel D)		- - Not used	
37	- SD37 - Fuse 37 (on fuse panel D)		- - Not used	
38	- SD38 - Fuse 38 (on fuse panel D)		- U5 - 12 V Socket <sup>3)</sup>	75
39	- SD39 - Fuse 39 (on fuse panel D)	10A	- E94 - Driver's Heated Seat Adjuster <sup>2)</sup> E95 - Front Passenger's Heated Seat Adjuster <sup>2)</sup> E128 - Left Rear Heated Seat Regulating Switch <sup>2)</sup> E129 - Right Rear Heated Seat Regulating Switch <sup>2)</sup> J255 - Climatronic Control Module J301 - A/C Control Module J713-Second Battery Charge Relay Z20 - Left Washer Nozzle Heater Z21 - Right Washer Nozzle Heater	75
40	- SD40 - Fuse 40 (on fuse panel D)	5A	- J754 - Crash Data Recorder (Taxi) <sup>1)</sup>	

<sup>1)</sup> Only models with taxi equipment through May 2005

<sup>2)</sup> Only models through April 2006

<sup>3)</sup> Only models from May 2006

No.	Designation in Wiring Diagram	Nominal Value	Function/Component	Terminal
41	- SD41 - Fuse 41 (on fuse panel D)	15A	- G41 - Taximeter (Taxi) <sup>1)</sup> - G511 - Mirror Taximeter (Taxi) <sup>1)</sup> - K222 - Taxi Roof Sign Indicator Lamp (Taxi) <sup>1)</sup> - K224 - Interior Illumination Indicator Lamp (Taxi) <sup>1)</sup> - L180 - Button Illumination (alarm activated) (Taxi) <sup>1)</sup> - Glove Compartment connection point (Taxi) <sup>1)</sup> - Luggage Compartment connection point (Taxi) <sup>1)</sup>	30
42	- SD42 - Fuse 42 (on fuse panel D)	20A	- Glove Compartment connection point (Taxi) <sup>1)</sup>	30
43	- SD43 - Fuse 43 (on fuse panel D)	5A	- J601 - Remote Taxi Alarm Control Module (Taxi) <sup>1)</sup> - Special Signals System connection point (Police) - Glove Compartment connection point (Taxi) <sup>2)</sup> - Luggage Compartment connection point (Taxi) <sup>2)</sup>	30
44	- SD44 - Fuse 44 (on fuse panel D)	10A	- J601 - Remote Taxi Alarm Control Module (Taxi) <sup>2)</sup> - U19 - 12V Socket 3 (Taxi) <sup>1)</sup> - Special Signals System connection point (Police)	30

<sup>1)</sup> Only models with taxi equipment through May 2005

<sup>2)</sup> Only models with taxi equipment from May 2005

1.18 Fuses (SD) (on fuse panel D), instrument panel front passenger's door, from May 2008

1.18.1 Fuse Colours

30 A - green

25 A - white

20 A - yellow

15 A - blue

10 A - red

7,5 A - brown

5 A - beige

3 A - purple

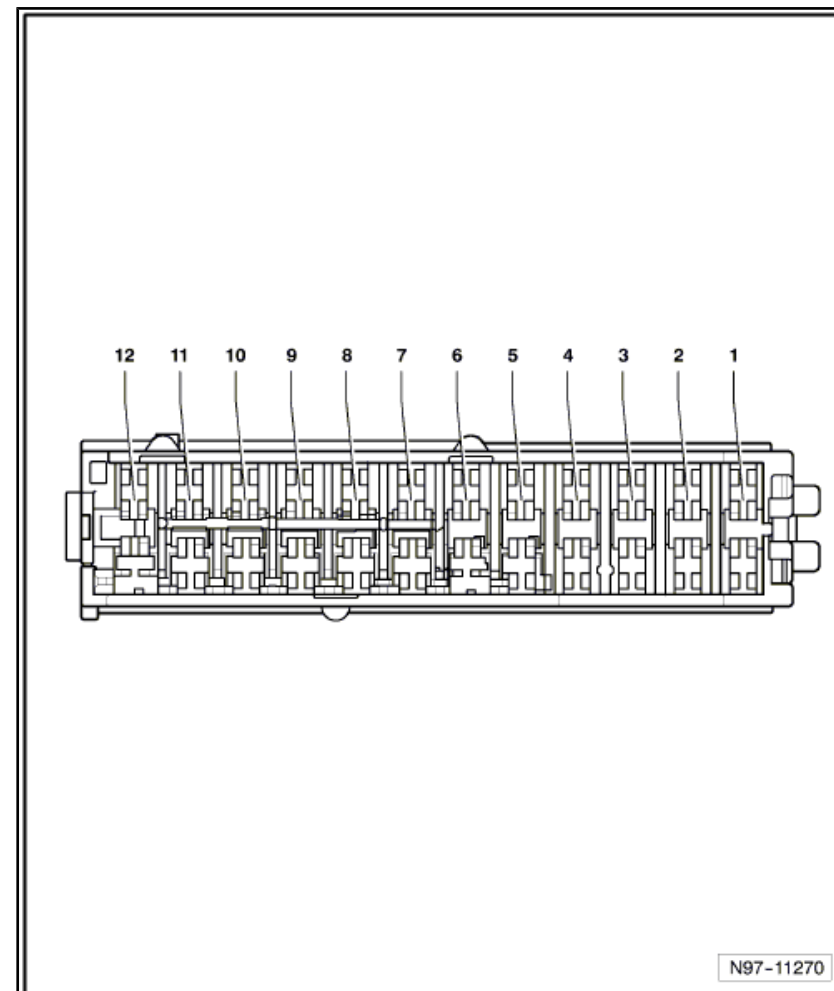

**1.19 Fuse Arrangements (on fuse panel D), instrument panel front passenger's door, from May 2008**

No.	Designation in Wiring Diagram	Nominal Value	Function/Component	Terminal
1	- SD1 - Fuse 1 (on fuse panel D)	30A	- J756 - Rear Lid Control Module 2 (only wagon)	30
2	- SD2 - Fuse 2 (on fuse panel D)	30A	- J605 - Rear Lid Control Module (only wagon)	30
3	- SD3 - Fuse 3 (on fuse panel D)		- - Not used	
4	- SD4 - Fuse 4 (on fuse panel D)		- - Not used	75
5	- SD5 - Fuse 5 (on fuse panel D)		- - Reserved for Special Purpose Vehicles	30
6	- SD6 - Fuse 6 (on fuse panel D)		- - Reserved for Special Purpose Vehicles	30
7	- SD7 - Fuse 7 (on fuse panel D)		- - Reserved for Special Purpose Vehicles	30
8	- SD8 - Fuse 8 (on fuse panel D)		- - Reserved for Special Purpose Vehicles	30
9	- SD9 - Fuse 9 (on fuse panel D)		- - Reserved for Special Purpose Vehicles	30
10	- SD10 - Fuse 10 (on fuse panel D)		- - Not used	
11	- SD11 - Fuse 11 (on fuse panel D)		- - Not used	
12	- SD12 - Fuse 11 (on fuse panel D)		- - Not used	

1.20 Safety Cutout, under instrument panel, left

A - Front Passenger's Power Seat Adjustment Circuit Breaker 1 (30A) -S46-

B - Driver's Power Seat Adjustment Circuit Breaker 1 (15A) -S44-

C - Not used

D - Not used

 Note:

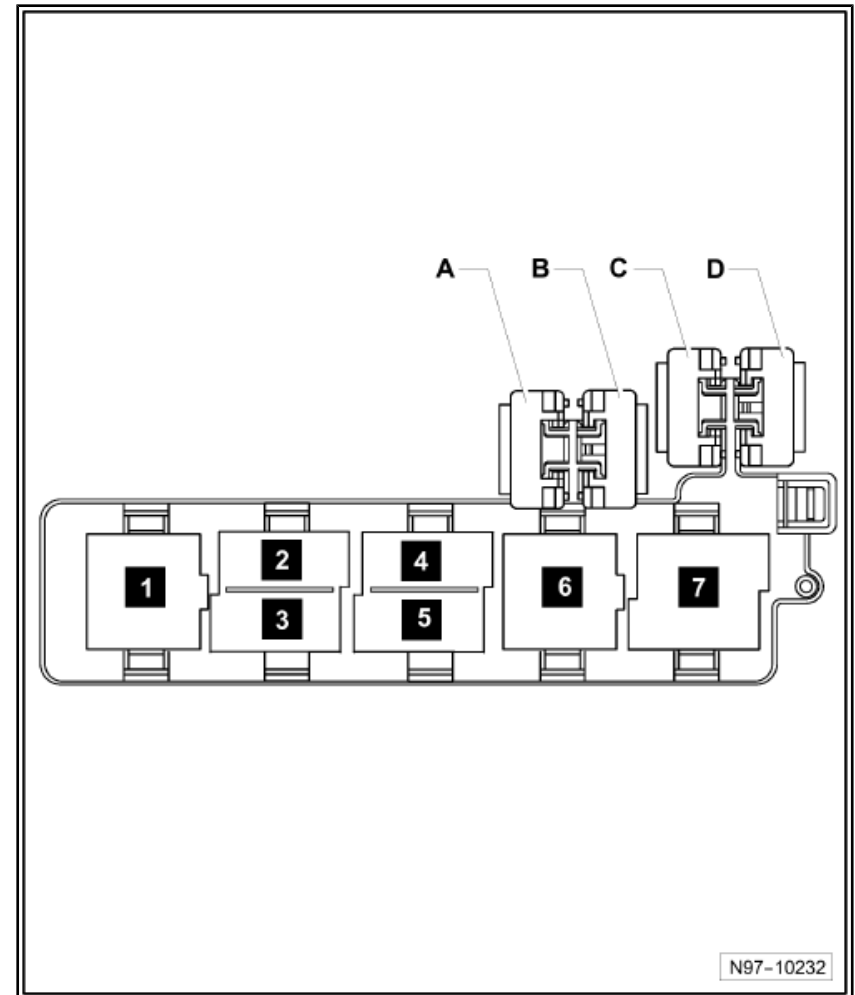

N97-10232

1.21 Fuses (SF) on fuse panel F, in luggage compartment, left rear (AXZ, BLV)

1.21.1 Torque Settings

⇒ Electrical System, Repair Group 97, Removing and Installing Fuse Panel

**Fuse Colours**

30 A - green

25 A - white

20 A - yellow

15 A - blue

10 A - red

7,5 A - brown

5 A - beige

3 A - purple

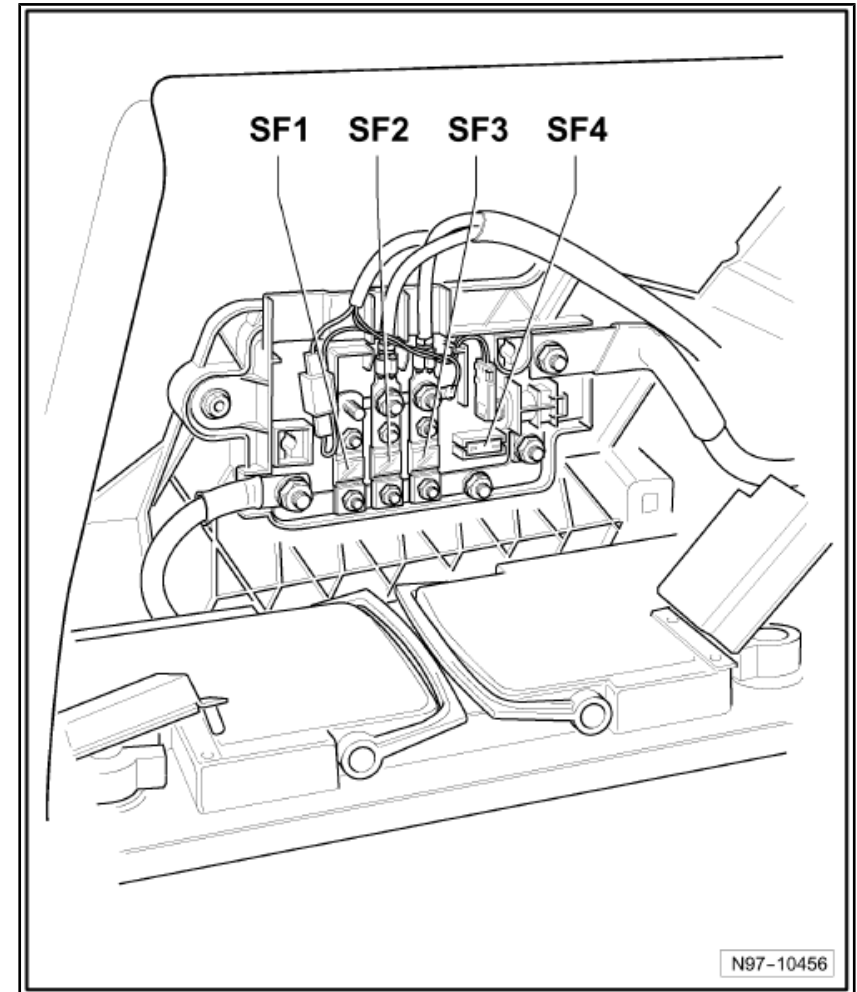

N97-10456



**1.22 Fuse Arrangements on fuse panel F, in luggage compartment, left rear (AXZ, BLV)**

No.	Designation in Wiring Diagram	Nominal Value	Function/Component	Terminal
1	- SF1 - Fuse 1 (on fuse panel F)	30A	- Left Fuse Carrier (SC12 - SC17, SC29 - SC31) <sup>1)</sup> - Right Fuse Carrier (SD12 - SD17, SD28, SD29 - SD31) <sup>1)</sup>	30
2	- SF2 - Fuse 2 (on fuse panel F)	80A	-Fuses in electronics box (SB16 - SB26, SB49, SB50)	30
3	- SF3 - Fuse 3 (on fuse panel F)	125A	-Power Supply electronics box	30
4	- SF4 - Fuse 4 (on fuse panel F)	5A	- J519 - Vehicle Electrical System Control Module	30

<sup>1)</sup> Only models from May 2006

**1.23 Fuse 2 - terminal 30 -S205-**

**1.23.1 Component Location:**

In luggage compartment behind left side panel trim -Arrow-

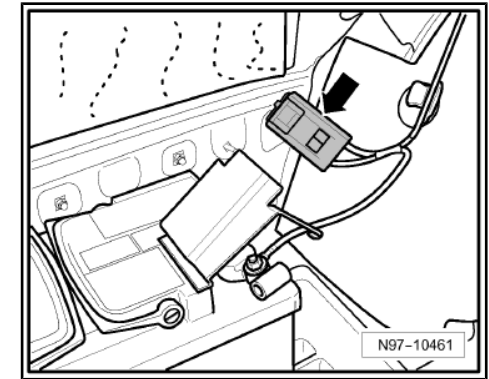

**1.23.2 Fuse rating:**

- ◆ 70 A - Sedan
- ◆ 60 A - Wagon