

Trim Panels, Front Doors—Crown Victoria, Grand Marquis

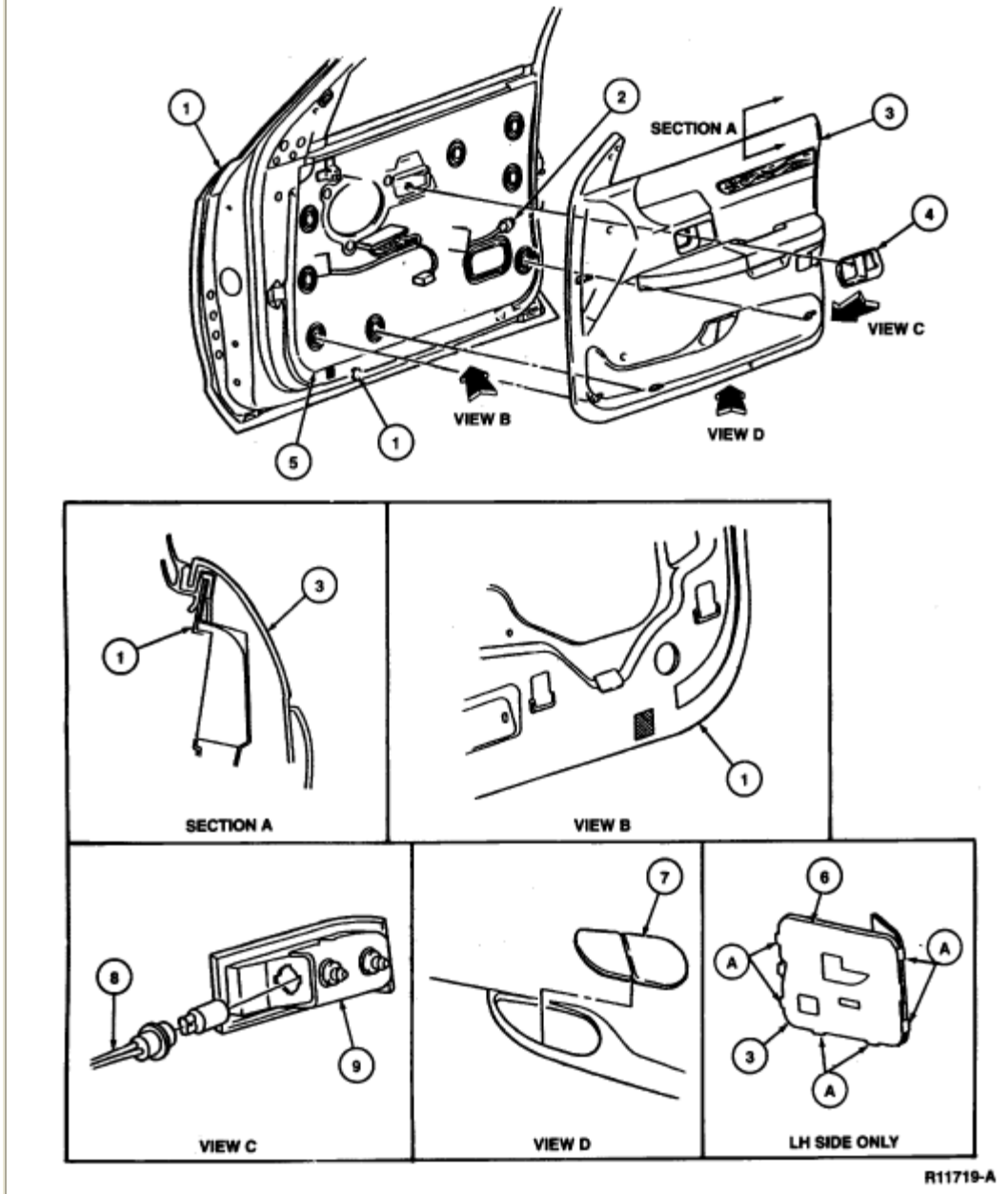

## Removal

1. Remove outside rear view mirror remote control unit.
2. Remove window regulator control switch housing by gently prying up, starting at the front.

3. Disconnect all connectors from window regulator control switch housing.
4. Remove inside door handle cup by gently prying at screwdriver slot with a screwdriver.
5. Remove screw directly beneath inside door handle.
6. Remove lower self-tapping screw retaining front door trim panel to door inner panel.
7. Remove rectangular plug in trim panel upper front extension and depress finger bracket with screwdriver.
8. Lift front door trim panel upward and snap out trim panel.
9. Disconnect wire harnesses from door panel as required and remove front door trim panel.

## **Installation**

1. Connect wire harnesses to front door trim panel as required.
2. Install front door trim panel by pushing in and down until it snaps into place.
3. Install all self-tapping screws retaining front door trim panel to door inner panel.
4. Install inside door handle cup.
5. Install window regulator control switch housing.
6. Install outside rearview mirror remote control unit.