

② Hex wrench

- ▶ Insert long side of hex wrench ② into opening.
 - ▶ Using hex wrench ②, press release catch down in direction of arrow.
The roll bar extends with a loud sound.
 - ▶ Repeat this step for the second roll bar.
- Have the systems checked at an authorized Mercedes-Benz Center as soon as possible.

Lowering roll bars manually

With the soft top open, you can lower the roll bars manually after they have been released.

- ① With the roll bars released, the soft top cannot be operated using the soft top switch and the rear head restraints cannot

be lowered using the rear head restraint lowering switch.

⚠ Warning!

Never lower the roll bars manually unless the soft top is open. Otherwise, the roll bars function could be impaired, no longer reducing your risk of injury in an optimal manner.

Contact an authorized Mercedes-Benz Center to have the roll bar lowered when the soft top is closed.

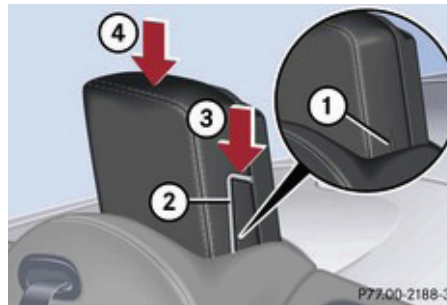

- ① Orientation seam
- ② Hex wrench
- ③ Press wrench down
- ④ Press head restraint down

Opening/closing in an emergency

- ▶ Take the hex wrench from the Mercedes-Benz literature pouch.
- ▶ Align hex wrench so that its long side is parallel to orientation seam ① and insert hex wrench ② into gap on left side of respective head restraint.
- ▶ Press hex wrench down firmly in direction of arrow ③ and hold.
- ▶ Press head restraint down in direction of arrow ④.
- ▶ Pull hex wrench ② out and take weight off head restraint.
- ▶ Repeat this procedure on roll bar for second head restraint.

Soft top emergency operation (cabriolet)

If the soft top cannot be automatically closed, check the following:

- Is the luggage cover engaged in place (▷ page 197)?
- Have the roll bars been released? If so, lower the roll bars manually (▷ page 323).
- Is the trunk lid closed (▷ page 79)?
- Is there sufficient on-board voltage?
Start the engine if necessary.